



## JANA'S BAKERY

13025 N CAVE CREEK RD  
PHOENIX, AZ 85022

### For Sale

YEAR BUILT	1975
BUILDING SIZE	±3,525 SF
SALE PRICE	\$799,000
PARKING	2.84:1,000 SF
ZONING	C-2, City of Phoenix

- For use as a bakery, commercial kitchen, or catering
- Equipment and business included in price
- Currently a bakery and deli/grocery store
- List of inventory and equipment available upon request
- Includes area for bakery/deli cases
- Living area on second floor
- Ample parking in front and rear of property



## DO NOT DISTURB TENANT

Partnership. Performance.

[avisonyoung.com](http://avisonyoung.com)

**Linda Robbins, CCIM**

Senior Associate

602.390.7262

[linda.robbs@avisonyoung.com](mailto:linda.robbs@avisonyoung.com)

**Gail Brown, JD**

Associate

602.316.2519

[gail.brown@avisonyoung.com](mailto:gail.brown@avisonyoung.com)

## PROPERTY PHOTOS



## PROPERTY PHOTOS



## LOCATION MAP

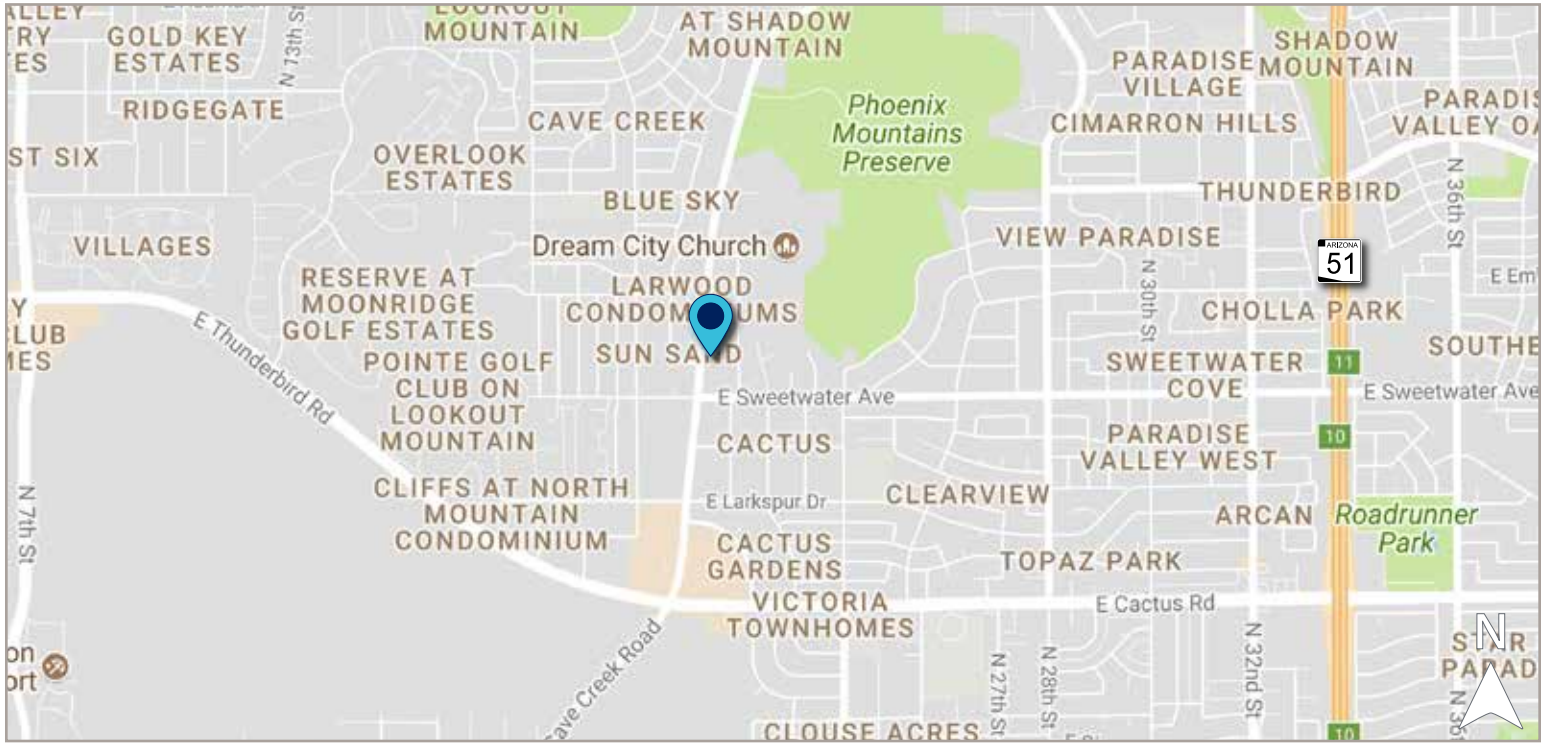

## AERIAL

