

2670

EAST COLORADO BOULEVARD
PASADENA, CA 91107

FOR LEASE RETAIL/OFFICE OPPORTUNITY



Charles Dunn

CHARLES DUNN COMPANY, INC.

800 West Sixth Street, Suite 800 | Los Angeles, CA 90017 | Lic. #01201641 | charlesdunn.com

CONTACT:

TRACY TAFT

Director

Lic. #00903455

Direct | 213.270.6207

ttaft@charlesdunn.com

CHRIS RUNYEN, CCIM

Senior Managing Director

Lic. #01208531

Direct | 213.481.1800

crunyen@charlesdunn.com

PROPERTY OVERVIEW

East Pasadena Retail/Office Space for Lease

5.0/1000 Free Parking

PROPERTY INFORMATION

ADDRESS	2670 East Colorado Boulevard, Pasadena, CA 91107
AVAILABLE SPACE	±7,500 SF
RATE SF	\$3.00/SF/NNN
TERM	5-10 Years
PARKING	Free - 5/1000 (40 spaces)
NNN Expenses	\$.20 month/SF

PROPERTY FEATURES

- Plentiful free parking
- Recently refurbished interiors
- Extensive buildout with upgraded electrical and HVAC systems
- Built-in cabinetry throughout
- Convenient access to the 210 freeway
- Close proximity to Hastings Ranch and retail amenities
- Traffic count 18,704 CPD**
- Former Chase Bank branch

**Source: Costar

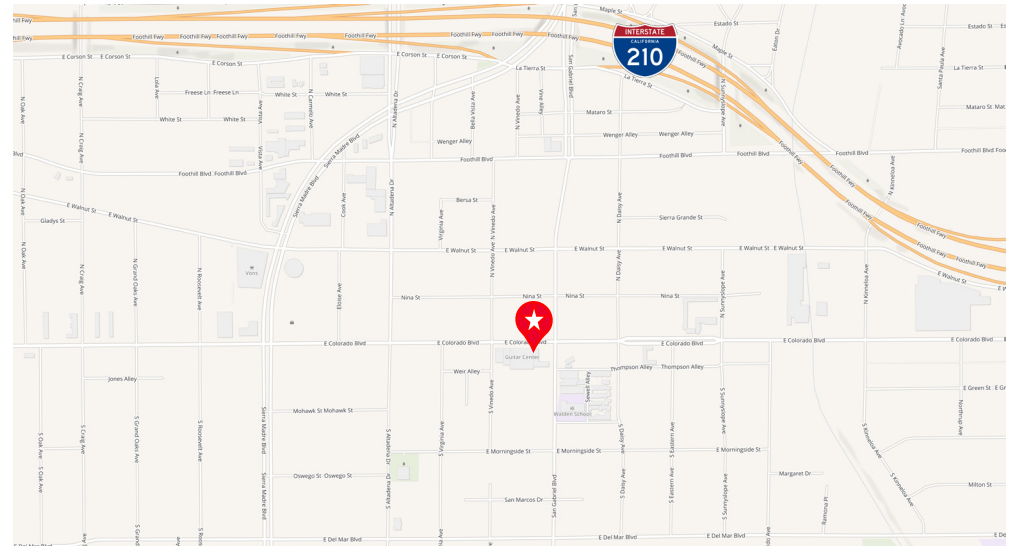
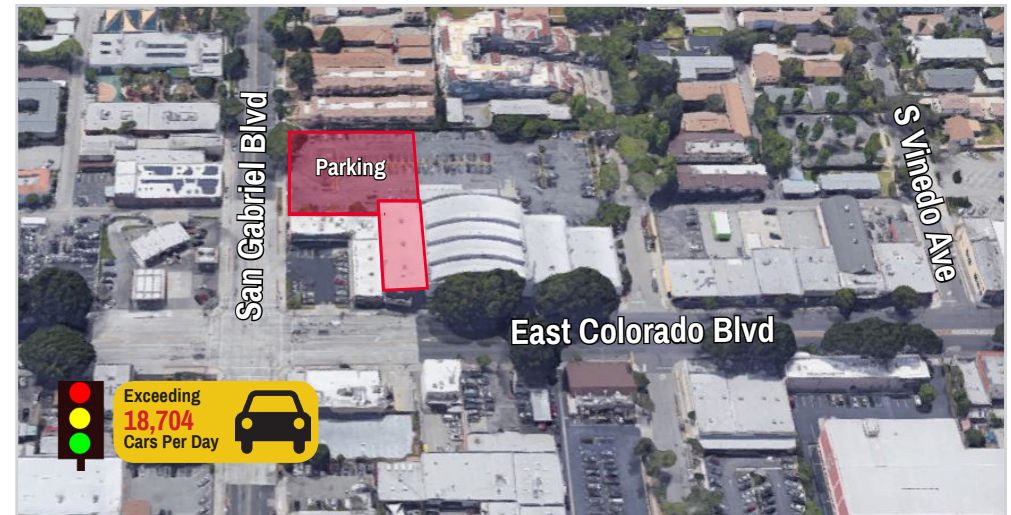

PROPERTY IMAGES



PROPERTY IMAGES



FLOOR PLANS

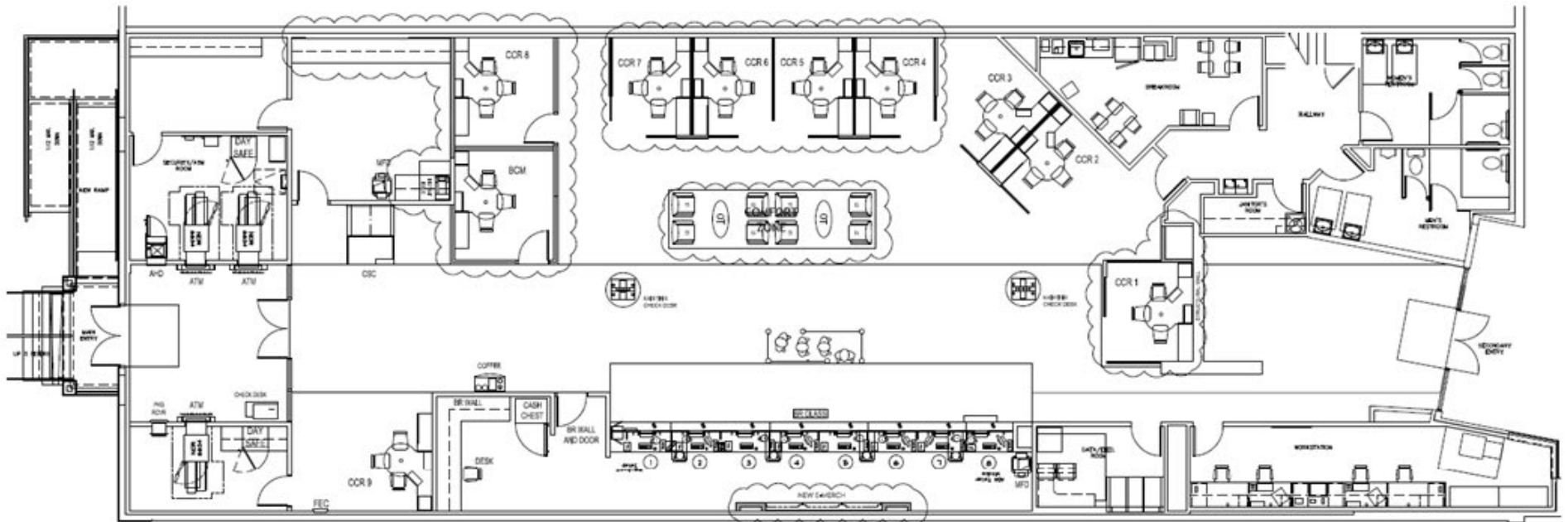

NEIGHBORING RETAILERS



DEMOGRAPHICS

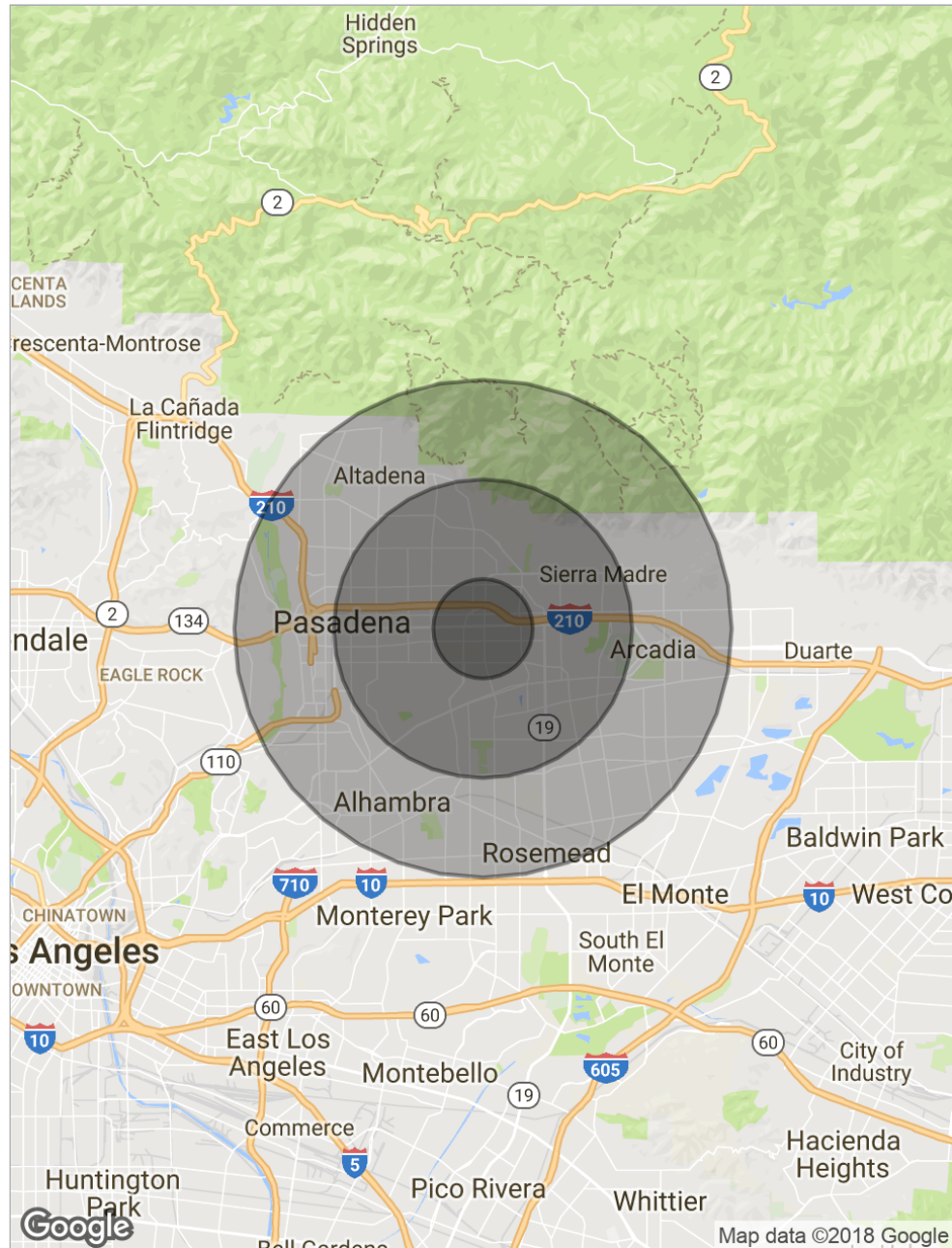

POPULATION	1 MILE	3 MILES	5 MILES
Total population	16,720	166,000	467,261
Median age	39.4	39.9	39.6
Median age (male)	38.6	39.1	38.3
Median age (Female)	40.7	40.6	40.8
HOUSEHOLDS & INCOME	1 MILE	3 MILES	5 MILES
Total households	6,664	63,873	167,908
# of persons per HH	2.5	2.6	2.8
Average HH income	\$100,462	\$104,426	\$94,539
Average house value	\$727,700	\$684,520	\$682,631
ETHNICITY (%)	1 MILE	3 MILES	5 MILES
Hispanic	25.6%	21.3%	25.5%
RACE (%)	1 MILE	3 MILES	5 MILES
White	65.0%	56.6%	46.3%
Black	2.2%	3.8%	5.4%
Asian	19.9%	28.5%	35.3%
Hawaiian	0.1%	0.3%	0.2%
American Indian	0.7%	0.4%	0.3%
Other	9.1%	7.1%	9.7%

* Demographic data derived from 2010 US Census

2670

EAST COLORADO BOULEVARD PASADENA, CA 91107

TRACY TAFT

Director

Lic. #00903455

Direct | 213.270.6207

ttaft@charlesdunn.com

CHRIS RUNYEN, CCIM

Senior Managing Director

Lic. #01208531

Direct | 213.481.1800

crunyen@charlesdunn.com

CHARLES DUNN COMPANY | 800 West Sixth Street, Suite 800 | Los Angeles, CA 90017 | Lic. #01201641 | charlesdunn.com

© Charles Dunn Company, Inc. These materials are based on information and content provided by others which we believe are accurate. No guarantee, warranty or representation is made by the Charles Dunn Company or its personnel, and all interested parties must independently verify its accuracy and completeness. As well, any projections, assumptions, opinion, or estimates are used for example only and do not represent the current or future performance of the identified property. Your tax, financial, legal and toxic substance advisors should conduct a careful investigation of the property and its suitability for your needs, including land use limitations.