

MORTON RANCH ROAD

APPROVED
MEDIAN BREAK

APPROVED
MEDIAN BREAK

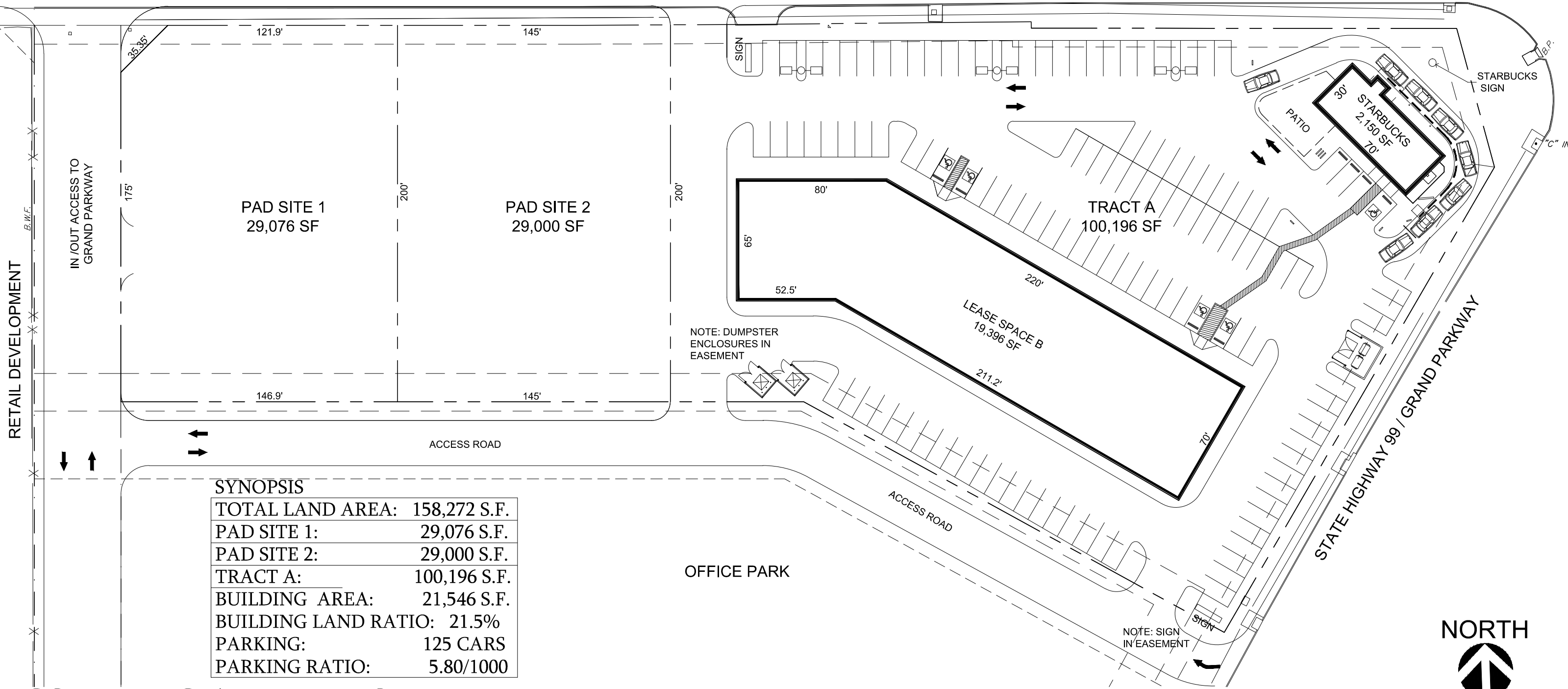

SYNOPSIS

TOTAL LAND AREA:	158,272 S.F.
PAD SITE 1:	29,076 S.F.
PAD SITE 2:	29,000 S.F.
TRACT A:	100,196 S.F.
BUILDING AREA:	21,546 S.F.
BUILDING LAND RATIO:	21.5%
PARKING:	125 CARS
PARKING RATIO:	5.80/1000

COMMERCIAL DEVELOPMENT

MORTON RANCH ROAD & STATE HIGHWAY 99
HARRIS COUNTY, TEXAS

OSBORN & VANE ARCHITECTS INC.
15124
Scale: 1"=50'
24 OCTOBER 2017
DRAWN BY: JS