



1255 BROADWAY, New York, NY 10001



146,233.00 SF

Up to 20,511 SF Available

A 11 story, first class office building located in the heart of Harold Square. This building features a renovated lobby, elevators, common areas and restrooms, 24/7 building access and located near a variety of mass transit lines. Built: 1910 Architect: Townsend, Steidle & Haskell

Tenants

Michael Vinocur
Dianna O'Doherty
Kaylas Bhiri
Jeff Campbell
Eastern Nationwide Supply, Inc.

For more information call
1-212-249-1550
KOEPEL ROSEN
40 East 69th Street
New York, NY 10021
dkoepfel@koepfelrosen.com



1255 BROADWAY, New York, NY 10001

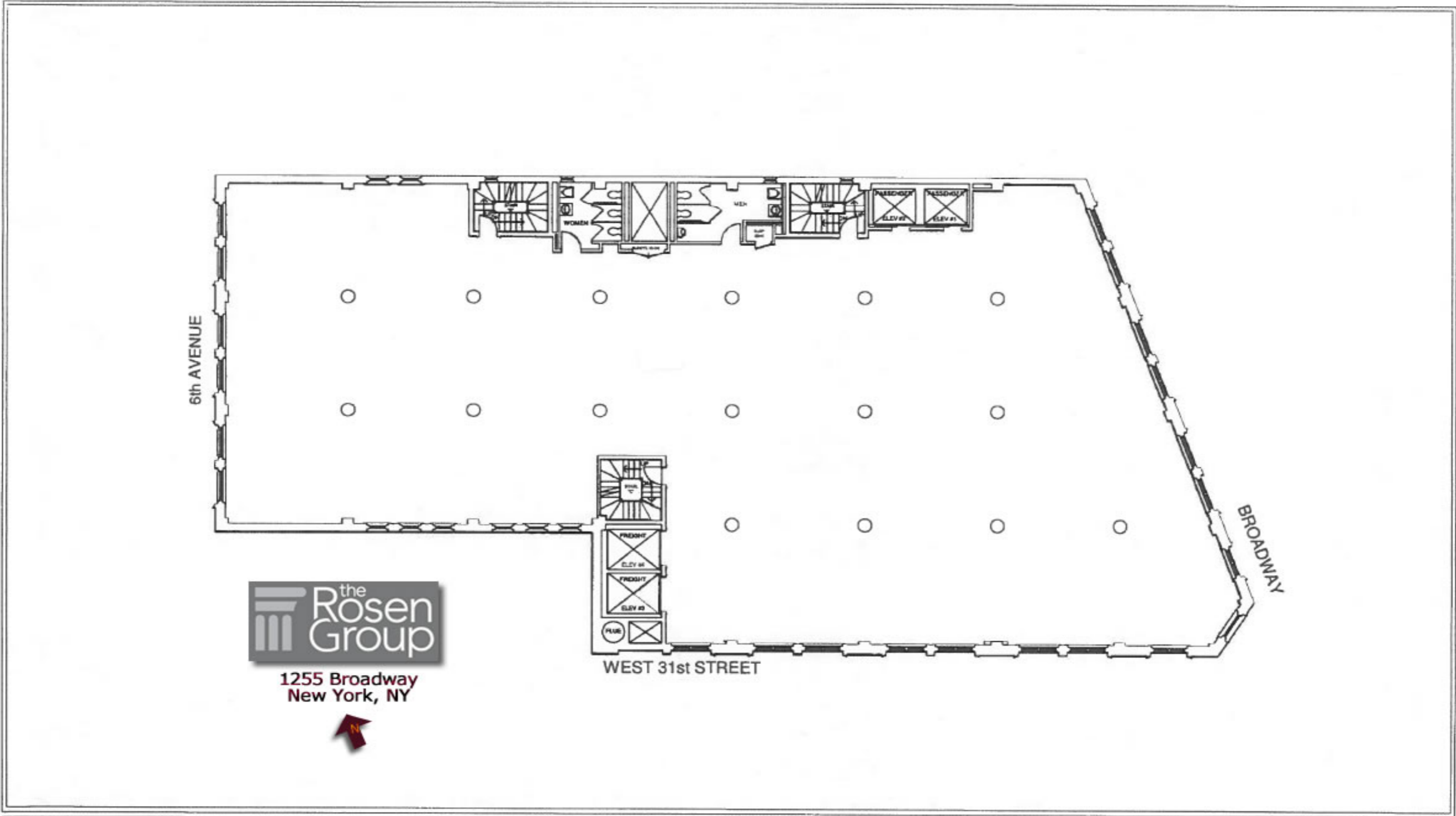

Leasing and Managing Agent



Koeppel Rosen LLC

40 East 69th Street
New York, NY 10021
212-249-1550
www.koeppelrosen.com

Typical Floor Plan

All areas and dimensions are approximate. Field verification is necessary.
Date Printed: 7/11/2012

For more information call
1-212-249-1550
KOEPEL ROSEN
40 East 69th Street
New York, NY 10021
dkoeppel@koeppelrosen.com