

FOR LEASE

18,150 SF on 1.6 Acres

4300 W. Lake Street
CHICAGO, IL 60624



Property Images

PROPERTY SPECIFICATIONS

Available Space	Unit A: ± 18,150 Sq. Ft. Unit B: ± 9,950 Sq. Ft. LEASED
Building Sq. Ft.	± 38,111 Sq. Ft.
Office Sq. Ft.	To-Suit
Ceiling Height	22' Clear
Loading	1 Drive-In Door, 2 Interior Recessed Docks
Sprinklers	Wet System
Heating	Gas Forced Air
Power	400 Amps, 240 V, 3-Phase
Zoning	PMD-9
Lease Rate	\$4.75 PSF Modified Gross Year 1 Rate*
Comments	<ul style="list-style-type: none">SBIF available for tenants, up to \$100,000Modern WarehouseLandlord will customize spaceFenced and Gated Parking & Exterior StorageComplete remodel in 2007

For more information,
please contact:

FRANK H. MELCHERT
Senior Vice President
312 241-1424
Frank@NelsonHill.com

STEVAN ARANDJELOVIC
Associate
312 533-2146
Stevan@NelsonHill.com

NelsonHill
1111 S. Western Avenue
Chicago, IL 60612

All information contained herein is
from sources deemed reliable and is
submitted subject to errors, omissions
and to change of price or terms
without notice.

FOR LEASE

18,150 SF on 1.6 Acres

4300 W. Lake Street
CHICAGO, IL 60624

Site Plan

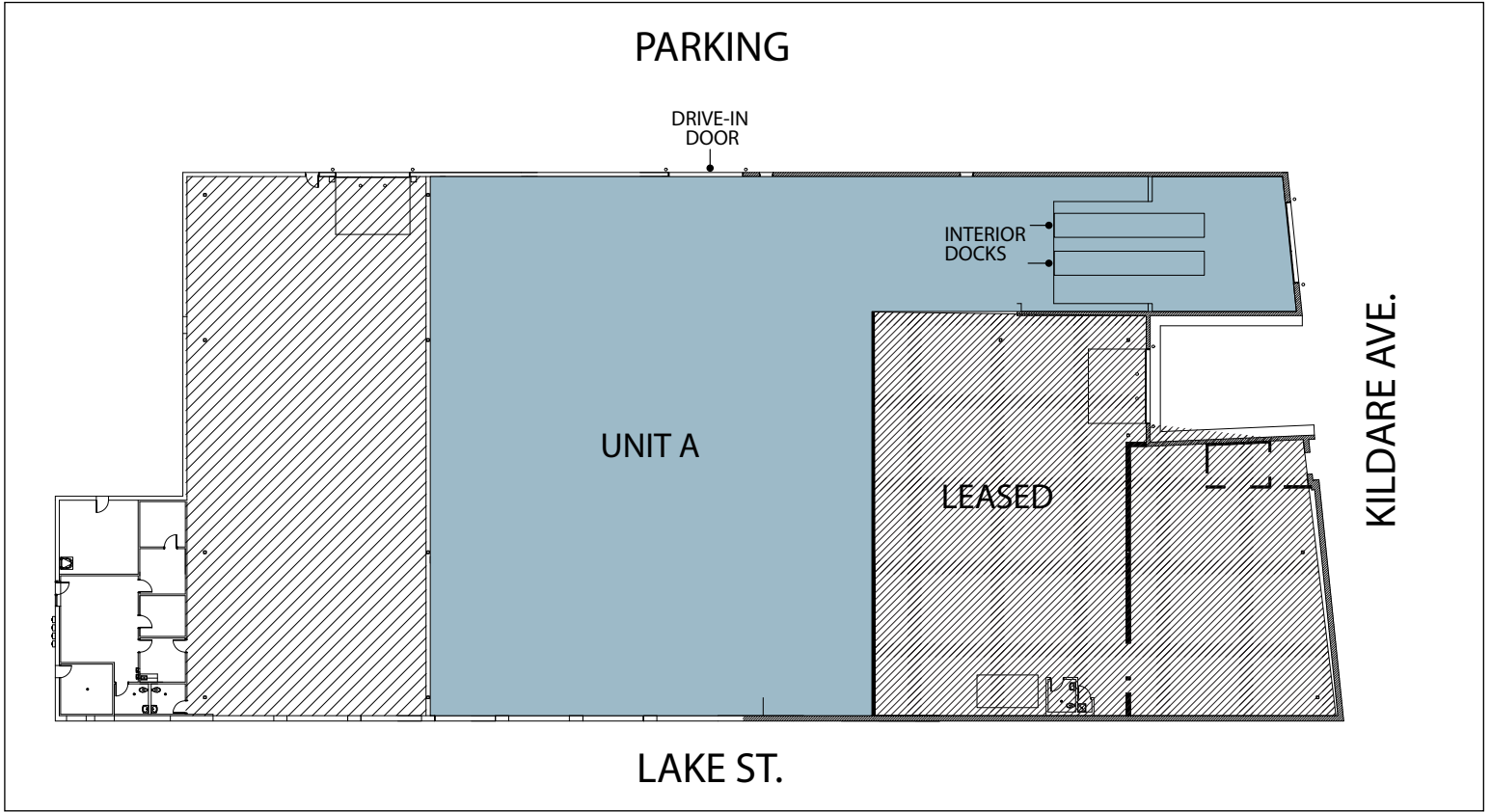

For more information,
please contact:

FRANK H. MELCHERT

Senior Vice President

312 241-1424

Frank@NelsonHill.com

STEVAN ARANDJELOVIC

Associate

312 533-2146

Stevan@NelsonHill.com

NelsonHill

1111 S. Western Avenue
Chicago, IL 60612

All information contained herein is
from sources deemed reliable and is
submitted subject to errors, omissions
and to change of price or terms
without notice.



Property Location