

Two New ±21,200 SF Freestanding Buildings on ±1.22 Acres Each



Building Shown is Only an Example - Not Actual Buildings

AVAILABLE FOR SALE

13184 & 14036 Whittram Ave., Fontana, CA. 92335

PROPERTY FEATURES

- Two New Clear Span Metal Buildings
- ±21,200 SF Per Building
- Clear Span Warehouse
- Fully Sprinklered
- 24' Clear Height
- Four (4) Ground Level Doors
- I/C County Zoning
- Large Fenced Yard Areas
- ±2,400 SF of Office Space
- Building can be customized for Buyer's Use

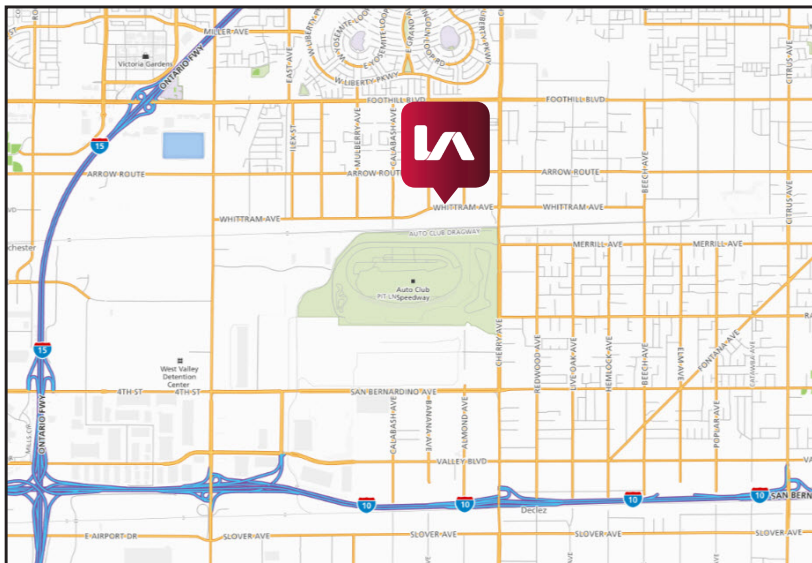

FOR MORE INFORMATION PLEASE CONTACT:

John Mulrooney, Senior Vice President

(909) 373.2928

jmulrooney@lee-assoc.com

DRE #00839176



Lee & Associates® - Ontario / Corporate ID # 00976995

All information furnished regarding property for sale, rental or financing is from sources deemed reliable, but no warranty or representation is made to the accuracy thereof and same is submitted to errors, omissions, change of price, rental or other conditions prior to sale, lease or financing or withdrawal without notice. No liability of any kind is to be imposed on the broker herein.

AVAILABLE FOR SALE

13184 & 14036 Whittram Ave., Fontana, CA. 92335

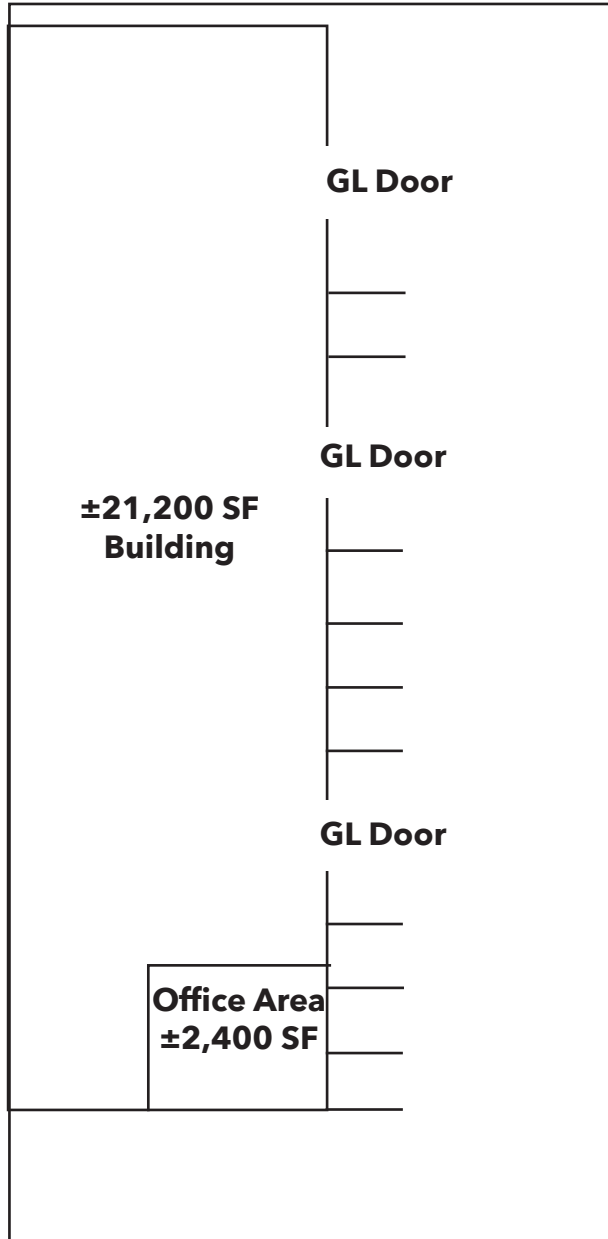

13184 Whittram Ave.

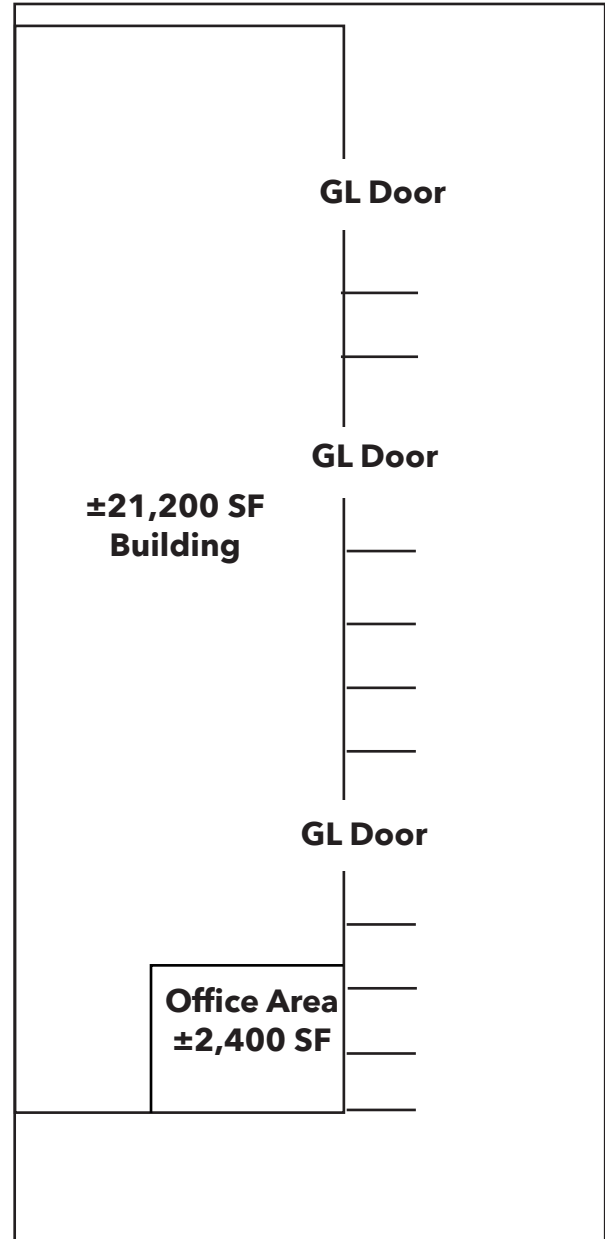

14036 Whittram Ave.

FOR MORE INFORMATION PLEASE CONTACT:

John Mulrooney, Senior Vice President

(909) 373.2928

jmulrooney@lee-assoc.com

DRE #00839176

Lee & Associates® - Ontario

3535 Inland Empire Blvd, Ontario, CA 91764

| 909.989.7771 | lee-assoc.com

Corp ID 00976995

All information furnished regarding property for sale, rental or financing is from sources deemed reliable, but no warranty or representation is made to the accuracy thereof and same is submitted to errors, omissions, change of price, rental or other conditions prior to sale, lease or financing or withdrawal without notice. No liability of any kind is to be imposed on the broker herein.