

**FOR
LEASE**

CLASS "A" OFFICE SPACE

HEAVEN OFFICE BUILDING

8240 EXCHANGE DRIVE

ORLANDO, FL 32809



**Luxury
Class A
Space**

CONTACT

Vincent F. Wolle, CCIM, SIOR
407.448.1823 *mobile*
CREManager@Gmail.com

Results Real Estate Partners, LLC
Licensed Commercial Real Estate Brokers
108 Commerce Street, Suite 200
Lake Mary, Florida 32746

407.647.0200 *main*
407.647.0205 *fax*

www.ResultsREPartners.com

PROPERTY HIGHLIGHTS

- (10) Suites from 956 SF to 13,518 SF Class "A" Office Space
- Green Construction with Bio Metrics Entry Points, Video Surveillance, and Upscale Finishes for High End Users, with Beautiful Waterfront Views
- Ample Parking 4/1000 and overflow parking as needed
- Owner will build out the units to the Tenant's requirements
- Owner will amortize upgraded finishes
- 5 Year minimum lease terms
- Close to: I-4, 441, John Young PWKY, Sand Lake Road, 528, and visible to the Turn Pike. 15 minutes away from the Airport
- **Lease Rate:** **\$22-24 PSF Modified Gross**

This information is from sources we deem reliable and is subject to prior sale, lease, withdrawal without notice, or change in prices, rates, or conditions. No representation is made as to the accuracy of any information furnished.

**FOR
LEASE**

**CLASS "A" OFFICE SPACE
HEAVEN OFFICE BUILDING**

**8240 EXCHANGE DRIVE
ORLANDO, FL 32809**

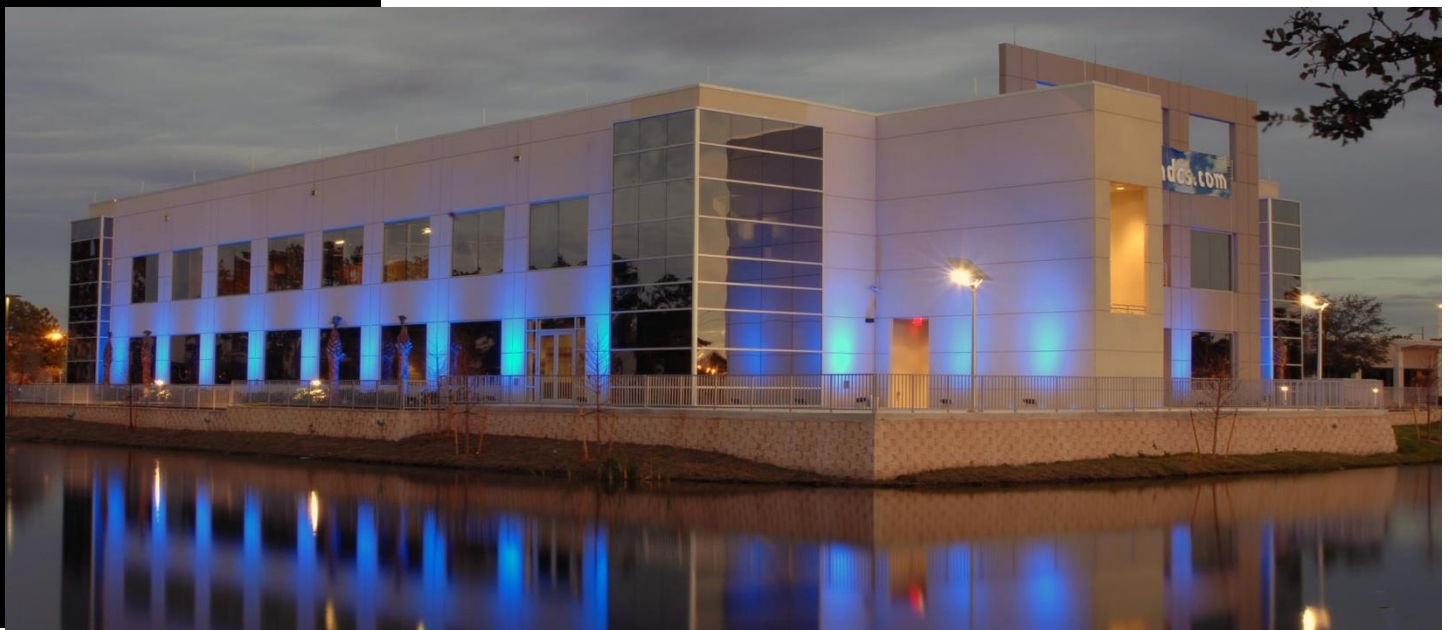
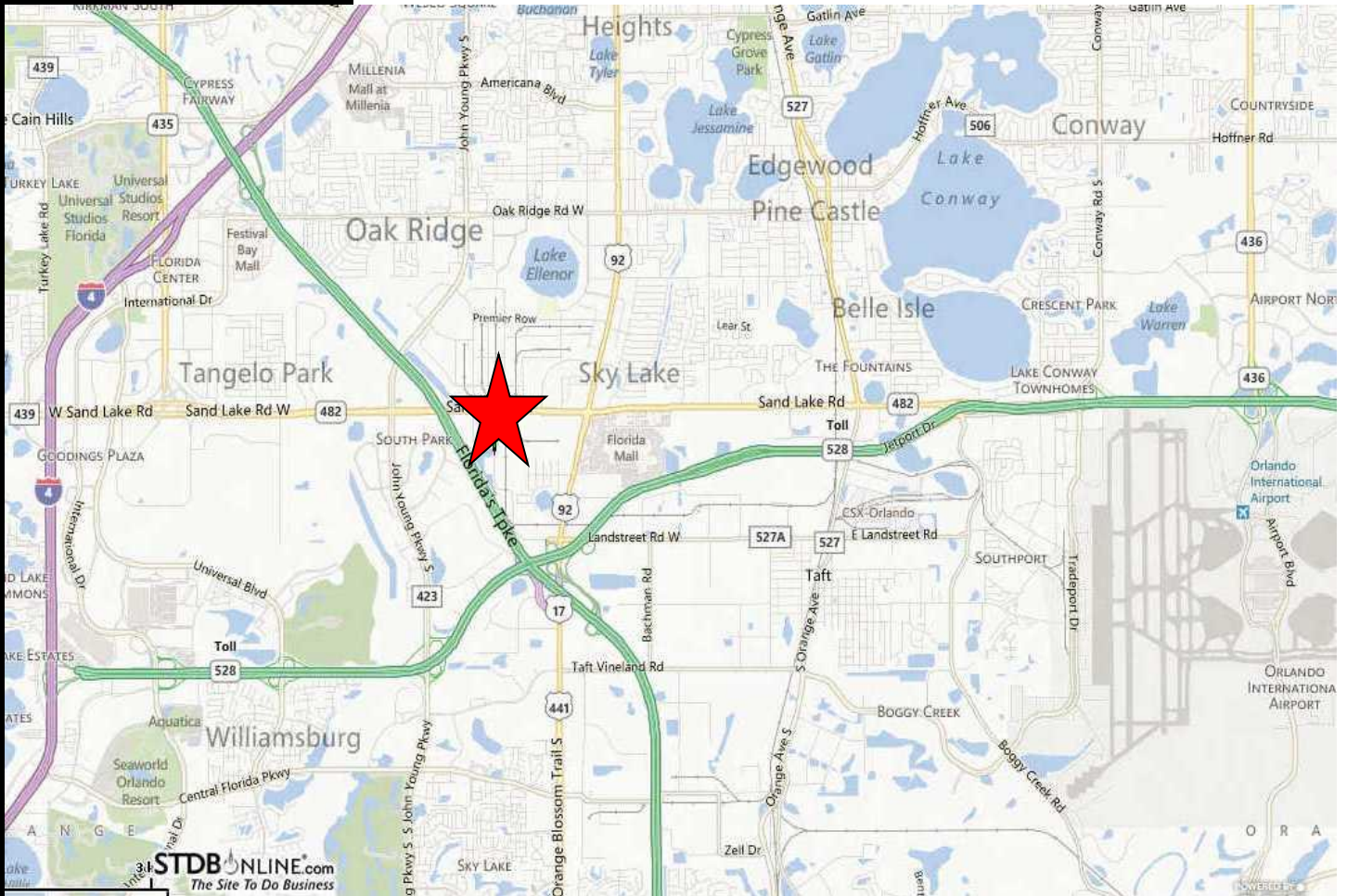

**FOR
LEASE**

**CLASS "A" OFFICE SPACE
HEAVEN OFFICE BUILDING**

**8240 EXCHANGE DRIVE
ORLANDO, FL 32809**

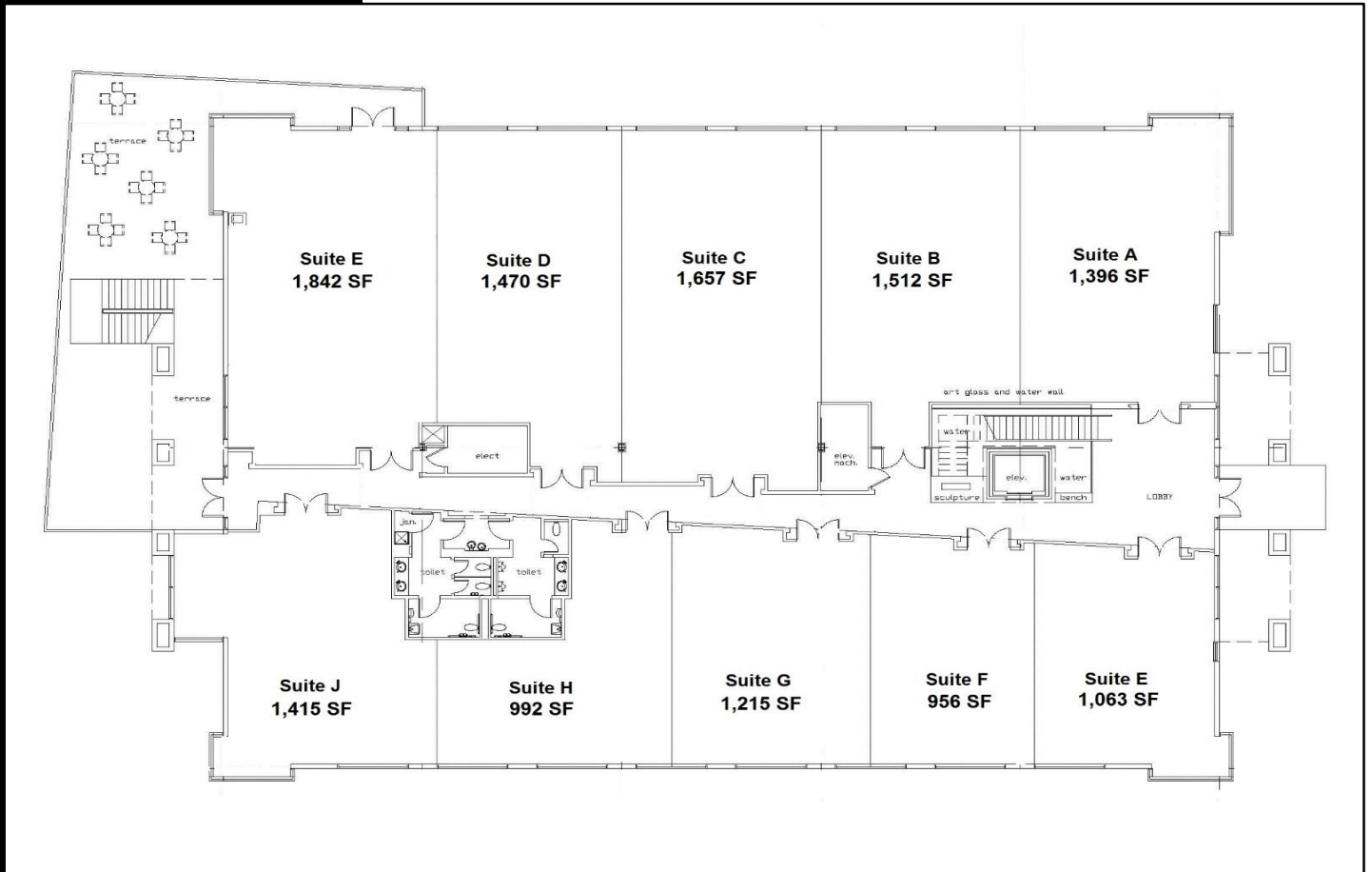

CONTACT

Vincent F. Wolle, CCIM, SIOR
407.448.1823 *mobile*
CREManager@Gmail.com

Results Real Estate Partners, LLC
Licensed Commercial Real Estate Brokers
108 Commerce Street, Suite 200
Lake Mary, Florida 32746

407.647.0200 *main*
407.647.0205 *fax*

www.ResultsREPartners.com

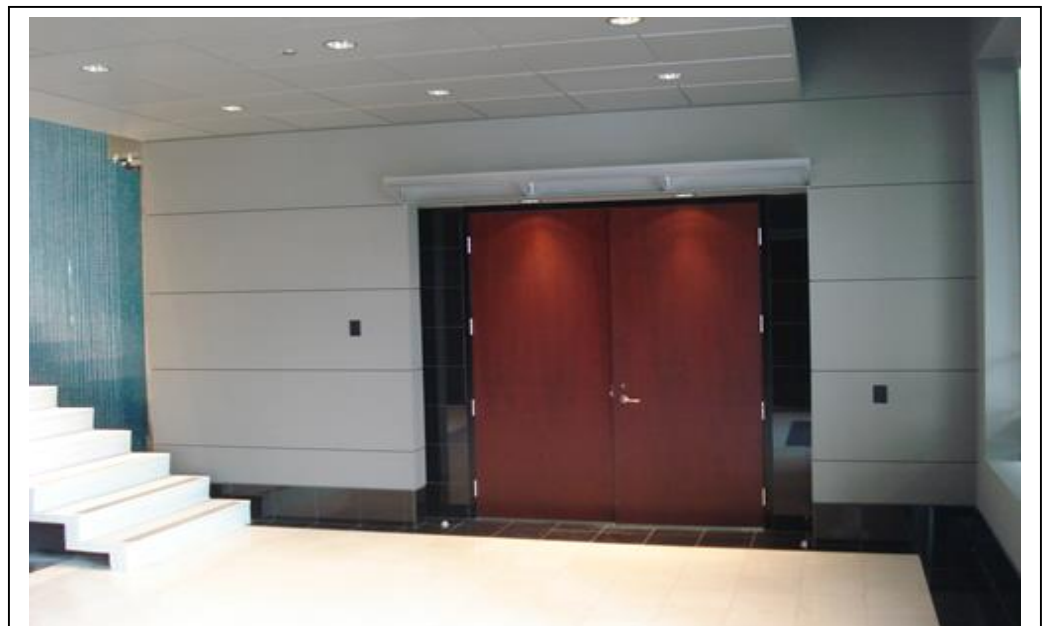

This information is from sources we deem reliable and is subject to prior sale, lease, withdrawal without notice, or change in prices, rates, or conditions. No representation is made as to the accuracy of any information furnished.