

OFFICE SPACE FOR SUBLEASE

300 Harding Blvd., Roseville, CA 95678



PROPERTY HIGHLIGHTS

- For Sublease: ±2,800 SF
- Rate: \$1.60/SF; Full Service (Excluding Janitorial)
- Great corner suite with break room
- Professional lobby entrance
- Convenient Tenant directory
- Open air courtyard with lush greenery
- Suite signage available

LOCATION OVERVIEW

Prime location on Harding Blvd near many amenities including: Roseville Galleria, The Fountains, Trader Joes, Starbucks, Claim Jumpers and many more.

SEAN CORCORAN, CCIM

Dir: 916.677.8136

Cell: 916.505.4368

scorcoran@tricommercial.com

CalDRE #00821962

TRI Commercial Real Estate Services 532 Gibson Drive, Suite 200, Roseville, CA 95678



FOR SUBLEASE OFFICE SPACE

2ND FLOOR PLAN

300 Harding Blvd.

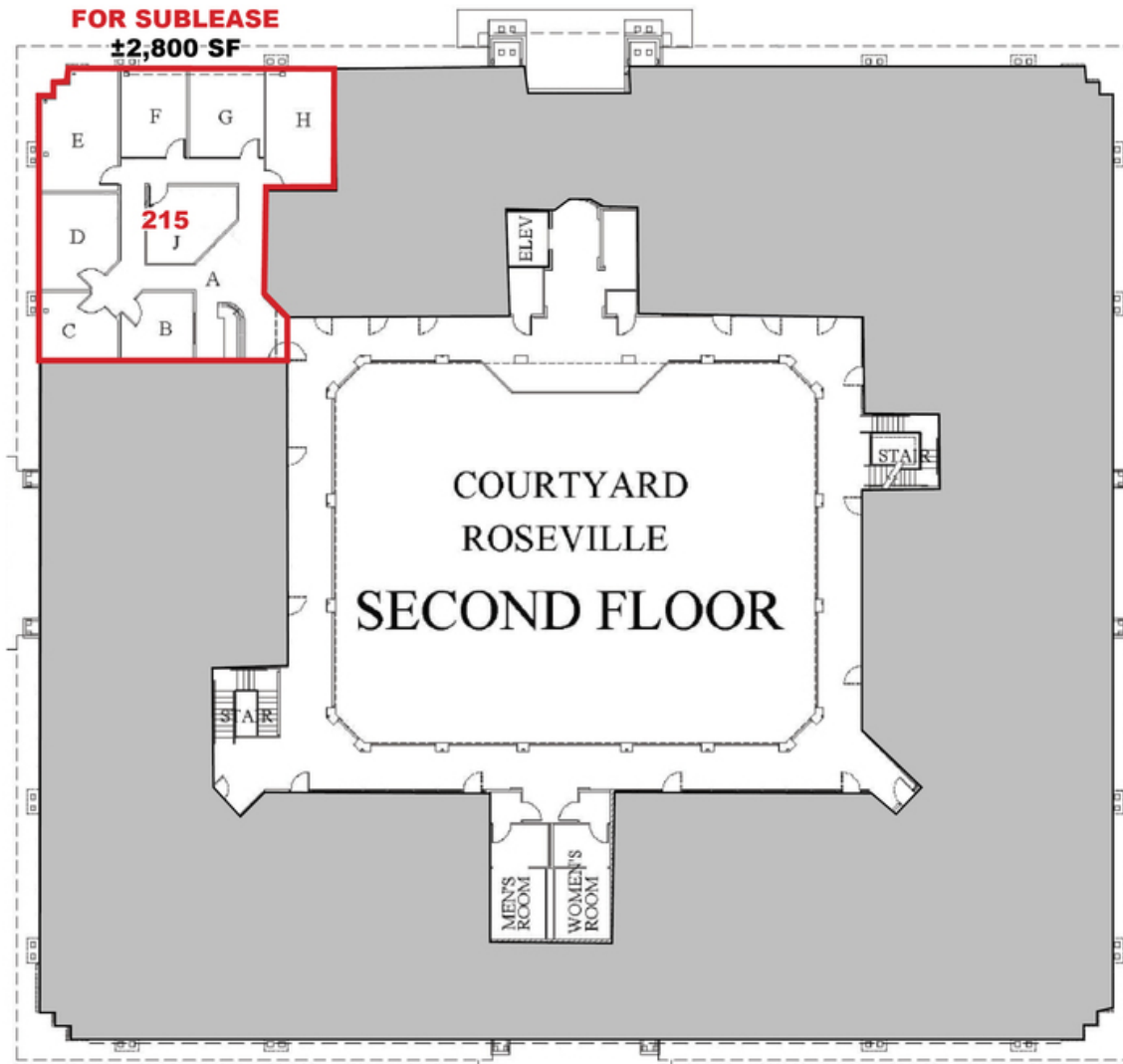

FOR SUBLEASE OFFICE SPACE

LOCATION MAPS

300 Harding Blvd.

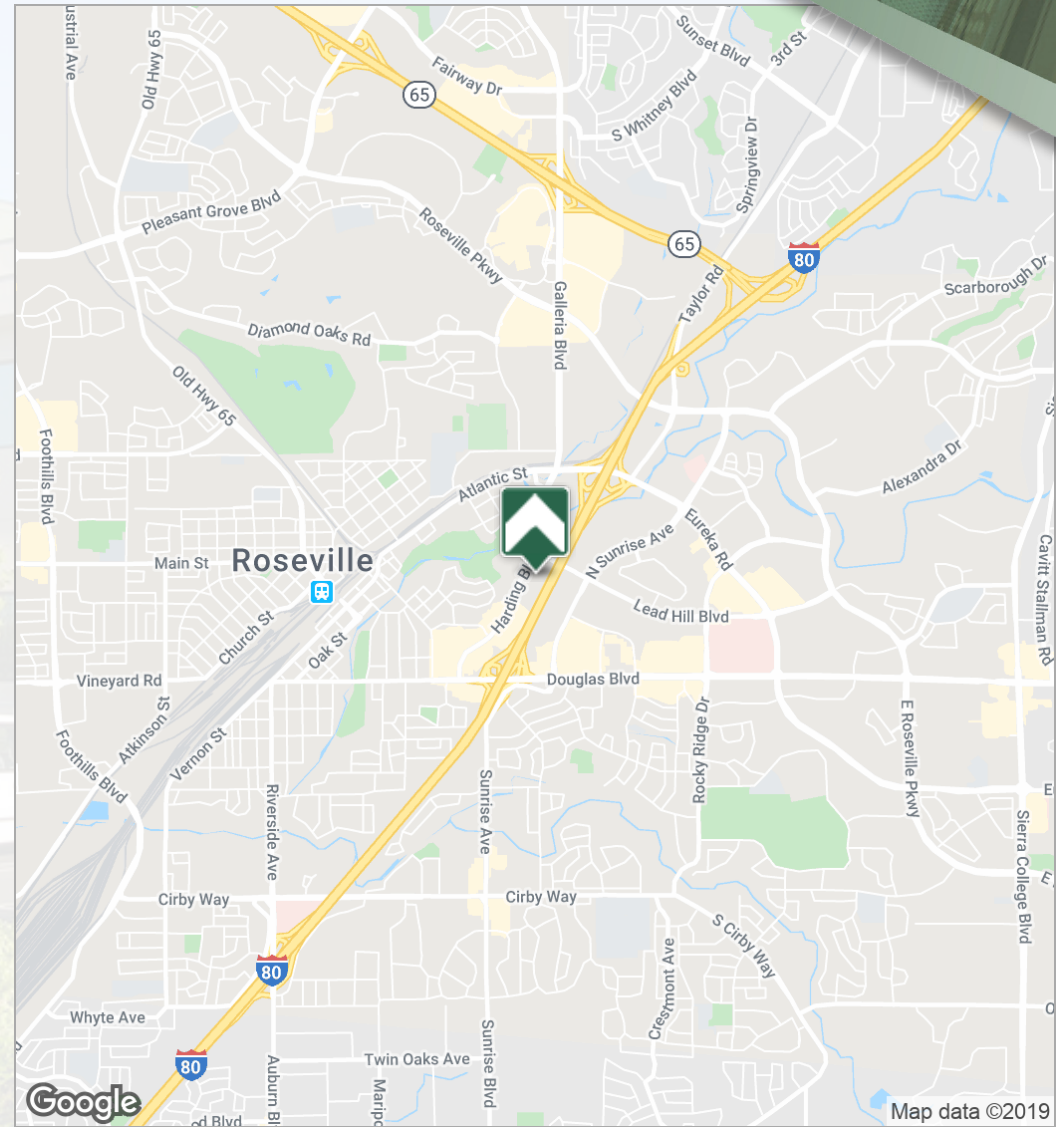
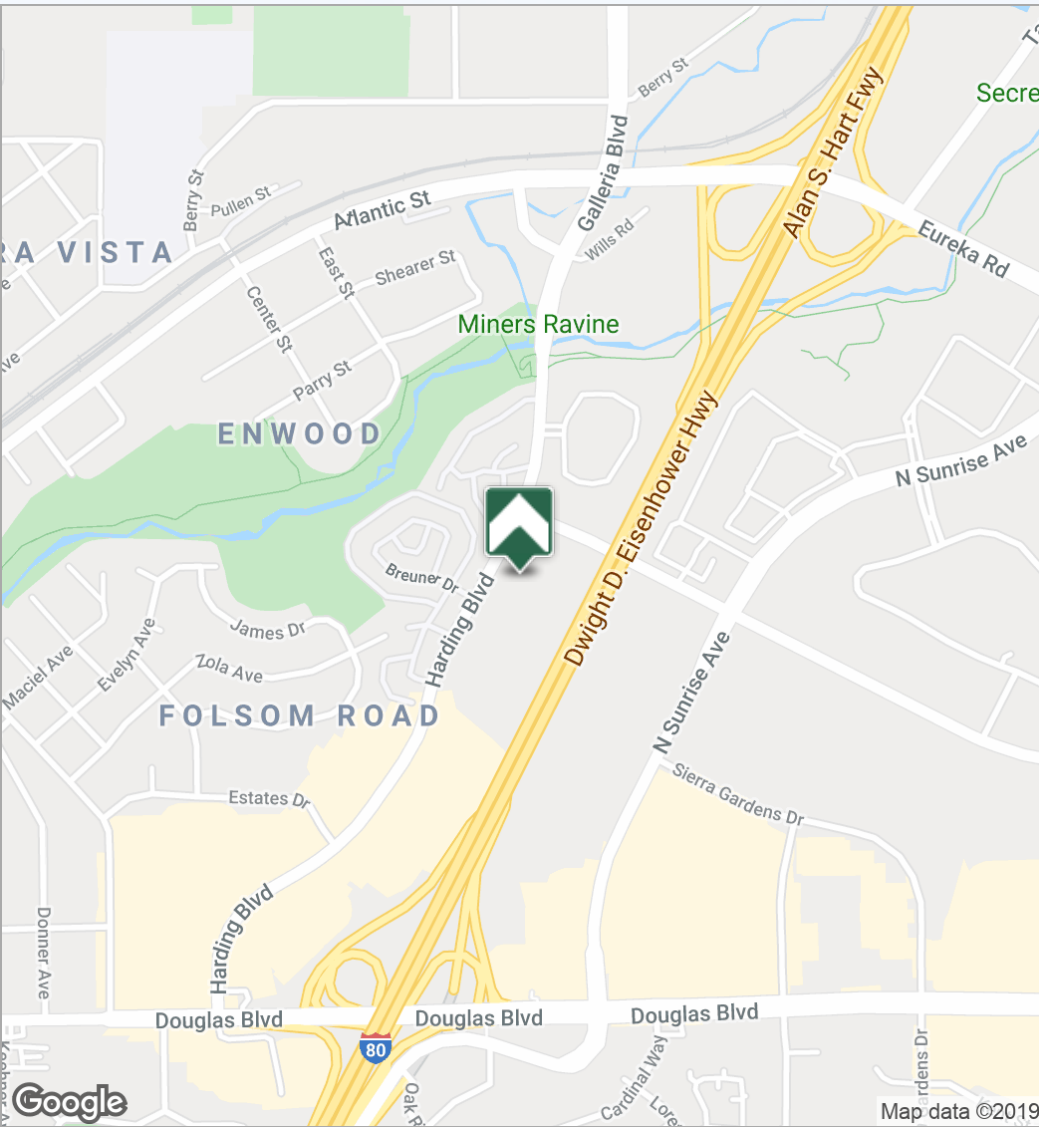

FOR SUBLEASE OFFICE SPACE

DEMOGRAPHICS MAP

300 Harding Blvd.

POPULATION	1 MILE	3 MILES	5 MILES
Total population	8,489	99,859	259,617
Median age	39.0	36.5	36.0
Median age (Male)	34.9	33.9	34.2
Median age (Female)	42.2	38.9	38.0
HOUSEHOLDS & INCOME	1 MILE	3 MILES	5 MILES
Total households	3,731	39,744	97,867
# of persons per HH	2.3	2.5	2.7
Average HH income	\$73,509	\$80,339	\$83,718
Average house value	\$358,588	\$398,721	\$412,114
ETHNICITY (%)	1 MILE	3 MILES	5 MILES
Hispanic	15.8%	14.4%	14.0%
RACE (%)	1 MILE	3 MILES	5 MILES
White	85.8%	82.6%	82.7%
Black	1.7%	1.4%	2.1%
Asian	4.7%	7.1%	6.4%
Hawaiian	0.2%	0.3%	0.3%
American Indian	0.3%	1.1%	0.7%
Other	3.6%	4.4%	4.4%

* Demographic data derived from 2010 US Census

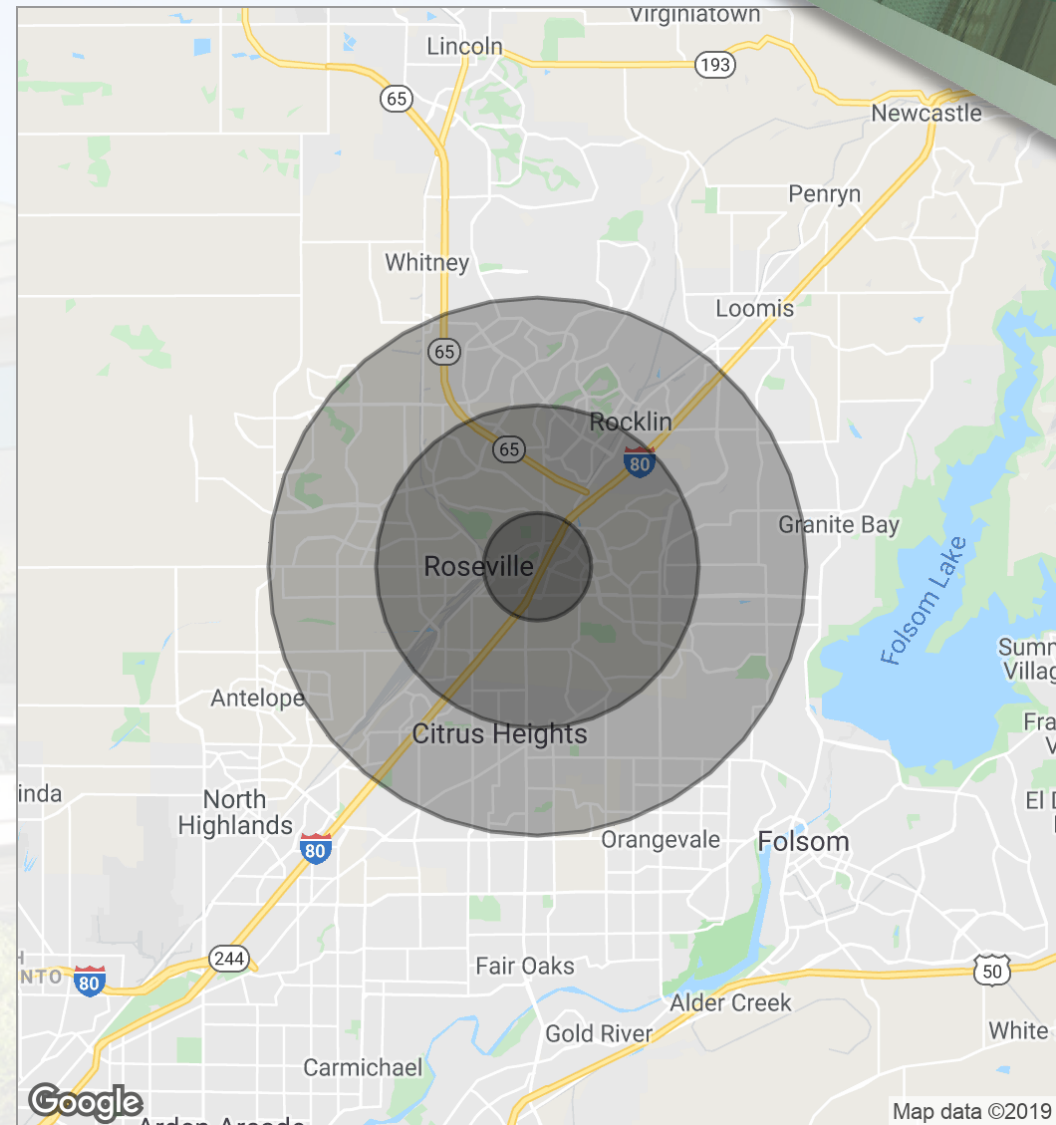



Sean Corcoran, CCIM

Dir: 916.677.8136

Cell: 916.505.4368

scorcoran@tricommercial.com

CalDRE #00821962

TRI Commercial Real Estate Services
532 Gibson Drive Suite 200, Roseville, CA 95678

Dir: 916.677.8000

Fax: 916.677.8199

www.tricommercial.com

