



GROUND FLOOR OFFICE/RETAIL SPACE FOR LEASE 2920 TELEGRAPH AVENUE | BERKELEY, CA

BEN JONES
bjones@lee-associates.com
510-903-7606
LIC# 01758720

**LEE &
ASSOCIATES**[®]
COMMERCIAL REAL ESTATE SERVICES

DAVE MCCARTY
dmccarty@lee-associates.com
510-903-7601
LIC#01748283

2920 TELEGRAPH AVENUE | BERKELEY, CA

PROPERTY HIGHLIGHTS & FEATURES:

- 3,400± Square Foot Ground Floor Office Zoned For Medical
- Newly Renovated Building
- Renovated Exterior, New Plumbing Systems
- Secure Parking Stalls
- Signage Available
- Owner/Developer Specializes In Medical Space
- Great Proximity To Alta Bates Summit Medical Center
- **AMPLE TENANT IMPROVEMENT ALLOWANCE AVAILABLE!**
- **LEASE RATE: NEGOTIABLE**

BEN JONES

bjones@lee-associates.com

510-903-7606

LIC# 01758720



DAVE MCCARTY

dmccarty@lee-associates.com

510-903-7601

LIC#01748283

2920 TELEGRAPH AVENUE | BERKELEY, CA

PROPERTY HIGHLIGHTS & FEATURES:



BEN JONES
bjones@lee-associates.com
510-903-7606
LIC# 01758720

 **LEE &
ASSOCIATES®**
COMMERCIAL REAL ESTATE SERVICES

DAVE MCCARTY
dmccarty@lee-associates.com
510-903-7601
LIC#01748283

2920 TELEGRAPH AVENUE | BERKELEY, CA

FLOOR PLAN OPTIONS:

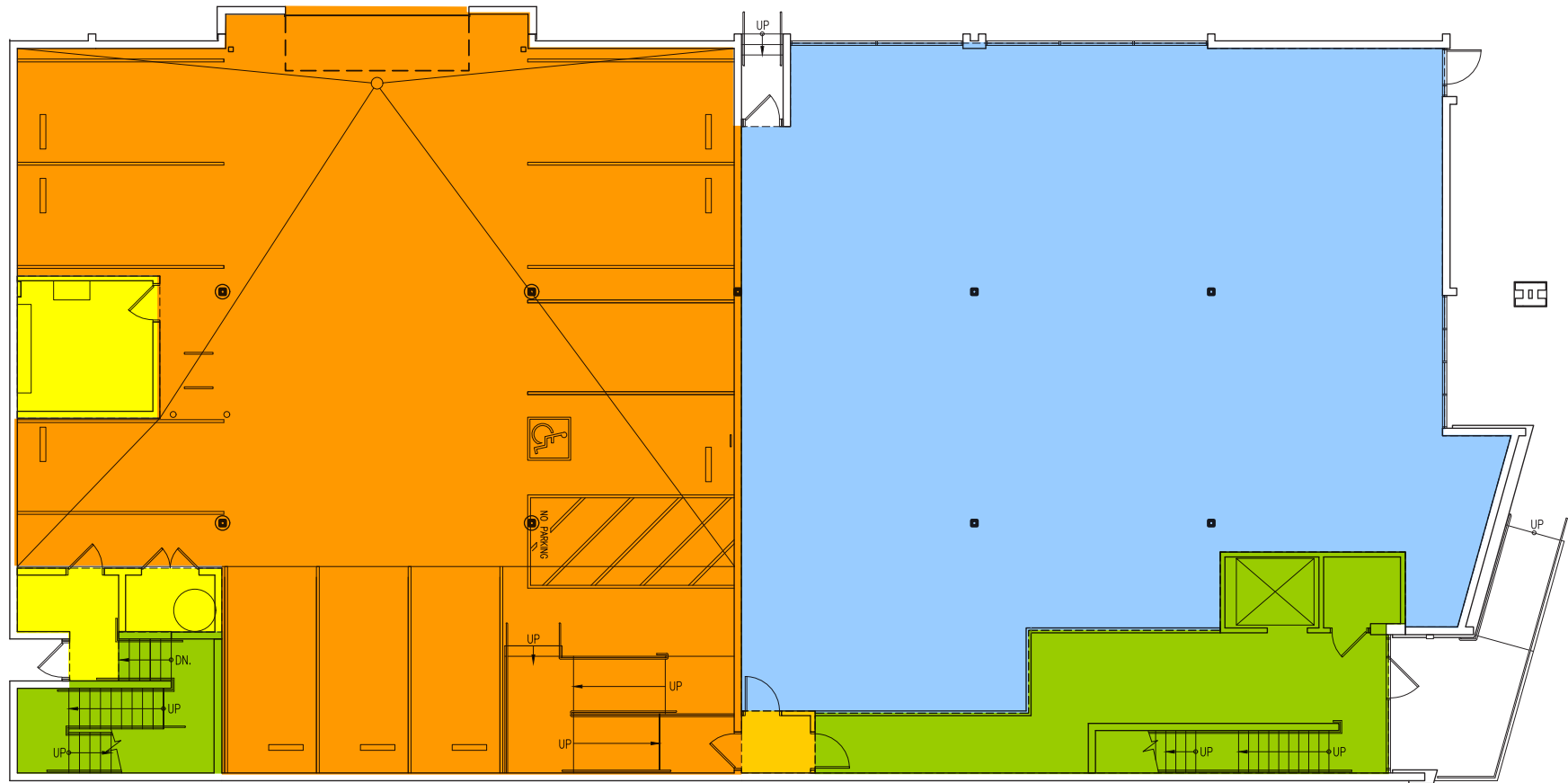

BEN JONES

bjones@lee-associates.com

510-903-7606

LIC# 01758720



**LEE &
ASSOCIATES®**

COMMERCIAL REAL ESTATE SERVICES

DAVE MCCARTY

dmccarty@lee-associates.com

510-903-7601

LIC#01748283