

# Office Space for Lease

1699 Washington Rd, Pittsburgh, PA 15228



## Property Features

- ❖ Excellent visibility from signalized intersection
- ❖ Full Service Lease Rates
- ❖ 10 minute walk from South Hills Village and Bethel Village T Stations
- ❖ New Paint and Carpet in Common Hallways
- ❖ Units available 777 to 2688 SF
- ❖ Lease terms negotiable
- ❖ Walkable access to New Whole Foods, Chipotle, Olive Garden, and more

## LANDMARK BUILDING

1699 Washington Road  
4th Floor

Note: All dimensions approximate and subject to change.

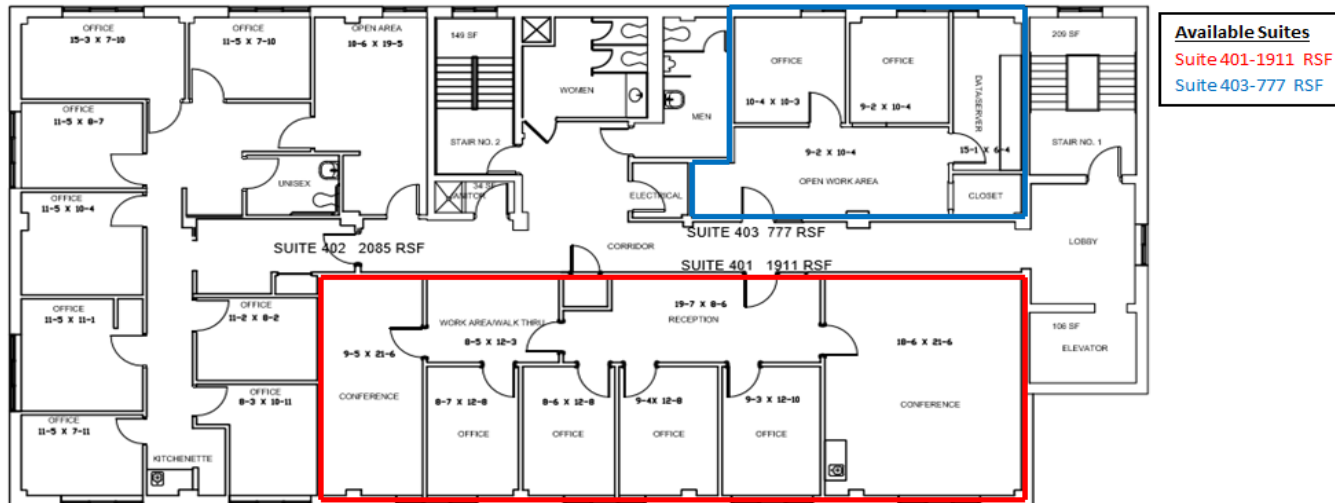

**Marcy Pocci**  
mrp@madisonrealtygroup.com  
(412) 281-1880 ext. 317

**Samuel Morris**  
stm@madisonrealtygroup.com  
(412) 281-1880 ext. 301

# Office Space for Lease

1699 Washington Rd, Pittsburgh, PA 15228



Marcy Pocci  
mrp@madisonrealtygroup.com  
(412) 281-1880 ext. 317

Samuel Morris  
stm@madisonrealtygroup.com  
(412) 281-1880 ext. 301