

Ackerman & Co.

INDUSTRIAL PROPERTIES FOR LEASE

Lavista Business Park
2000-2068 Weems Road
Tucker, GA 30084



NOW LEASING: SHALLOW-BAY INDUSTRIAL TUCKER/NORTHLAKE SUBMARKET OF ATLANTA

Lavista Business Park
2000-2068 Weems Road
Tucker, GA 30084

- 12,000 SF available
- Immediate access to I-285, I-85 and Highway 78
- Master-planned park environment
- Generous TI packages available
- Dock-high doors
- Walkable to multiple amenities including: shopping, hotels, restaurants
- 20' clear heights
- Improved landscaping and exteriors
- Best-in-class property management services



12,000 SF
AVAILABLE IMMEDIATELY

Lavista Business Park
 2000-2068 Weems Road
 Tucker, GA 30084

BUILDING D

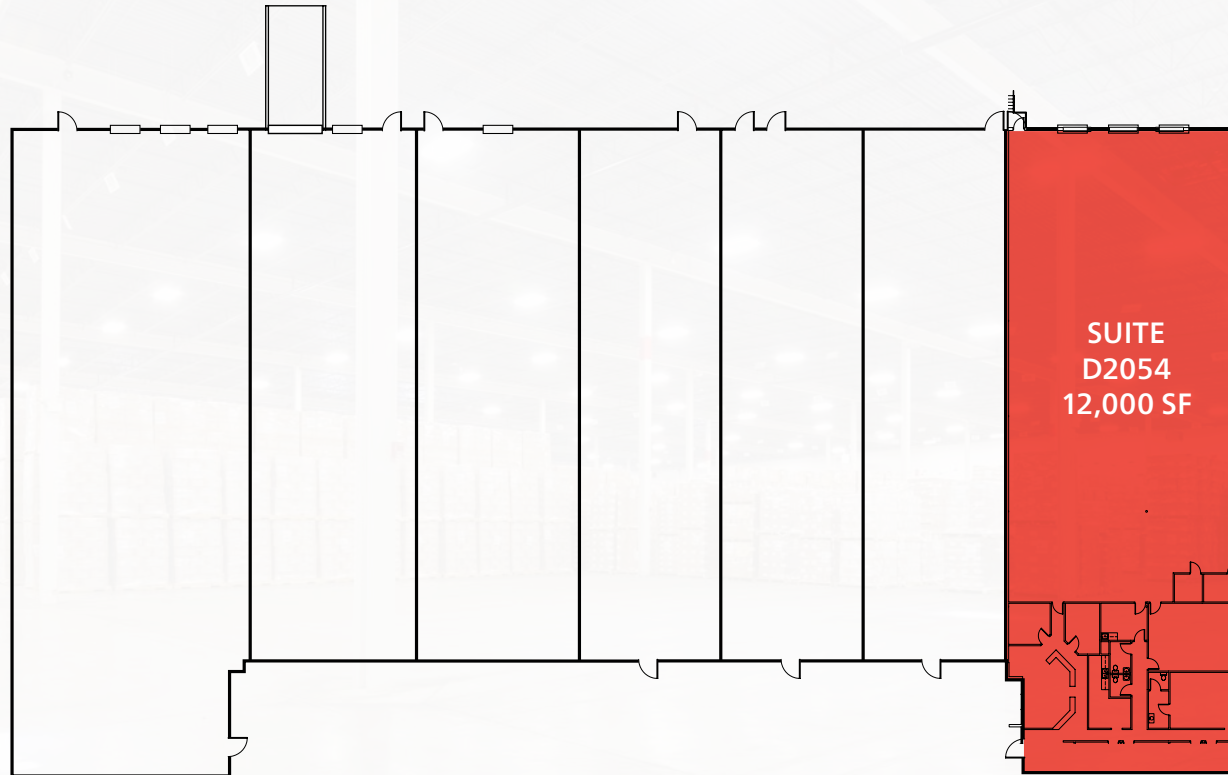

CEILING HEIGHTS & LOADING FACILITIES

Building	Clear Height	Dock-High Doors	Dock-High w/ Ramp
D	20'	*13	0

BUILDING / TRUCK COURT DEPTH

Building	Building Depth	Truck Court Depth
D	155' - 182'	78'

**Two additional dock-high doors are enclosed.*

STRATEGIC IRREPLACEABLE INFILL LOCATION | QUALITY PRODUCT = LOW DOWNTIME, LEASING VELOCITY

EXCEPTIONAL DISTRIBUTION LOCATION

Full diamond interchange I-285	0.5 miles
Spaghetti Junction/ I-85	3.8 miles

DEMOGRAPHICS

	3 Miles	5 Miles
2020 Population	95,359	322,544
Projected Population (2025)	99,251	337,923

