

FOR LEASE > 2,400 SQUARE FOOT INDUSTRIAL/WAREHOUSE

STOWE INDUSTRIAL PARK

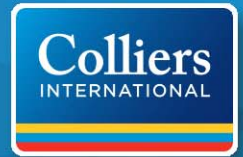

12320 STOWE DRIVE, SUITES C/D | POWAY, CA 92064



Building Features

- > Approximately 2,400 square feet available located in a 13,479 square foot industrial building
- > Reception, one private window office; balance warehouse
- > 18' clear height
- > 1 grade level roll-up door
- > 200 amps 3 Phase Power
- > One restroom
- > Great image and location
- > Available April 15, 2013
- > **LEASE RATE: \$0.95 PSF GROSS**

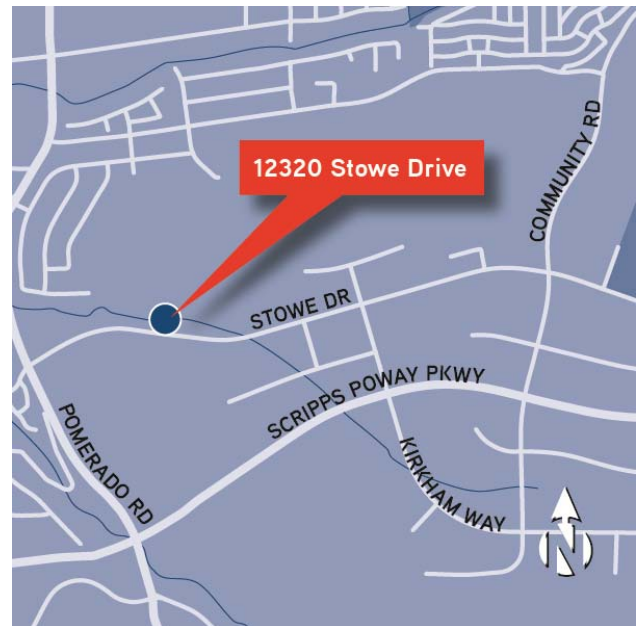

EVAN MCDONALD
858 677 5339
evan.mcdonald@colliers.com
Lic. No. 01813359

MIKE BENCH
858 677 5317
mike.bench@colliers.com
Lic. No. 01887495

COLLIERS INTERNATIONAL
4660 La Jolla Village Drive, Suite 100
San Diego, CA 92122
www.colliers.com/sandiego

FOR LEASE > 2,400 SQUARE FOOT INDUSTRIAL/WAREHOUSE

STOWE INDUSTRIAL PARK

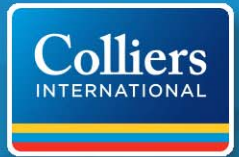

12320 STOWE DRIVE, SUITES C/D | POWAY, CA 92064

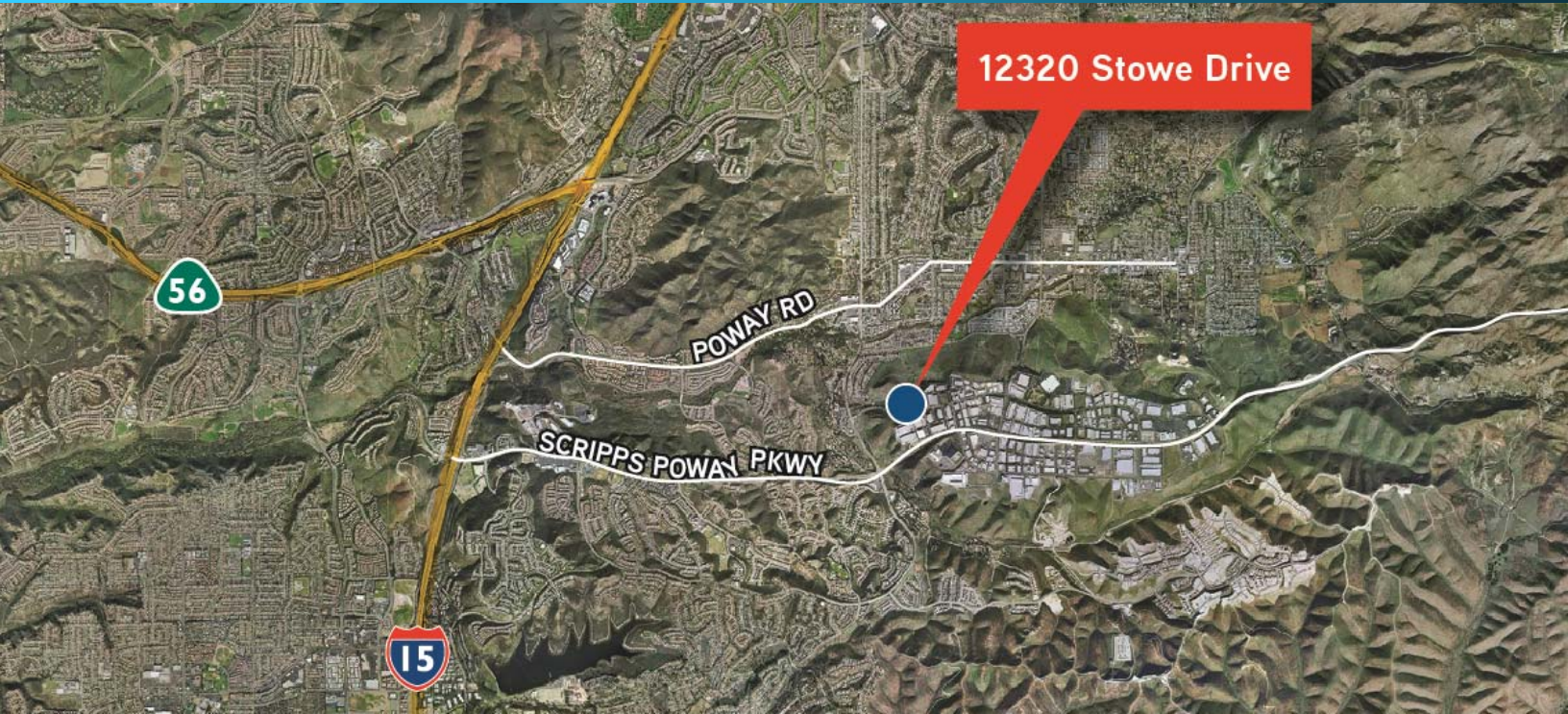

Contact Us

EVAN MCDONALD
858 677 5339
evan.mcdonald@colliers.com
Lic. No. 01813359

MIKE BENCH
858 677 5317
mike.bench@colliers.com
Lic. No. 01887495

COLLIERS INTERNATIONAL
4660 La Jolla Village Drive, Suite 100
San Diego, CA 92122
www.colliers.com/sandiego

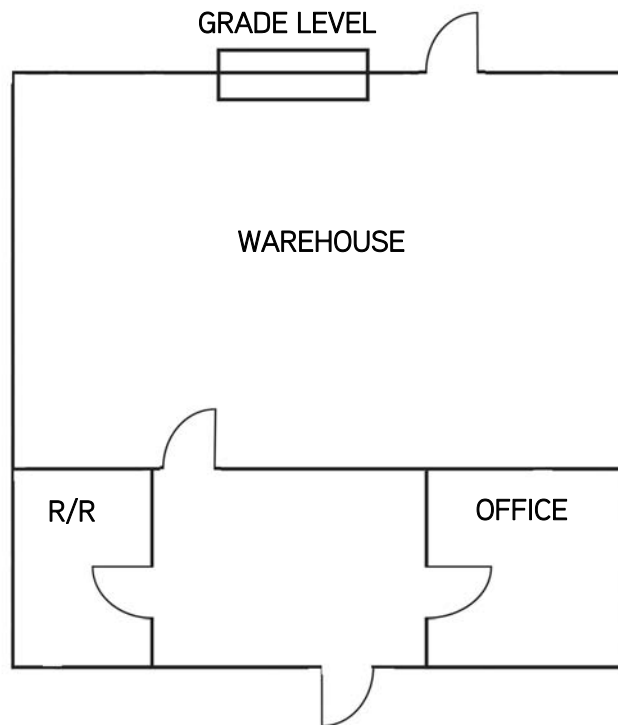

This document has been prepared by Colliers International for advertising and general information only. Colliers International makes no guarantees, representations or warranties of any kind, expressed or implied, regarding the information including, but not limited to, warranties of content, accuracy and reliability. Any interested party should undertake their own inquiries as to the accuracy of the information. Colliers International excludes unequivocally all inferred or implied terms, conditions and warranties arising out of this document and excludes all liability for loss and damages arising therefrom. Colliers International is a worldwide affiliation of independently owned and operated companies.

