

# ART CITY

79 West 900 North, Springville, Utah



# FOR LEASE

\$13.75\* PSF Full Service

\*Call for Executive Office Pricing

## PROPERTY FEATURES

- Suite A - 2,802 SF  
- Suite A Offers Individual Executive Suites
- Suite B - LEASED
- Suite C - LEASED
- Suite D - LEASED
- Main Level Professional Suites
- Just off of State Street
- Local amenities and services
- Unique suites for various office needs

FOR MORE  
INFORMATION  
CONTACT

**PRESTON DAVIS, MBA**  
801.787.5661  
preston.davis@ngkf.com

**AARON COOK**  
801.787.7255  
aaron@coreutah.com



376 East 400 South, Suite 120 | Salt Lake City, Utah 84111  
801.578.5555 | [www.ngacres.com](http://www.ngacres.com)

This document has been prepared by Newmark Knight Frank for advertising and general information purposes only. While the information contained herein has been obtained from what are believed to be reliable sources, the same has not been verified for accuracy or completeness. Newmark Knight Frank accepts no responsibility or liability for the information contained in this document. Any interested party should conduct an independent investigation to verify the information contained herein.

# ART CITY

79 West 900 North, Springville, Utah

## SUITE A – 2,802 SF EXECUTIVE SUITES



## SUITE B – 2,388 SF

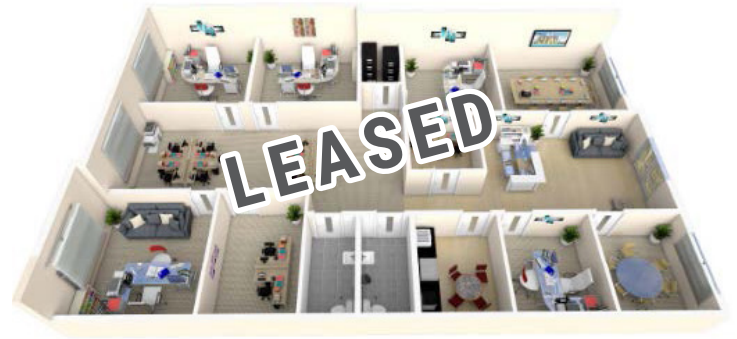

## SUITE C – 2,397 SF



## SUITE D – 1,948 SF





# ART CITY

79 West 900 North, Springville, Utah



376 East 400 South, Suite 120 | Salt Lake City, Utah 84111  
801.578.5555 | [www.ngacres.com](http://www.ngacres.com)

This document has been prepared by Newmark Knight Frank for advertising and general information purposes only. While the information contained herein has been obtained from what are believed to be reliable sources, the same has not been verified for accuracy or completeness. Newmark Knight Frank accepts no responsibility or liability for the information contained in this document. Any interested party should conduct an independent investigation to verify the information contained herein.



# ART CITY

79 West 900 North, Springville, Utah



Exit #261  
1400 North

15

15

Exit #260  
400 South

**SITE**

**MAVERIK**  
BW | Best Western  
Hotels & Resorts  
FLYING J

**SUBWAY**  
Bank of America Fork  
**O'Reilly AUTO PARTS**

**Chevron**  
**Yogurtland**  
**Sodolicious**  
**McDonald's**

**DAYLIGHT DONUTS**  
EXPRESSO  
**JAVA JUNKIE**

The most pie bakery  
**AutoZone**  
Utah Community  
**SONIC** **Beto's**  
America's Drive-In  
**TIRE PROS**  
**NEBCU** **zubs**

**Walmart** **DESERT INDUSTRIES**  
**AMERICA FIRST** **DEL TACO**  
**ihop** **PIZZA NAPA JOINS**  
**BIG TIRES** **Wendy's**  
**Pizza Hut** **Arby's** **WIGGY WASH**  
**SECURITY SERVICE** **OrangePeel**  
**STRAP TANK BREWERY** **jiffylube**

**MAVERIK** **7-ELEVEN** **Sinclair** **TACO BELL**  
**Art City** **TWO JACK'S PIZZA**

**WELLS FARGO** **Madeby's FRESH**  
**PIER 49 PIZZA** **CENTRAL**  
**hagi yogi** **Chevron**  
**Walgreens**  
**Little Caesars**  
**NAPA AUTO PARTS**

**Smith's Marketplace** **Starbucks** **Domino's Pizza**  
**Beans & Brews**  
**Safe Rio MEXICAN GRILL** **tropical CAFE**  
**Quick Quack CAR WASH** **Sodolicious**  
**Advance! Auto Parts** **ZIONS BANK**