

Jewel-Osco Owned Outlot Available

# OUTLOT AVAILABLE

NEC 159th St & 94th Ave, Orland Park, IL

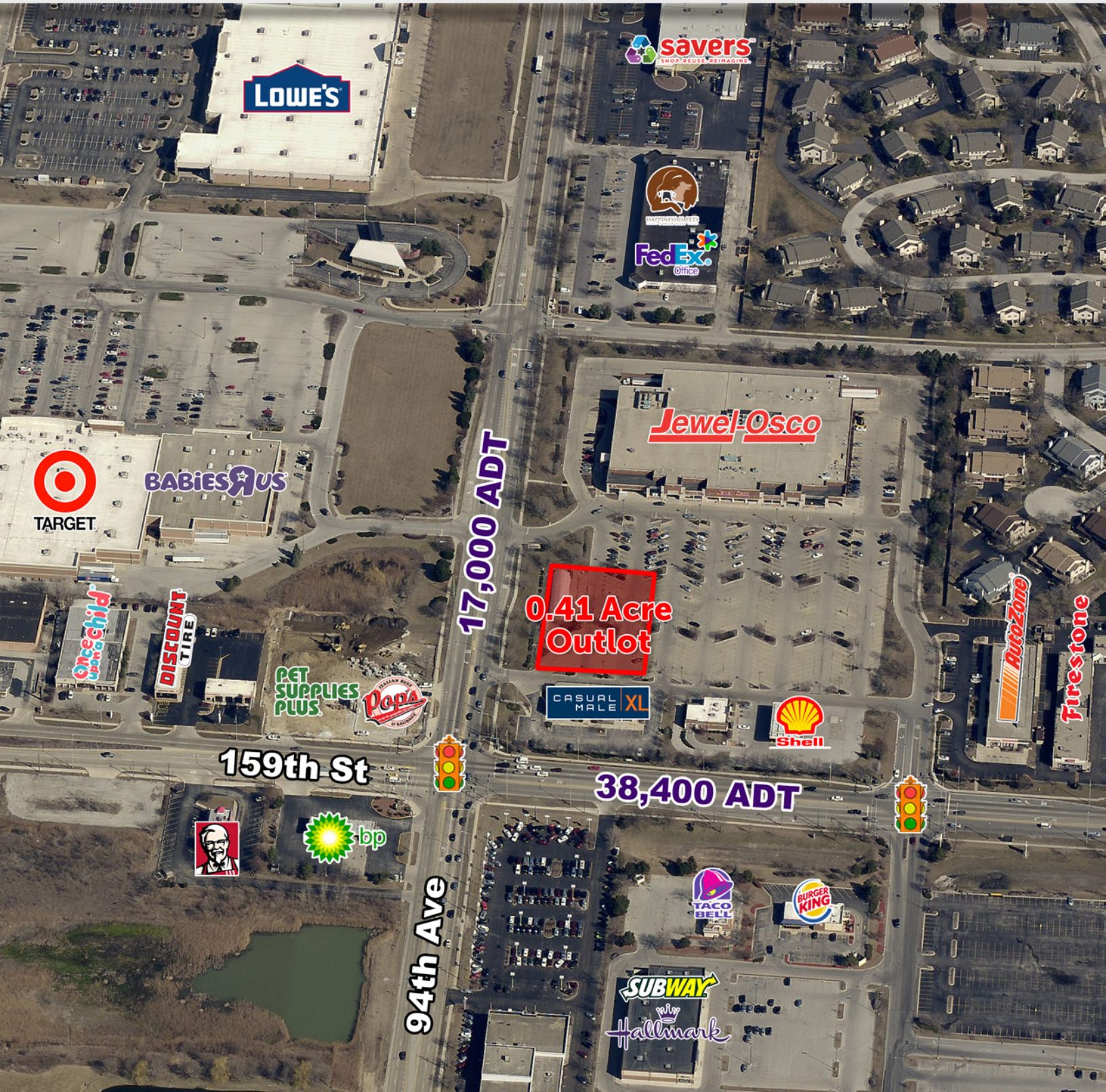





# Outlot Available

NEC 159th St & 94th Ave, Orland Park, IL



Location Summary

This property is strategically located at the heavily trafficked intersection of 159th Avenue (38,400 ADT) & 94th Ave (17,000 ADT).

This outlot is directly in front of Jewel Osco and is highly visible and easily accessible via several curb cuts.

Area retailers include Lowes, Target, JC Penney, HHGregg, Kohls, Cost Plus World Market, Sports Authority and Walmart.



Site Information

<b>Land Available</b>	Approximately 0.41 Acres	
<b>Population Density</b>	10,925	1 Mile Radius
	80,251	3 Mile Radius
	173,847	5 Mile Radius
<b>Average Household Income</b>	\$74,901	1 Mile Radius
	\$91,466	3 Mile Radius
	\$92,750	5 Mile Radius



Contact

**Matt Cavanagh**  
e: [matt@arcgrp.com](mailto:matt@arcgrp.com) p: (630) 908-5694

**Andy Robbins**  
e: [arobbins@arcgrp.com](mailto:arobbins@arcgrp.com) p: (630) 908-5707

**Courtney Darin**  
e: [courtney@arcgrp.com](mailto:courtney@arcgrp.com) p: (630) 908-5691

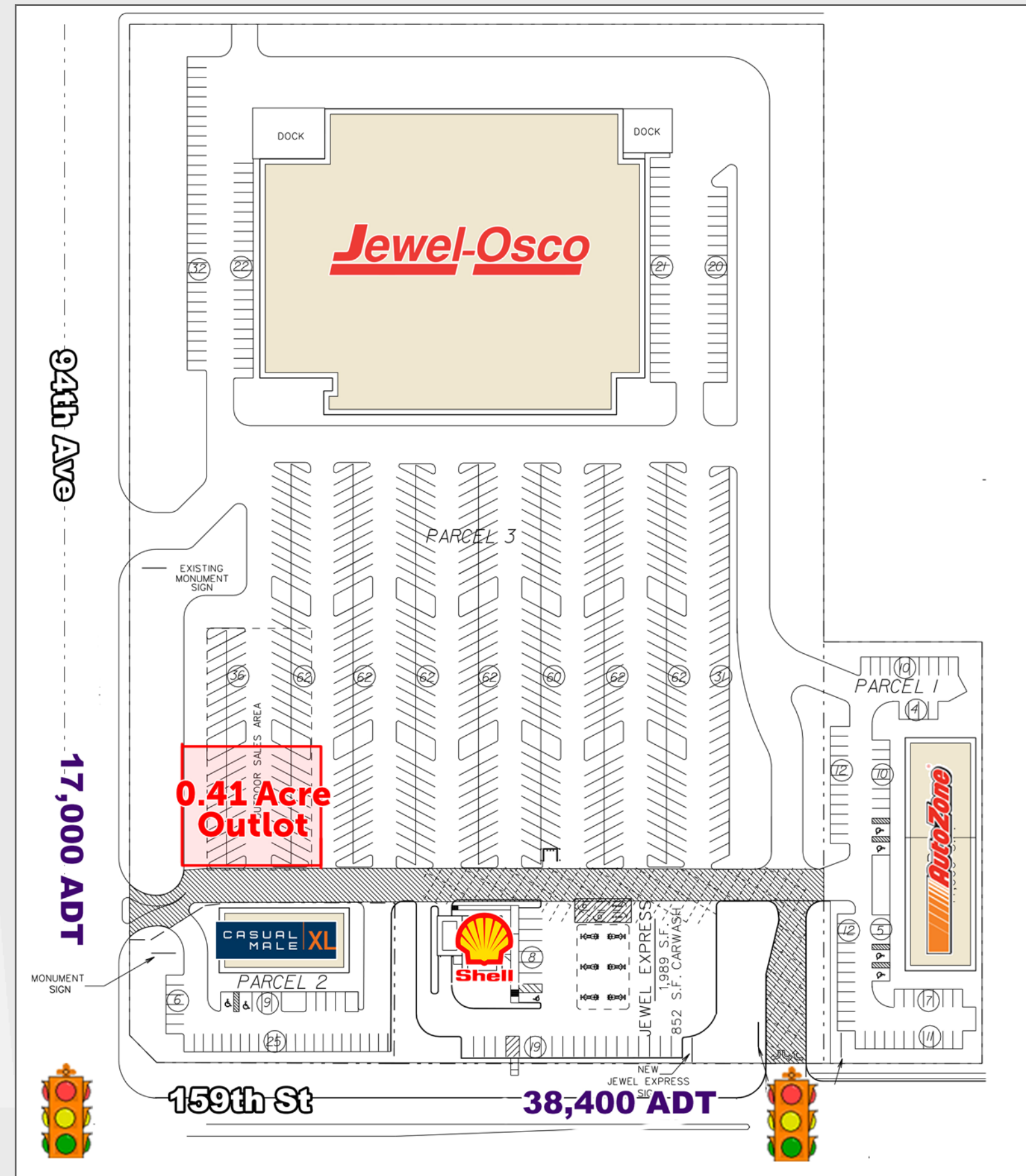





JEWEL-OSCO OWNED OUTLOT AVAILABLE

# Outlot Available

NEC 159th St & 94th Ave, Orland Park, IL

AERIAL

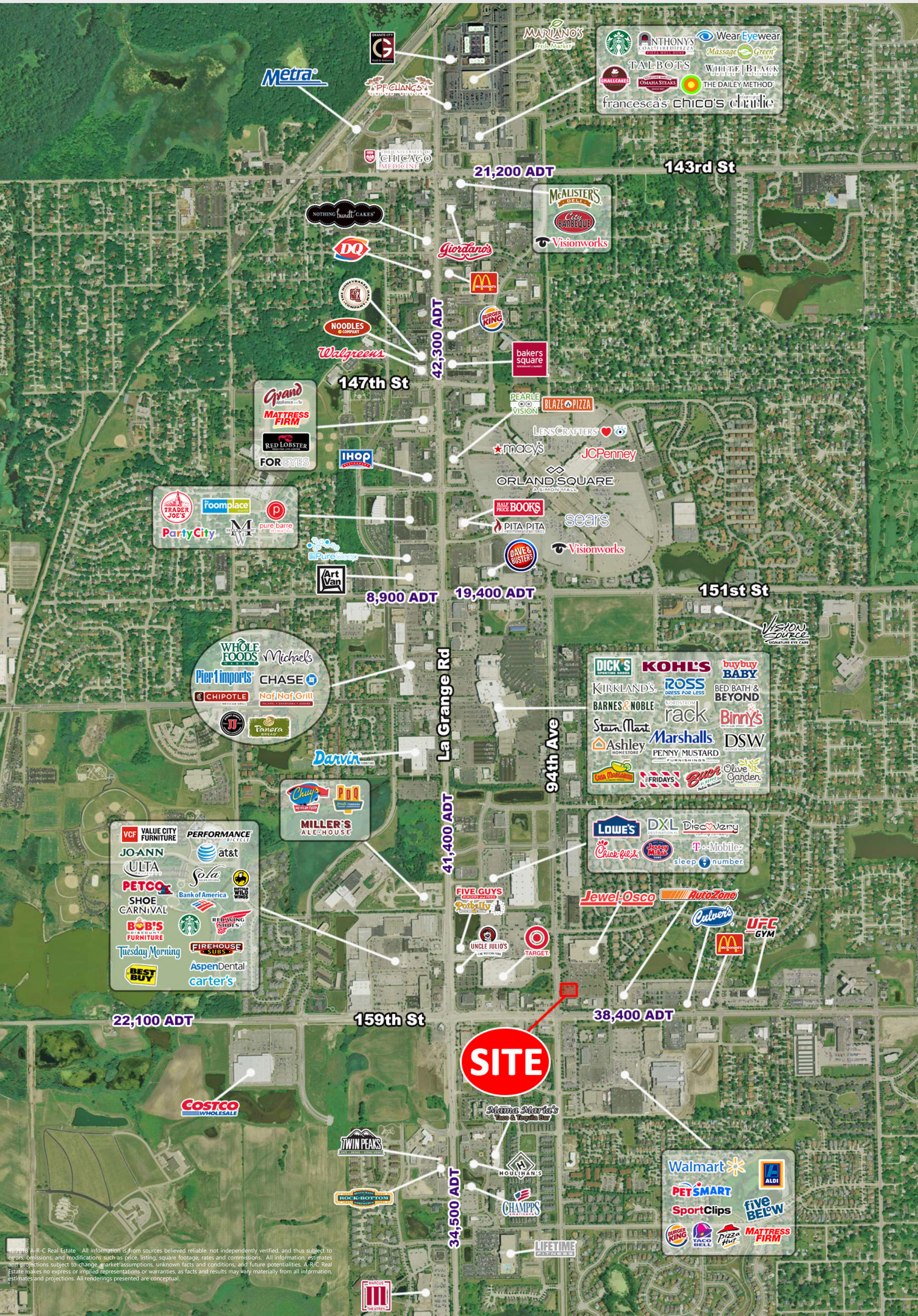

© 2018 A-R-C Real Estate. All information is from sources believed reliable, not independently verified, and thus subject to errors, omissions, and modifications such as price, listing, square footage, rates and commissions. All information, estimates and projections subject to change, market assumptions, unknown facts and conditions, and future potentialities. A-R-C Real Estate makes no express or implied representations or warranties, as facts and results may vary materially from all information, estimates and projections. All renderings presented are conceptual.