



Industrial For Sale

Property Name:

Location: 8820 Lyndon Street

City, State: Detroit, MI

Cross Streets: Kentucky St.

County: Wayne

Zoning: M-2

BUILDING SIZE / AVAILABILITY

Building Type:	Built	Mezzanine:	N/A
Total Building Sq. Ft.:	12,600	Available Shop Sq. Ft.:	11,800
Available Sq. Ft.:	12,600	Available Office Sq. Ft.:	800
		Office Dim:	N/A
		Shop Dim:	N/A

PROPERTY INFORMATION

Freestanding:	Yes	Year Built:	1946
Clear Height:	19' - 25'	Rail:	No
Grade Level Door(s):	2: 12 x 6	Security:	No
Truckwells or Docks:	0	Interior:	N/A
Exterior Construction:	Block	Lighting:	LED
Structural System:	Steel	Bay Sizes:	N/A
Air-Conditioning:	Office	Restrooms:	3
Heating:	Gas	Cranes:	Yes, (1) 3-Ton & (2) 5-Ton
Availability:	30 Days	Parking:	N/A
Power (Amps/Volts):	400 Amps, 220 Volts, 3-Phase		
		Roof:	Rubber
		Floors:	N/A
		Floor Drains:	No
		Acres:	0.330
		Land Dimensions:	144 x 100

PRICING INFORMATION

Sale Price:	\$495,000	Deposit:	N/A	TD:	N/A
Taxes:	\$2,589.55 (2019/20)	Options:	N/A	Assessor #:	N/A
Parcel #:	16005910-4				

COMMENTS

Good auto repair, manufacturing building. Cranes/power.

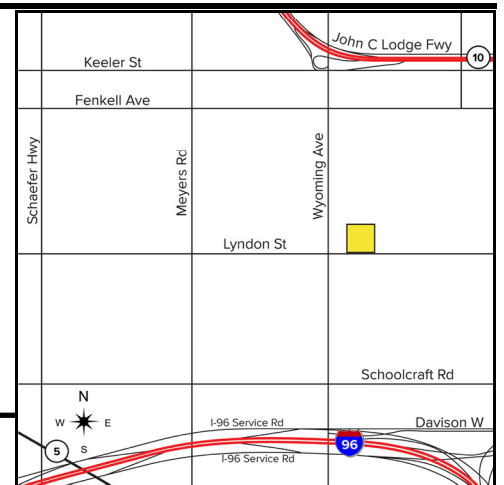

Broker: SIGNATURE ASSOCIATES

Agent(s):

Chris Monsour, (248) 948-0107, cmonsour@signatureassociates.com

Peter Vanderkaay, (248) 359-3837, pvanderkaay@signatureassociates.com