



FOR SALE OR LEASE

# Conestoga Wood

600 North Industrial Loop Road / Tooele, Utah



FOR SALE OR LEASE

# Conestoga Wood

600 North Industrial Loop Road / Tooele, Utah



114,750 SF TOTAL

## 114,750 square feet on 20 acres in the Utah Industrial Depot, Manufacturing Building, Heavy Power.

### Property Highlights

- Size: Office area: 10,300 SF  
Shop area: 104,450 SF  
Total: 114,750 SF
- Clear Height: 21'-25'
- Doors: 5 Dock high doors  
7 Ground level doors
- Power: 8,000 amps, 480/277 volts, 3 phase
- Column Spacing: 50' x 50'
- Cranes: 3 - one and a half (1.5) ton bridge cranes  
2 - two (2) ton bridge cranes
- Lighting: 6 lamp T-5, 277 volt
- Floor: 6 inch
- Compressed air
- **Sales Price: \$10,000,000**
- **Lease Rate: \$0.58 NNN**



**Mike Farmer, SIOR**  
Executive Director  
+1 801 303 5422  
mike.farmer@cushwake.com

**Rick Newton**  
Director  
+1 801 303 5485  
rick.newton@cushwake.com

**Philip Eilers**  
Associate  
+1 801 303 5426  
phillip.eilers@cushwake.com

**Jon Schreck**  
Associate  
+1 801 303 5531  
jon.schreck@cushwake.com

170 South Main Street,  
Suite 1600  
Salt Lake City, UT 84101  
Main +1 801 322 2000  
Fax +1 801 322 2040  
**cushmanwakefield.com**

**Mike Farmer, SIOR**  
Executive Director  
+1 801 303 5422  
mike.farmer@cushwake.com

**Rick Newton**  
Director  
+1 801 303 5485  
rick.newton@cushwake.com

**Philip Eilers**  
Associate  
+1 801 303 5426  
phillip.eilers@cushwake.com

**Jon Schreck**  
Associate  
+1 801 303 5531  
jon.schreck@cushwake.com

170 South Main Street,  
Suite 1600  
Salt Lake City, UT 84101  
Main +1 801 322 2000  
Fax +1 801 322 2040  
**cushmanwakefield.com**

**Floor Plan**

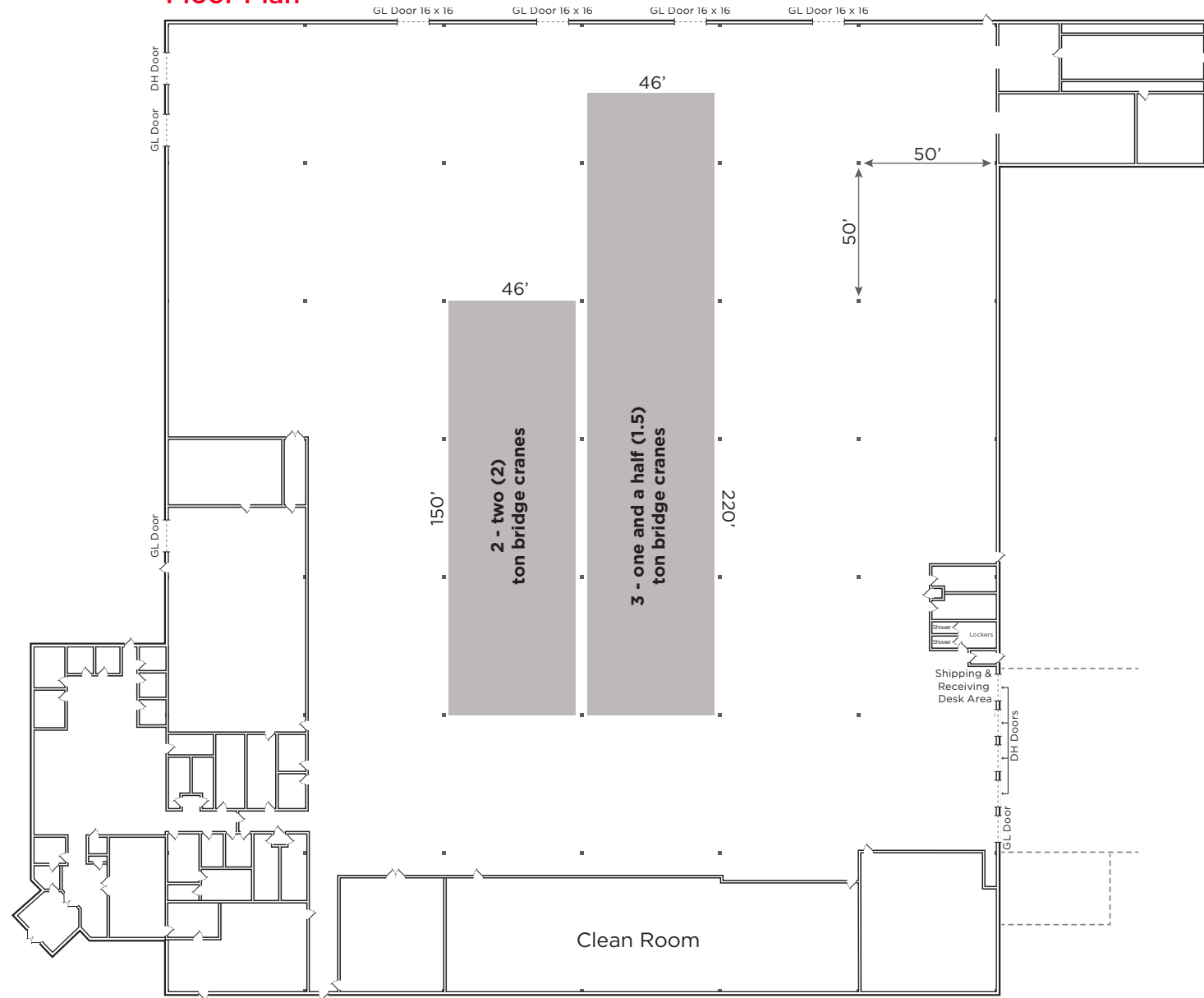

**Interior Photos**

