



Windermere Pkwy & Buford Hwy

Cumming, Georgia 30041

Property Highlights

- Two Parcels Totaling 24.826 Acres
0.981 Acres (APN 203 396)
23.845 Acres (APN 203 001)
- All Utilities Available
- Zoned CBD, Unincorporated Forsyth County ([Click here for CBD Zoning from County](#))
- Buford Hwy Overlay District ([Click here for Overlay Details](#))
- Multiple Access Points via Curb Cuts on Hwy 20 & Windermere Pkwy
- \$141,078 Avg HH Income in 1-Mile Radius
- 30,000 VPD on Buford Hwy (Hwy 20); 15,500 VPD on Windermere Pkwy
- Exclusively listed by Todd Ellis/NAI Brannen Goddard, LLC
- \$4,000,000 Asking Price

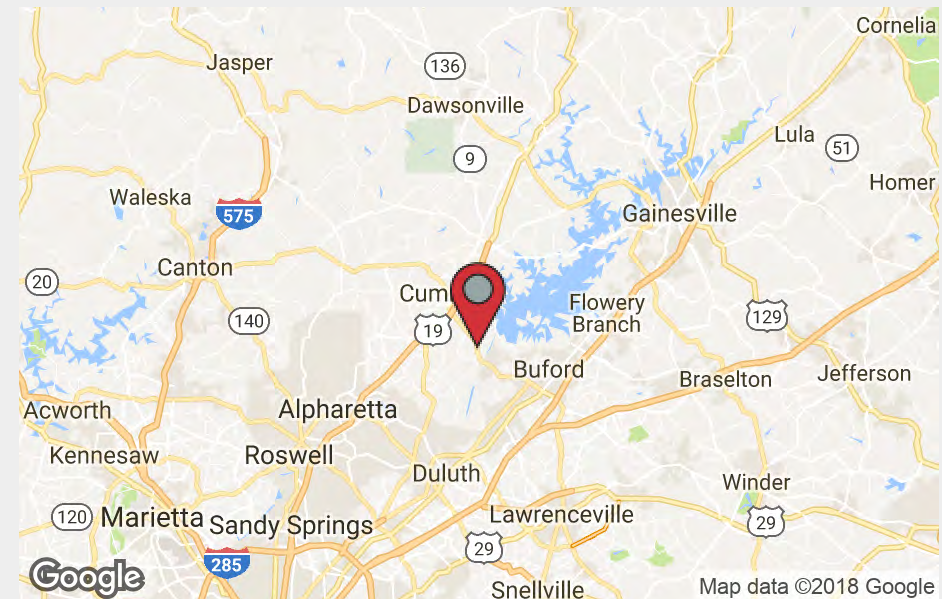

Exclusively listed by:

Todd Ellis

tellis@naibg.com

404.812.4009

INFORMATION IS DEEMED FROM RELIABLE SOURCES. NO WARRANTY IS MADE AS TO ITS ACCURACY.

NAI Brannen Goddard
5555 Glenridge Connector, Suite 1100
Atlanta, GA 30342

404 812 4000

naibg.com

Subject Property

±25 Acres for Sale

Windermere Pkwy & Buford Hwy



Area Amenities

±25 Acres for Sale

Windermere Pkwy & Buford Hwy

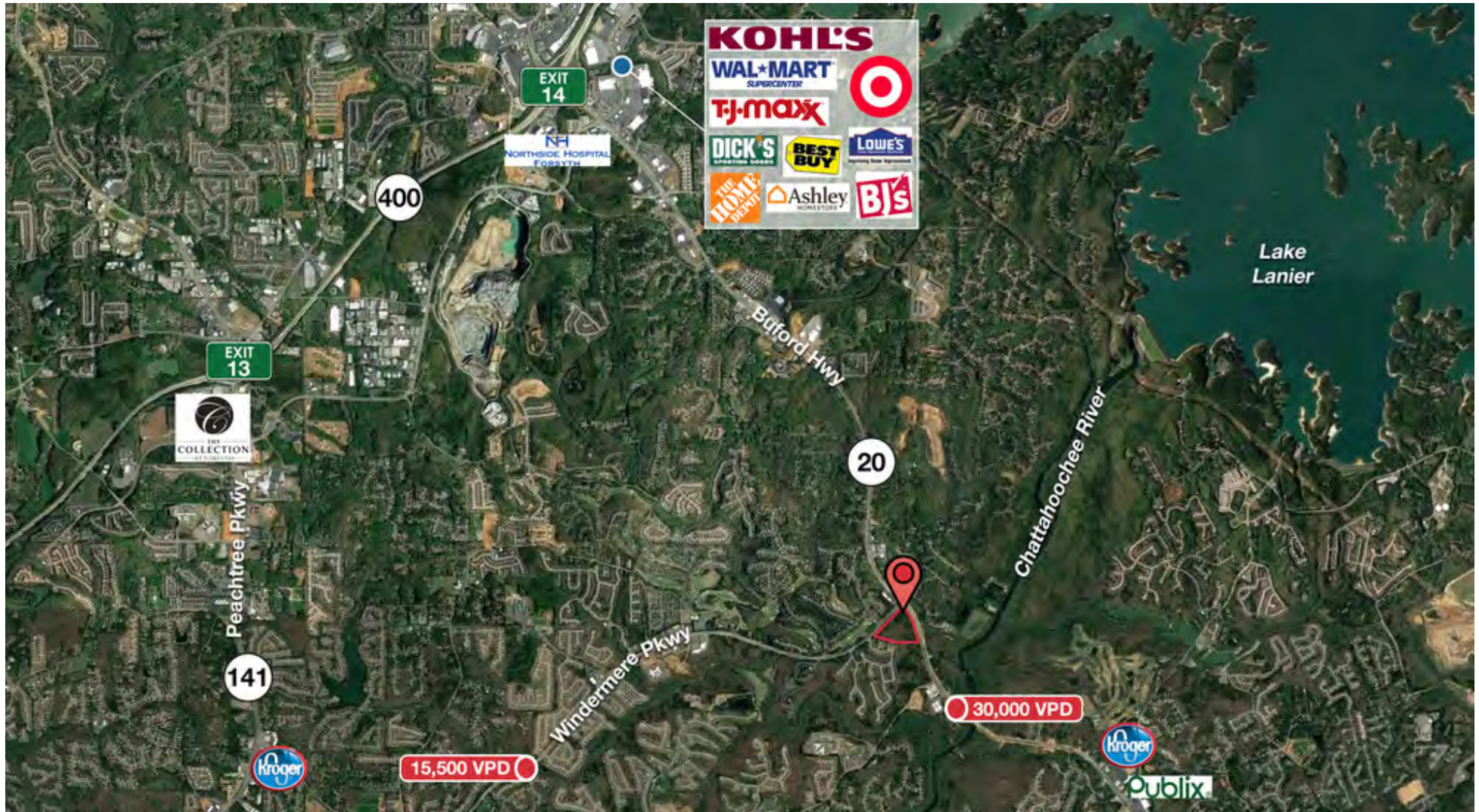

Site
Plan

±25 Acres for Sale

Windermere Pkwy & Buford Hwy



Conceptual Plan

±25 Acres for Sale

Windermere Pkwy & Buford Hwy

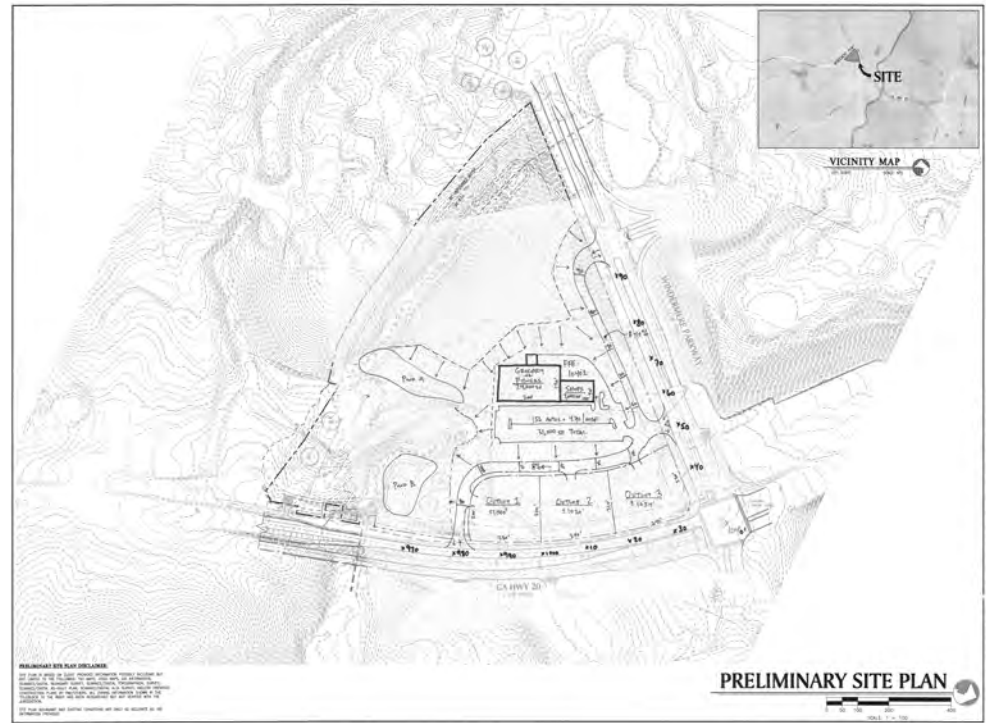
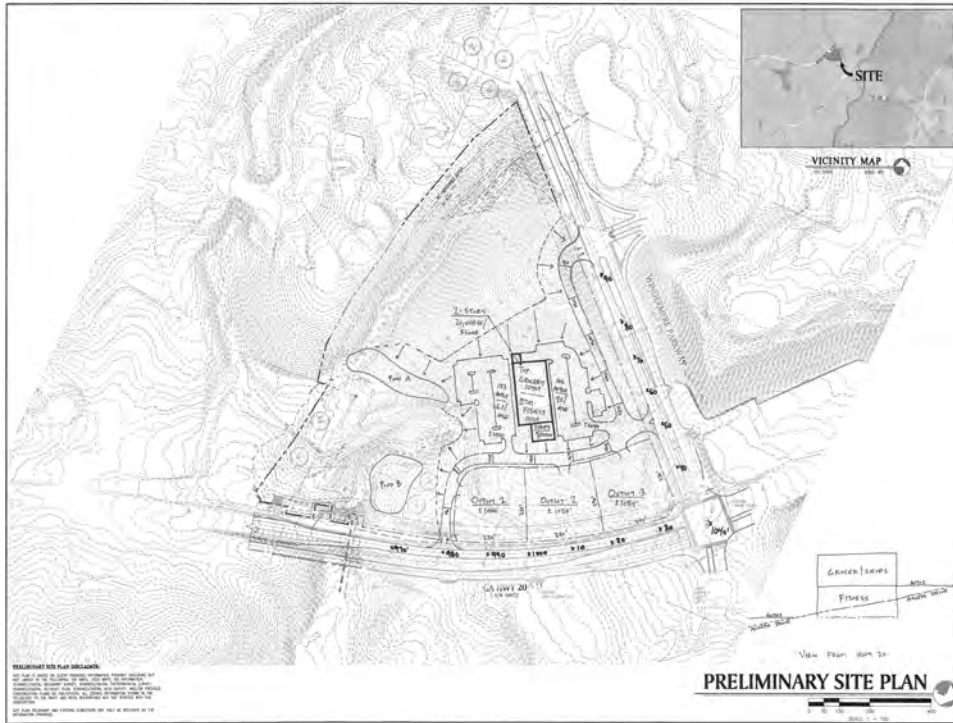

Demographics Overview

±25 Acres for Sale

Windermere Pkwy & Buford Hwy

Population	1 Mile	3 Miles	5 Miles
TOTAL POPULATION	4,479	45,761	117,059
MEDIAN AGE	36.1	36.6	37.8
MEDIAN AGE (MALE)	36.7	36.0	36.1
MEDIAN AGE (FEMALE)	35.5	36.3	37.1

Housholds & Income	1 Mile	3 Miles	5 Miles
TOTAL HOUSEHOLDS #	1,450	14,441	38,403
OF PERSONS PER HH	3.09	3.17	3.04
AVERAGE HH INCOME	\$174,785	\$156,425	\$140,477
AVERAGE HOUSE VALUE	\$479,367	\$367,285	\$338,424

