

# PERRIS COMMERCE CENTER

DEVELOPED BY: 

FOR SALE/LEASE 4 BUILDINGS TOTALING ±61,720 SF



Please Contact:

 **LEE & ASSOCIATES**  
COMMERCIAL REAL ESTATE SERVICES

**R. MARIO CALVILLO**  
BRE#: 01911573 | 951.276.3657  
MCALVILLO@LEERIVERSIDE.COM

**SCOTT STEWART**  
BRE#: 01048055 | 951.445.4514  
SSTEWART@LEETEMECULA.COM

**GARRY JENKINS**  
BRE#: 02008115 | 951.276.3621  
GJENKINS@LEERIVERSIDE.COM

No warranty or representation has been made to the accuracy of the foregoing information. Terms of sale or lease and availability are subject to change or withdrawal without notice. Lee & Associates Commercial Real Estate Services, Inc. - Riverside. 3240 Mission Inn Avenue, Riverside, CA 92507 | Corporate ID# 01048055

# PERRIS COMMERCE CENTER

FOR SALE/LEASE 4 BUILDINGS TOTALING ±61,720 SF

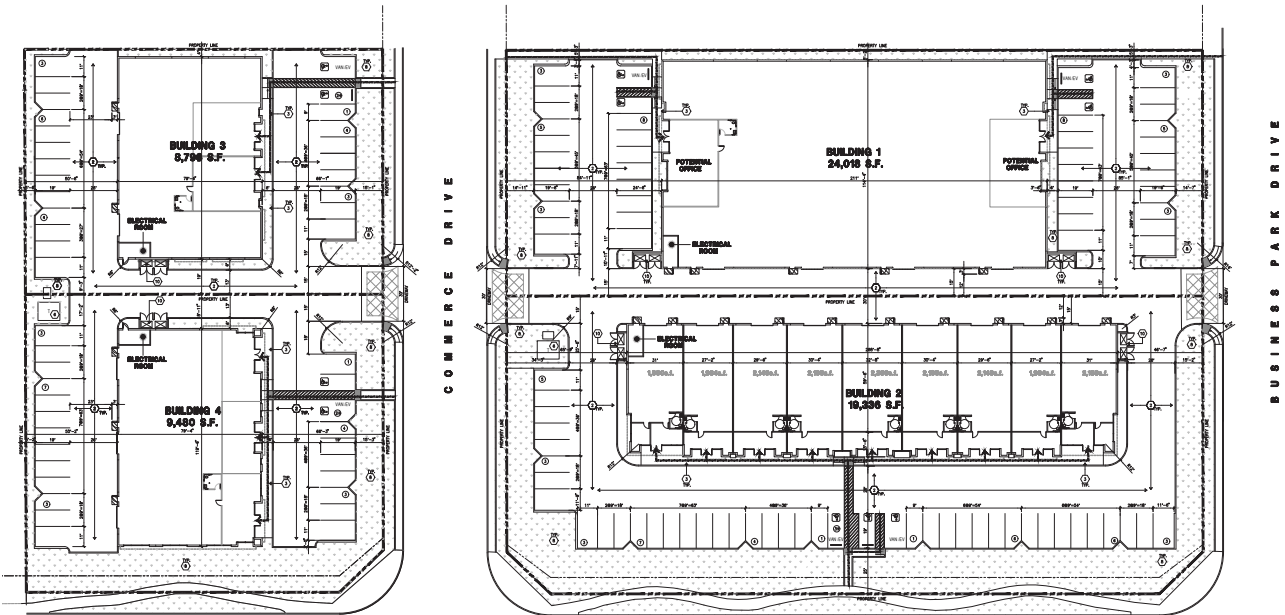

## PROPERTY FEATURES

	BUILDING 1	BUILDING 2	BUILDING 3	BUILDING 4
<b>BUILDING SF</b>	±24,108	±19,336	±8,796	±9,480
<b>Unit SF</b>	±12,054 to 24,108	±1,990 to 19,336	±4,398 to 8,798	±3,106 to 9,480
<b>ACRES</b>	1.22	1.37	0.60	0.73
<b>OFFICE SF</b>	TBD	TBD	TBD	TBD
<b>CLEAR HEIGHT</b>	24'	18'	18'	18'
<b>ESFR SPRINKLERS</b>	K-25	K-25	K-25	K-25
<b>POWER</b>	800 Amps, 3 Phase	200 Amps, 3 Phase Per Unit	200 Amps, 3 Phase Per Unit	200 Amps, 3 Phase Per Unit
<b>ASSOCIATION</b>	Yes	Yes	Yes	Yes

Please Contact:



**R. MARIO CALVILLO**  
BRE#: 01911573 | 951.276.3657  
MCALVILLO@LEERIVERSIDE.COM

**SCOTT STEWART**  
BRE#: 01048055 | 951.445.4514  
SSTEWART@LEETEMECULA.COM

**GARRY JENKINS**  
BRE#: 02008115 | 951.276.3621  
GJENKINS@LEERIVERSIDE.COM

No warranty or representation has been made to the accuracy of the foregoing information. Terms of sale or lease and availability are subject to change or withdrawal without notice. Lee & Associates Commercial Real Estate Services, Inc. - Riverside. 3240 Mission Inn Avenue, Riverside, CA 92507 | Corporate ID# 01048055