

# FOR LEASE

## Tacoma Logistics Center - 917 & 927 East 11th Street, Tacoma, WA

1,109,145 SQUARE FEET TOTAL

[www.tacomalogisticscenter.com](http://www.tacomalogisticscenter.com)



### Building Highlights

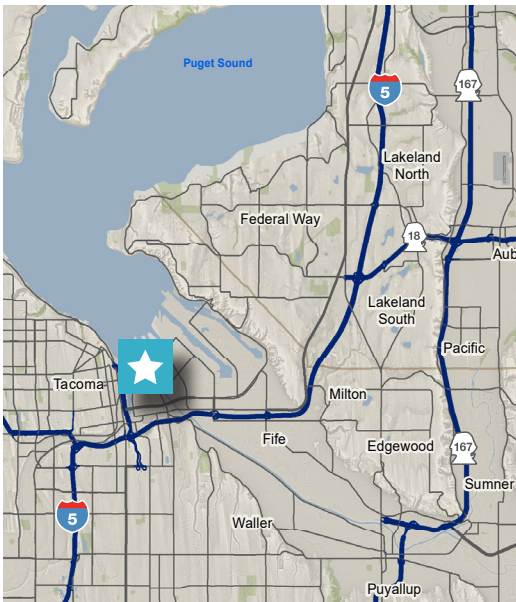

	Total Size (SF)	Available (SF) (Divisible to)	Existing Office (SF)	Clear Height	Dock High Doors	Grade Level Doors	Truck Court Depth
Building A (927 E 11th St)	280,525	280,525 (60,000)	2,446	32'	63	2	310'
Building B (917 E 11th St)	828,620	384,192 (192,096)	4,084	36'	75	2	310'

- Offices to suit
- ESFR sprinkler system
- 58 trailer stalls available
- 705 auto parking spaces
- Concrete truck yard
- Pursuing LEED Certification

- 57.50 acre parcel
- New concrete tilt construction
- Zoning: PMI (Port Maritime & Industrial Districts)
- Available now

Owned by



**BLACK CREEK GROUP**

Leased by



Tony Kusak

+1 206 521 0263 • [tony.kusak@cushwake.com](mailto:tony.kusak@cushwake.com)

# Tacoma Logistics Center - 917 & 927 East 11th Street, Tacoma, WA

1,109,145 SQUARE FEET TOTAL

## Aerial

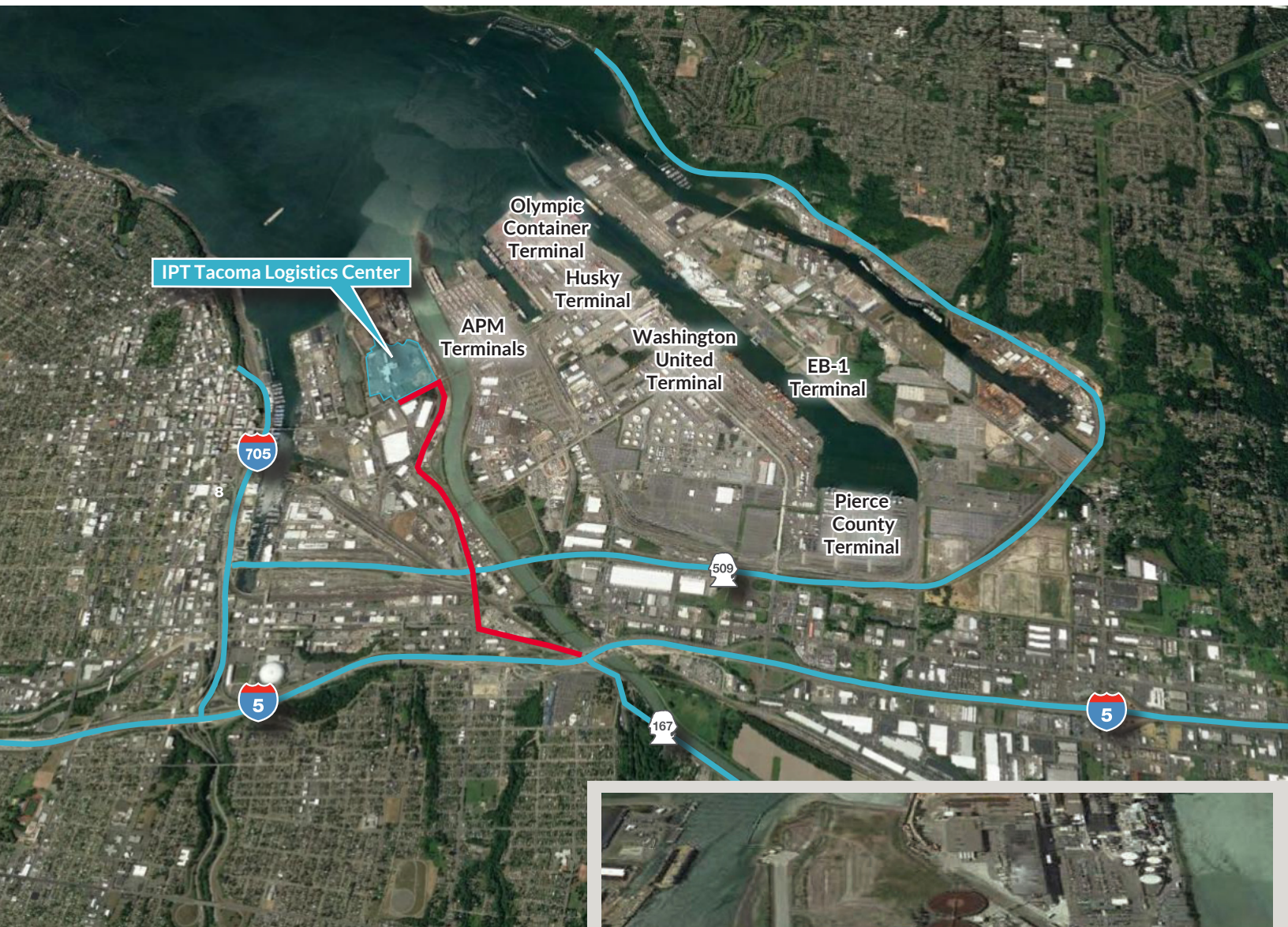

## Drive Distances

- Interstate 5 2.5 miles
- State Route 167 2.8 miles
- Interstate 405 24.5 miles
- Downtown Seattle 34 miles
- Seattle-Tacoma International Airport 26 miles
- Port of Tacoma 3 miles
- Port of Seattle 5 miles

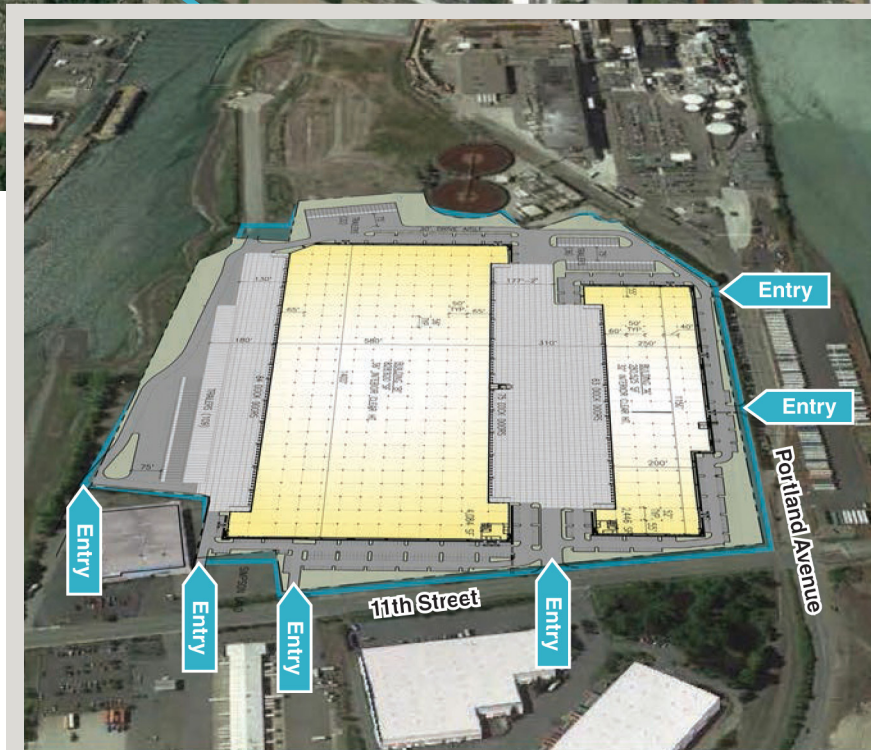

# Tacoma Logistics Center - 917 & 927 East 11th Street, Tacoma, WA

1,109,145 SQUARE FEET TOTAL

## Site Plan

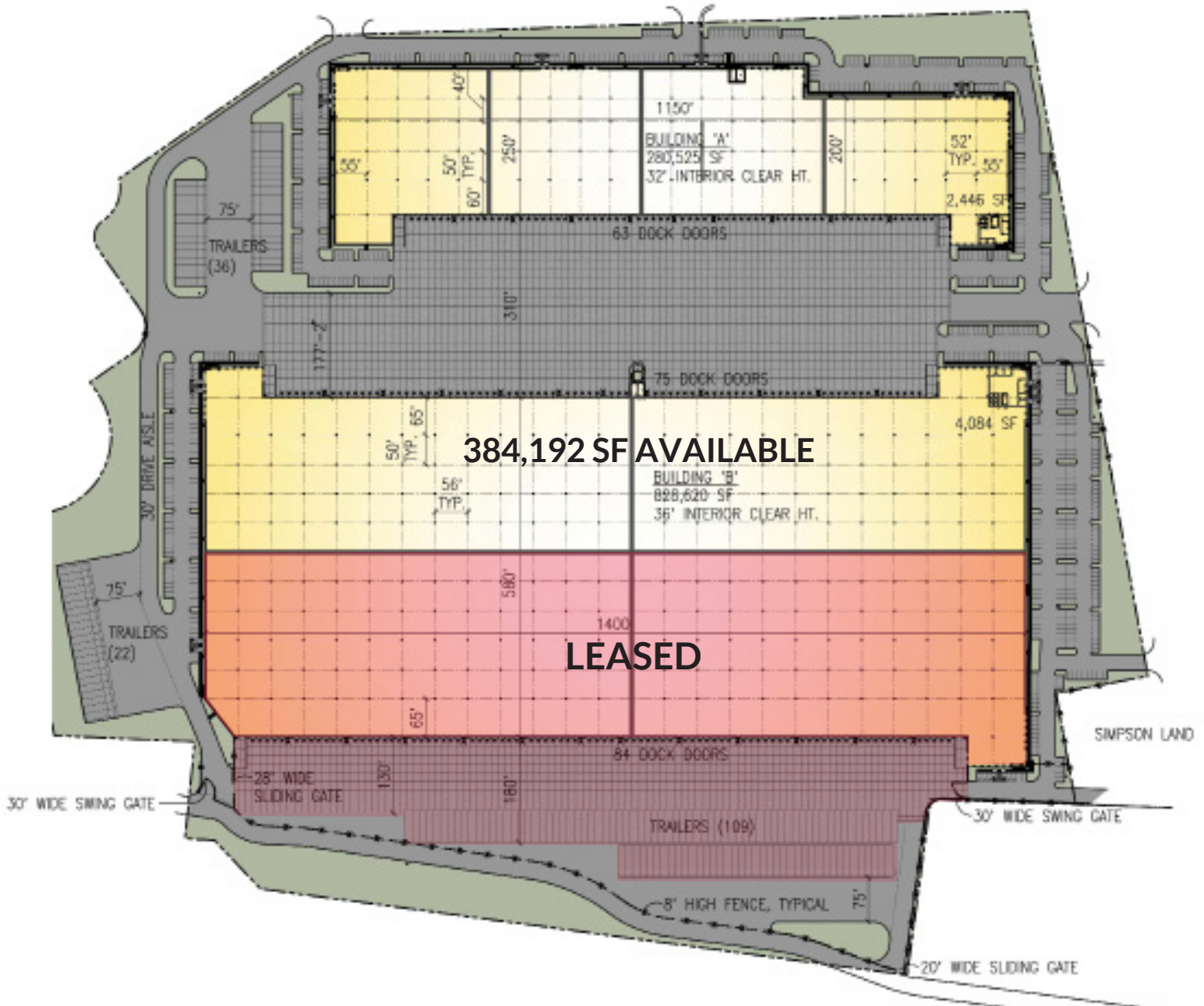

## Location Advantages

- Strategic location in the South Puget Sound industrial market
- Direct access to the Port of Tacoma, the Port of Seattle and the Seattle/Tacoma metro areas
- Within Foreign Trade Zone #86
- Ideal location to draw a competitive and capable labor force
- Excellent location near two parcel hubs, two freight hubs, an intermodal facility, and within 3 miles of the Port of Tacoma