

FLAMINGO PARK OF COMMERCE



PROPERTY INFORMATION:

Address: 1204 Miramar Parkway, Miramar, FL

Space Size: 4,728 sf (100% warehouse)

Features: Space has 2 overhead doors and one restroom.

Rental Rate: \$11.00 sf modified gross

Property Type: Industrial/Manufacturing/Distribution/
Warehouse



Patricia Montalbano, Broker

Dominick Ficarra, Sales Associate

Ph: 954.321.6464

pat@montalbanorealty.com

dominickf@montalbanorealty.com

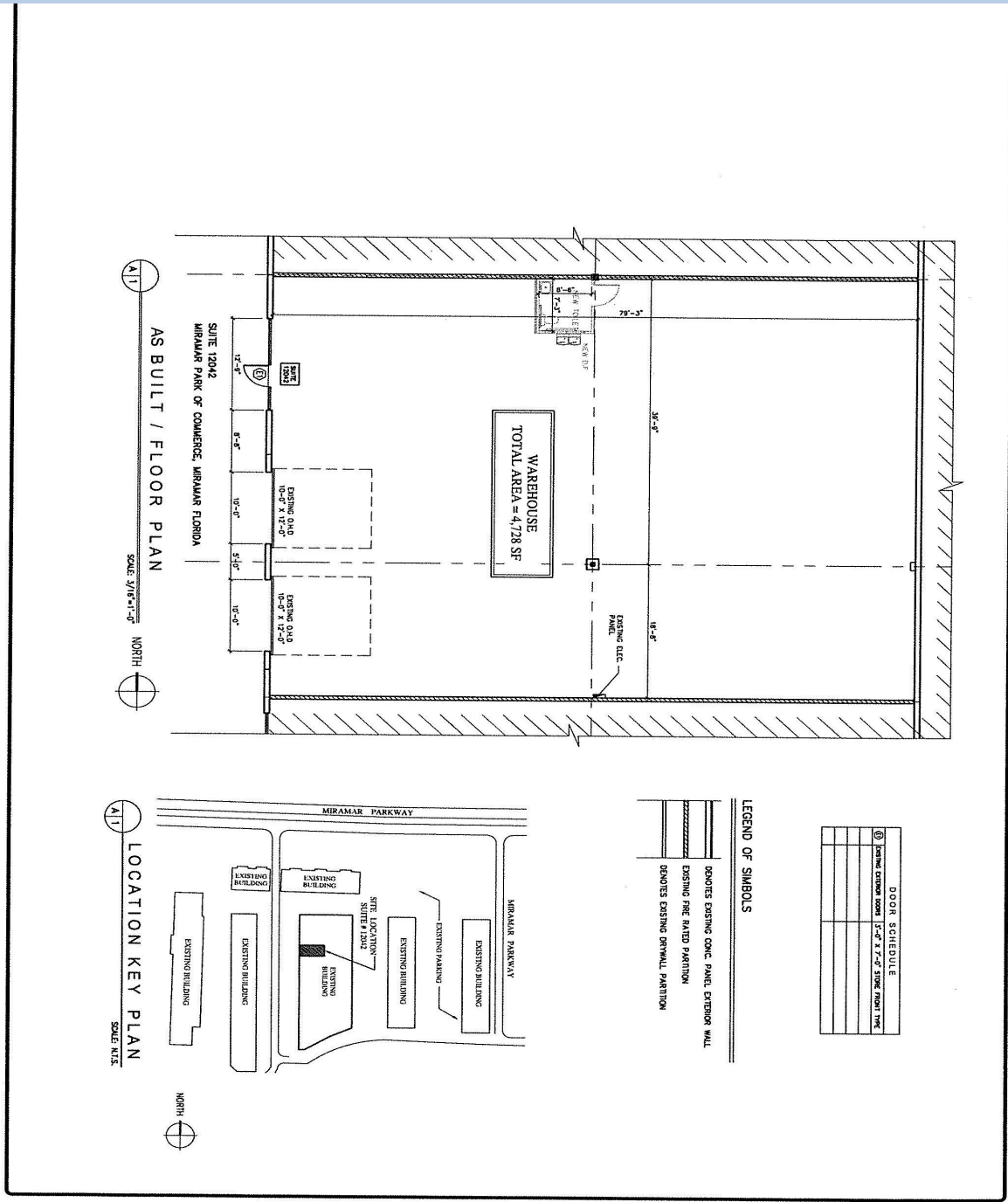

DOOR SCHEDULE

DOOR	TYPE
①	EXISTING CONC. PANEL EXTERIOR WALL
②	EXISTING CONC. PANEL EXTERIOR WALL
③	EXISTING CONC. PANEL EXTERIOR WALL
④	EXISTING CONC. PANEL EXTERIOR WALL

LEGEND OF SYMBOLS

- DENOTES EXISTING CONC. PANEL EXTERIOR WALL
- ▨ DENOTES FIRE RATED PARTITION
- - - - - DENOTES EXISTING DRYWALL PARTITION

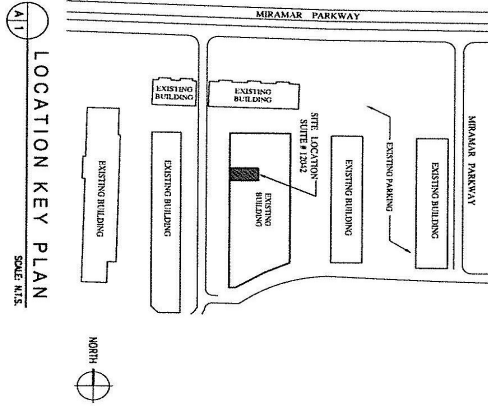

AS BUILT / FLOOR PLAN

SCALE: 3/16"=1'-0"



LOCATION KEY PLAN

SCALE: N.T.S.



SHEET A-1 OF 1	 <p>IRAJ S. SHOJAIE Architect (Lic. # AR 0012560) 240 Commercial Blvd. 2A, Lauderdale By The Sea, FL 33308 Tel: (954) 370 6300 EMAIL: usarchitect@aol.com</p>	<p>AS BUILT FOR: SUITE # 12042</p> <p>12042 FLAMINGO ROAD, MIRAMAR FLORIDA 33025</p>	<p>ALL DRAWINGS, SPECIFICATIONS, CONTRACTS AND PERMITS ARE THE PROPERTY OF MONTALBANO COMMERCIAL REALTY INC. NO PART OF THIS DOCUMENT SHALL BE REPRODUCED, COPIED, STORED IN A RETRIEVING SYSTEM, TRANSMITTED IN ANY FORM OR BY ANY MEANS, OR BE USED IN ANY MANNER WITHOUT THE WRITTEN CONSENT OF MONTALBANO COMMERCIAL REALTY INC. THIS DOCUMENT IS NOT VALID UNLESS SIGNED BY THE ARCHITECT OR ENGINEER AND THE PROFESSIONAL SEAL IS PLACED THEREON. ANY REVISIONS TO THIS DOCUMENT SHALL BE INDICATED BY CIRCLES AND NUMBERS. THE USER OF THIS DOCUMENT SHALL BE RESPONSIBLE FOR VERIFYING THE ACCURACY OF THE INFORMATION CONTAINED HEREIN.</p>	<table border="1"> <tr> <th>DATE</th> <th>REVISION</th> </tr> <tr> <td> </td> <td> </td> </tr> <tr> <td> </td> <td> </td> </tr> </table>	DATE	REVISION				
DATE	REVISION									

For more information, call:
Patricia Montalbano, Broker/Owner
Dominick Ficarra, Sales Associate
Phone: 954-321-6464

