

11225 SE 6TH ST, BELLEVUE, WA 98004

LINCOLN PLAZA

BUILDING C



Sam Ziemba
+1 425 974 4005
sam.ziemba@am.jll.com

Jake Bos
+1 425 974 4086
jake.bos@am.jll.com





Conference room

PROPERTY

HIGHLIGHTS

- + Professionally managed by KG Investments
- + Walking distance to King County Metro Transit Stop at Wilberton Park & Ride and East Main Light Rail Station opening 2023
- + Parking at a ratio of 3.8 | 1,000 USF
- + Free surface parking for visitors
- + On-site showers & lockers

SPACE

HIGHLIGHTS

- + New interior finishes
- + 10 private offices, 3 conference rooms, kitchen, copy/storage & reception
- + Double door lobby exposure
- + New furniture available for purchase
- + Available with 30 days notice
- + Master Lease Expires March 31, 2025
- + Rate of \$33.00/SF/YR NNN



Lobby



Open space



FLOOR PLAN

6,851 RSF

Click to view
Interactive tour

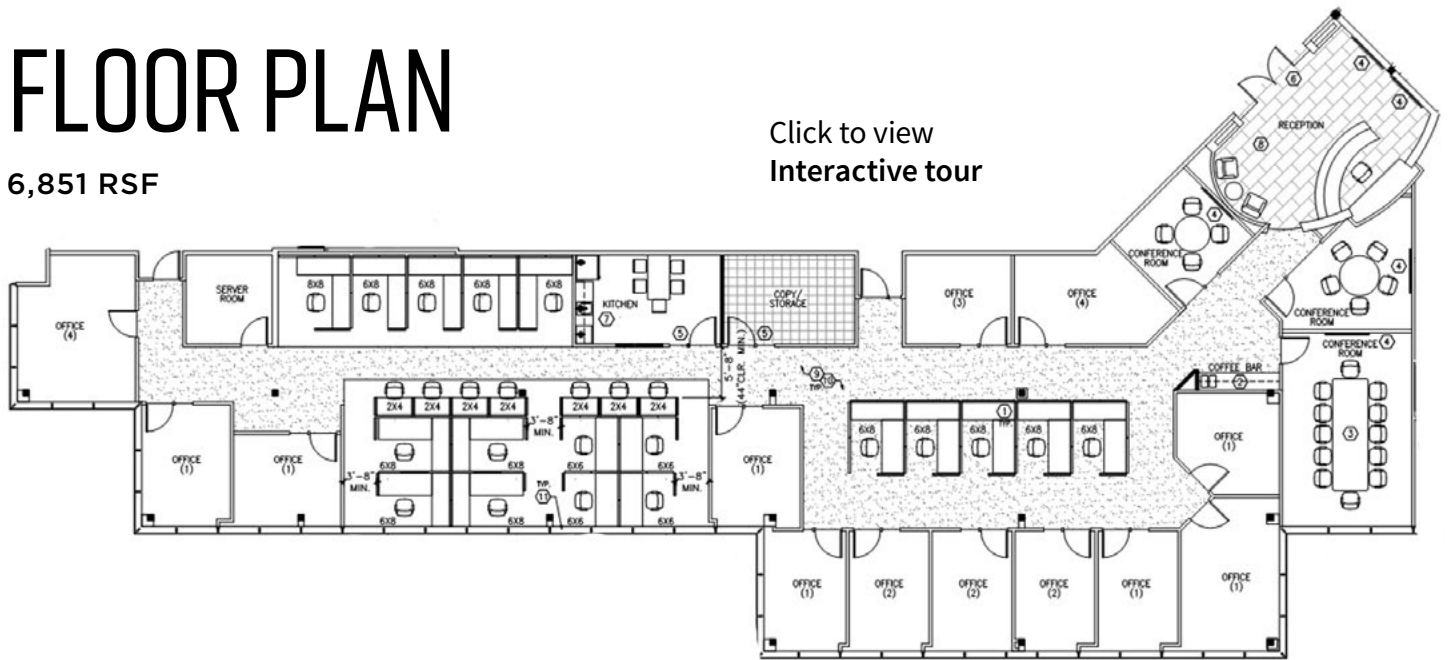

Reception

CONTACT

Sam Ziemba
+1 425 974 4005
sam.ziemba@am.jll.com

Jake Bos
+1 425 974 4086
jake.bos@am.jll.com



DISCLAIMER © 2020 Jones Lang LaSalle IP, Inc. All rights reserved. All information contained herein is from sources deemed reliable; however, no representation or warranty is made to the accuracy thereof. Jones Lang LaSalle Brokerage, Inc.