

# RETAIL SPACE AVAILABLE AT **THE FRANKLIN** | 227 W. MONROE

## PROPERTY

The property is a 2.4 million square foot, Class A office building in the West Loop, located across from Willis Tower and close to the Wacker Drive office building corridor. The Franklin has recently completed a transformational lobby renovation, enhancing tenant and visitor experience with upgraded retail storefronts and curb appeal.

## AVAILABLE RETAIL SPACE

Approximately 4,566 RSF (divisible) for small shop retailers.

## AREA RETAIL TENANTS

Citibank, Soprafina, Starbucks, Sydel & Sydel Jewelry, Townhouse, Chipotle, Caffè RoM, One North Kitchen, T-Mobile, Hannah's Bretzel.

## OFFICE POPULATION

An estimated 7,000 people work in the complex and an estimated 147,000 within a two-block radius.

## WEEKDAY PEDESTRIAN TRAFFIC

An estimated 13,200 people daily on Monroe Street and an estimated 7,100 on Franklin Street.

## RENT

Please inquire.

---

## For more information, please contact

**John Vance** | [jvance@stonerealestate.com](mailto:jvance@stonerealestate.com) | 312.782.1373

**Will Winter** | [wwinter@stonerealestate.com](mailto:wwinter@stonerealestate.com) | 312.878.9445

[thefranklinchicago.com](http://thefranklinchicago.com)



Owned and managed by



TISHMAN SPEYER



**STONE**  
REAL ESTATE

# THE FRANKLIN | 227 W. MONROE

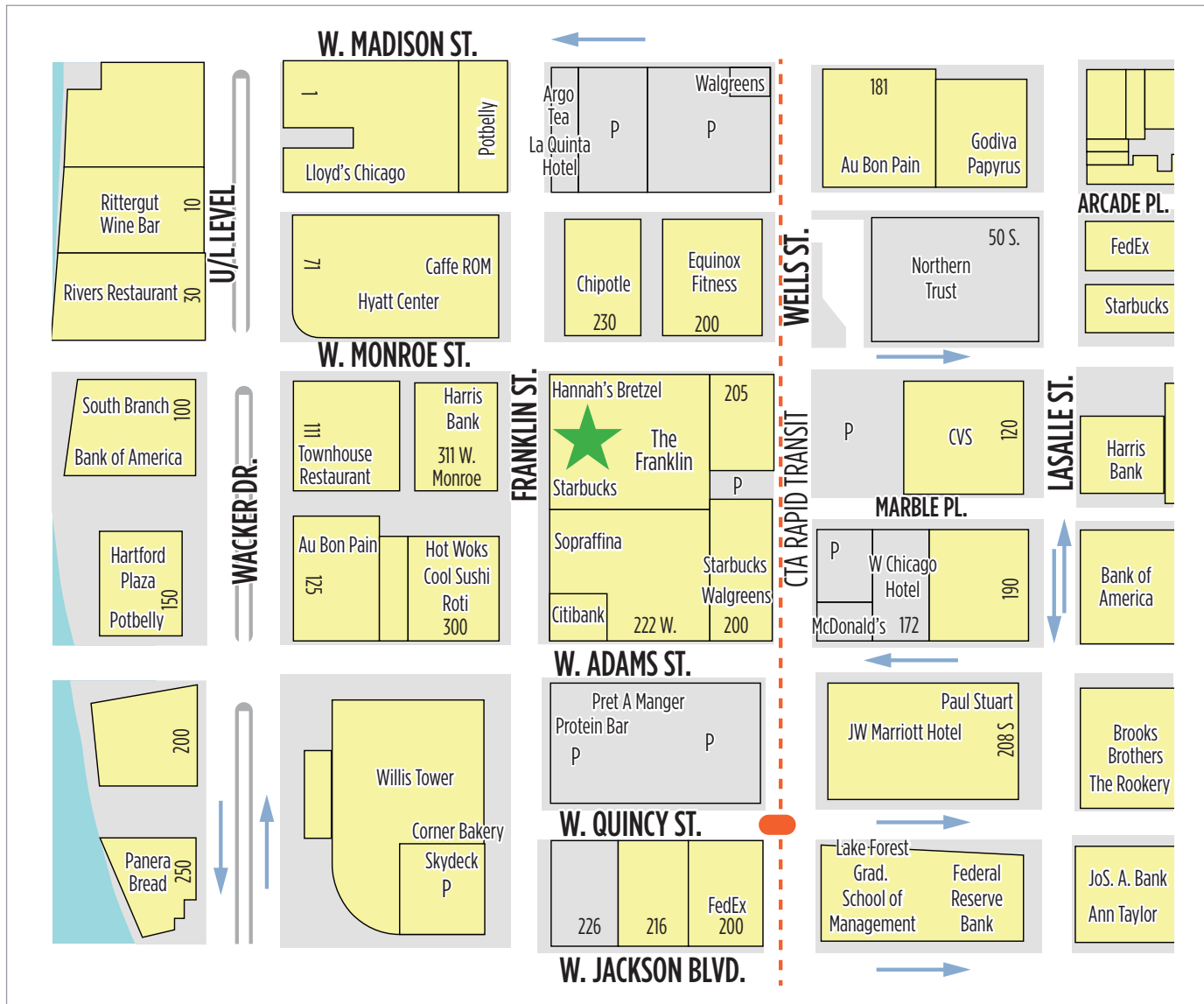

Owned and managed by



TISHMAN SPEYER



# THE FRANKLIN | 227 W. MONROE

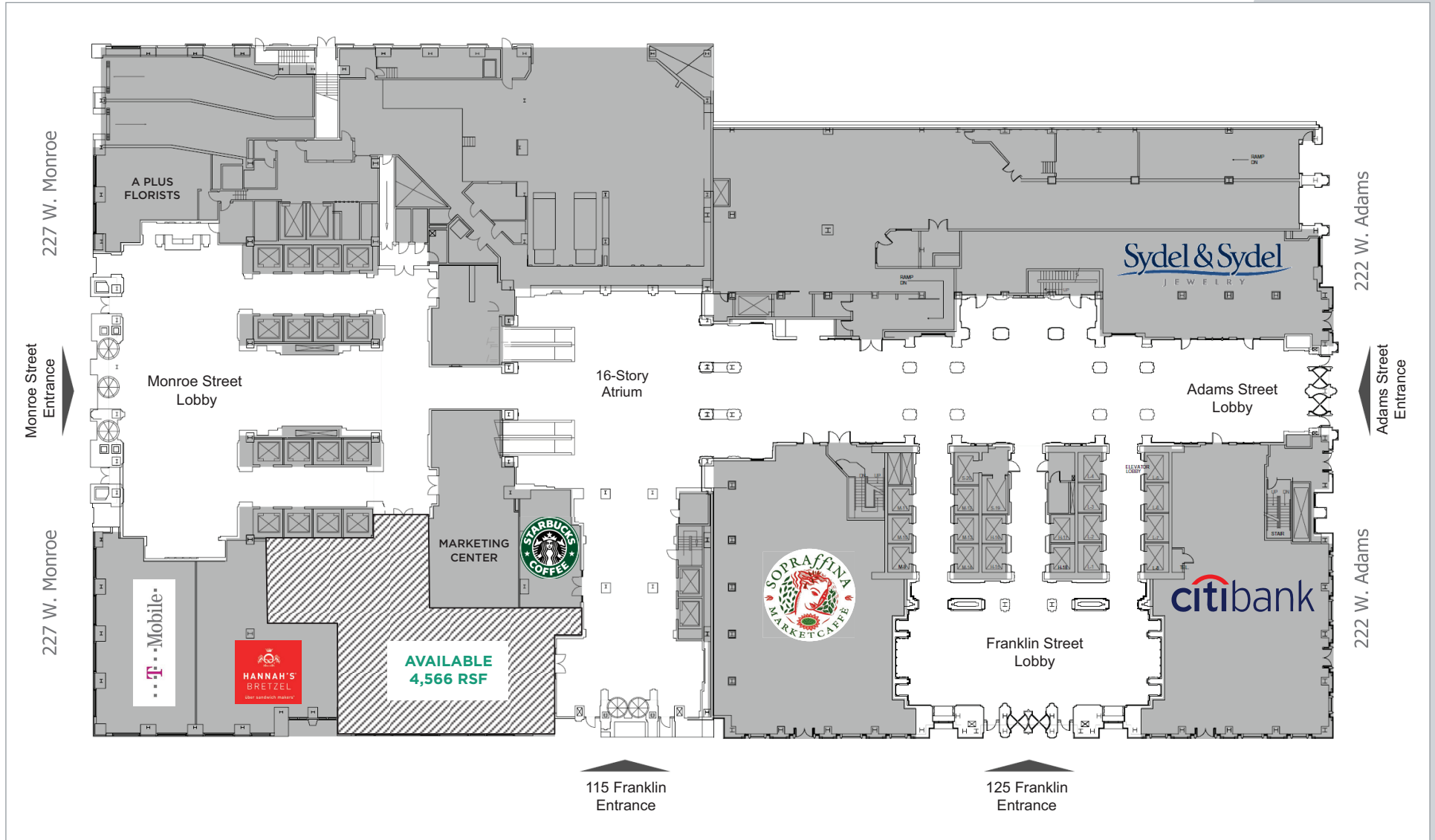

Owned and managed by



TISHMAN SPEYER



# THE FRANKLIN | 227 W. MONROE

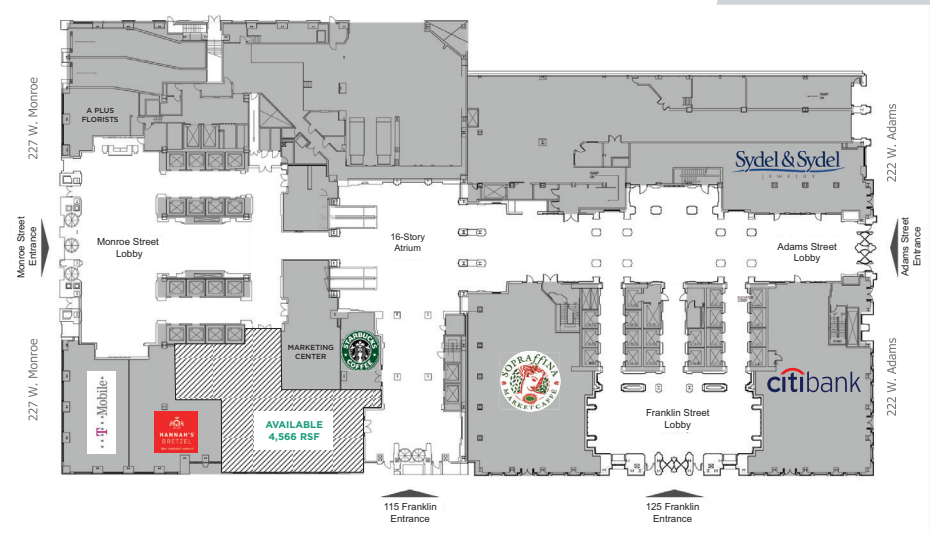
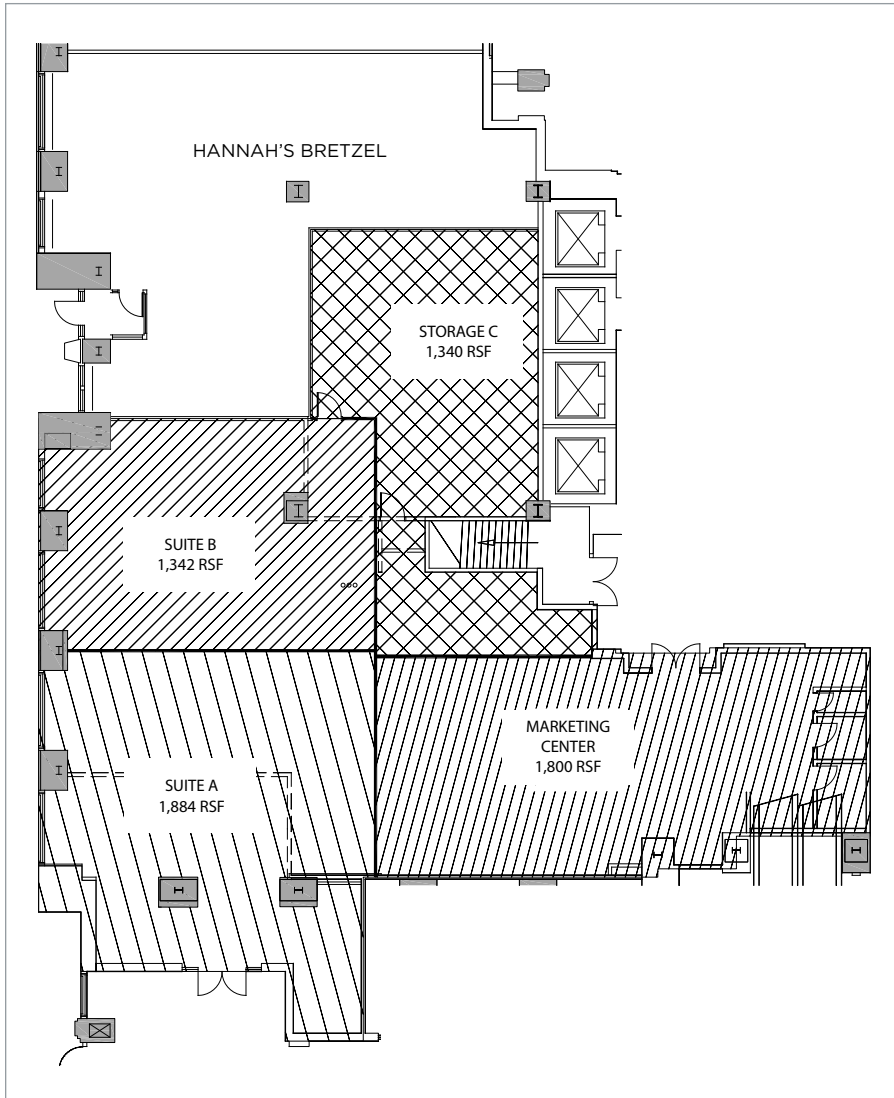

Owned and managed by



TISHMAN SPEYER



STONE  
REAL ESTATE