



*The*  
**ALAMEDA**



 **Newmark  
Knight Frank**

 **PENINSULA**  
land & capital

**DEBORAH O'REILLY** | 650.358.5256  
**JOSH ROWELL** | 650.358.5261  
**CRAIG KALINOWSKI** | 650.358.5287  
**ROGER FIELDS** | 650.327.2014



## AMENITIES



- On-site food service cafe with atrium seating
- Energy Star Rating, LEED Gold certified
- Common conference room
- Newly renovated collaboration area
- Two levels of covered parking
- On-site security guard

# Highlights

## LOCATION



- The premier location boasts unparalleled views of the San Francisco Bay, East Bay and Peninsula Hills
- Direct access to Highway 92 with connectors to Interstate 280 and Highway 101
- Centrally located between San Francisco, Silicon Valley and the Mid-Peninsula
- Ten minutes from SFO
- Five minute shuttle to San Mateo Hillsdale Caltrain Station





## SECOND FLOOR

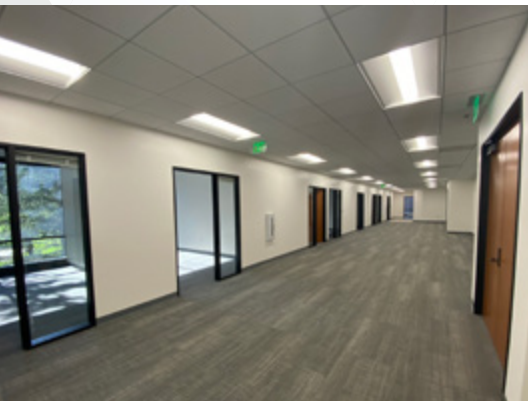

Suite 260: ±4,478 sf  
*Golf Course Views*

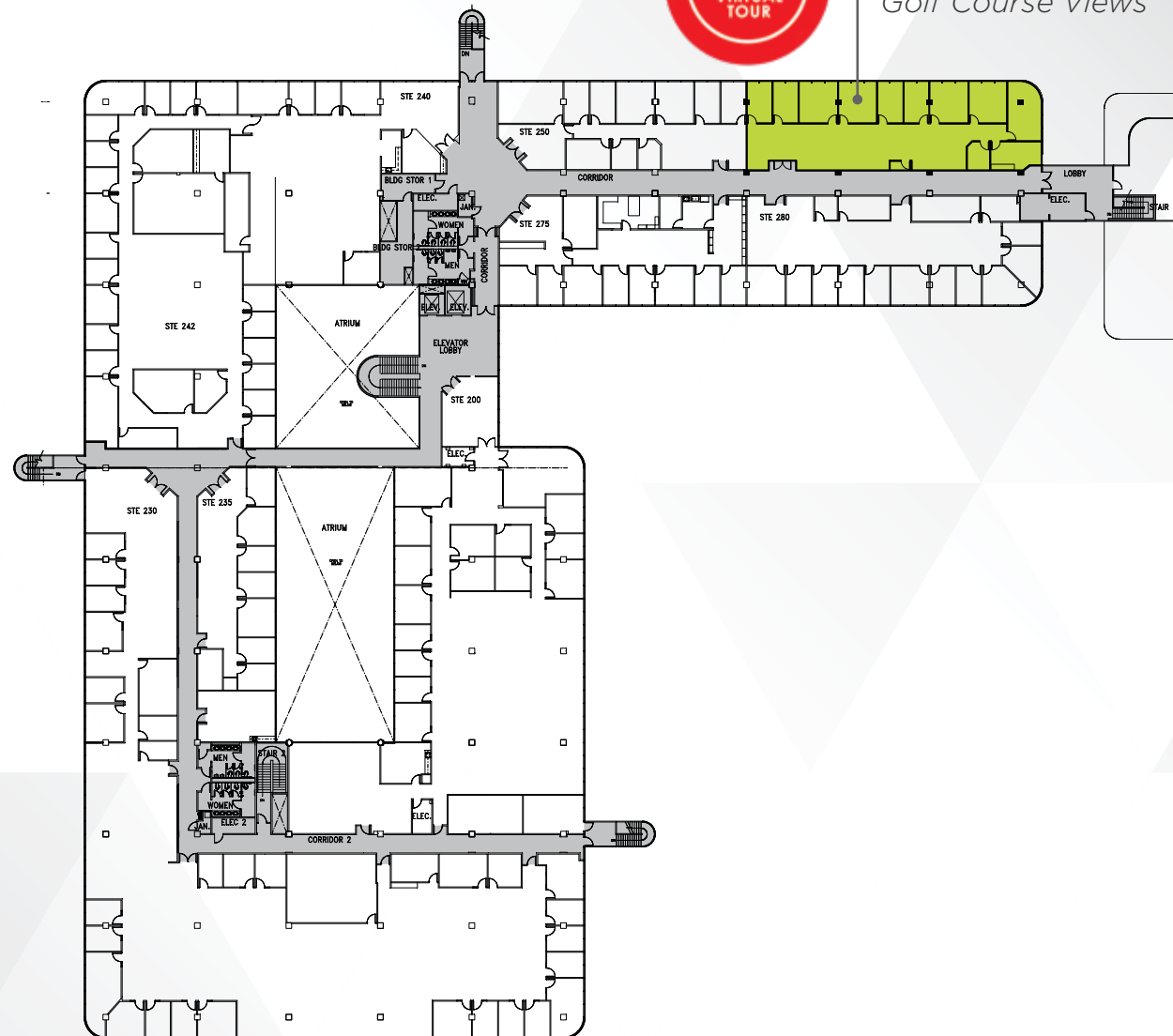

## AMENITIES

- Located near many area shopping centers featuring flagship retail stores as well as restaurants, grocery stores, a brewery, movie theaters, and community spaces



BRIDGEPOINTE SHOPPING CENTER

Caltrain

101

DOWNTOWN SAN MATEO

25th AVENUE RESTAURANTS

COLLEGE OF SAN MATEO

CRYSTAL SPRINGS SHOPPING VILLAGE

The ALAMEDA

BAY MEADOWS STATION

HILLSDALE SHOPPING CENTER

LAURELWOOD SHOPPING CENTER

Caltrain

PARK PLACE AT BAY MEADOWS

101

92

INTERSTATE 280

# Shuttle Schedule

## CAMPUS DRIVE AREA - AM SCHEDULE

RUN NUMBERS	AM 1	AM 2	AM 3	AM 4	AM 5
CALTRAIN ARRIVES HILLSDALE STATION					
Train numbers Northbound (from SJ)	207	215	323	227	
	6:45	7:34	8:24	8:59	
Train numbers Southbound (from SF)	208	216	324	228	
	6:54	7:35	8:24	8:54	
SHUTTLE DEPARTS HILLSDALE STATION					
Shuttle Departs Station	7:00	7:40	8:30	9:05	
SHUTTLE ARRIVES AT PROJECT					
Alameda de las Pulgas/20th Ave.	7:10	7:50	8:40	*9:15	

Hillsdale Caltrain Station: Stop is located at the East-Side of the Caltrain Station (Opposite side of El Camino Real).

\*Shuttle does not return to the residential stops & Caltrain station.

## CAMPUS DRIVE AREA - PM SCHEDULE

RUN NUMBERS	PM 1	PM 2	PM 3	PM 4	PM 5
SHUTTLE ARRIVES AT PROJECT					
Alameda de las Pulgas/20th Ave.	3:23	4:25	4:59	5:49	6:27
SHUTTLE ARRIVES HILLSDALE STATION					
Shuttle Arrives Station	3:34	4:36	5:10	6:00	*6:38
CALTRAIN DEPARTS HILLSDALE STATION					
Train numbers Northbound (from SJ)	159	263	371	381	283
	4:08	4:51	5:18	6:18	6:47
Train numbers Southbound (from SF)	156	262	264	274	380
	3:39	4:50	5:15	6:15	6:43

Hillsdale Caltrain Station: Stop is located at the East-Side of the Caltrain Station (Opposite side of El Camino Real).

\*Shuttle does not return to residential & employer stops.

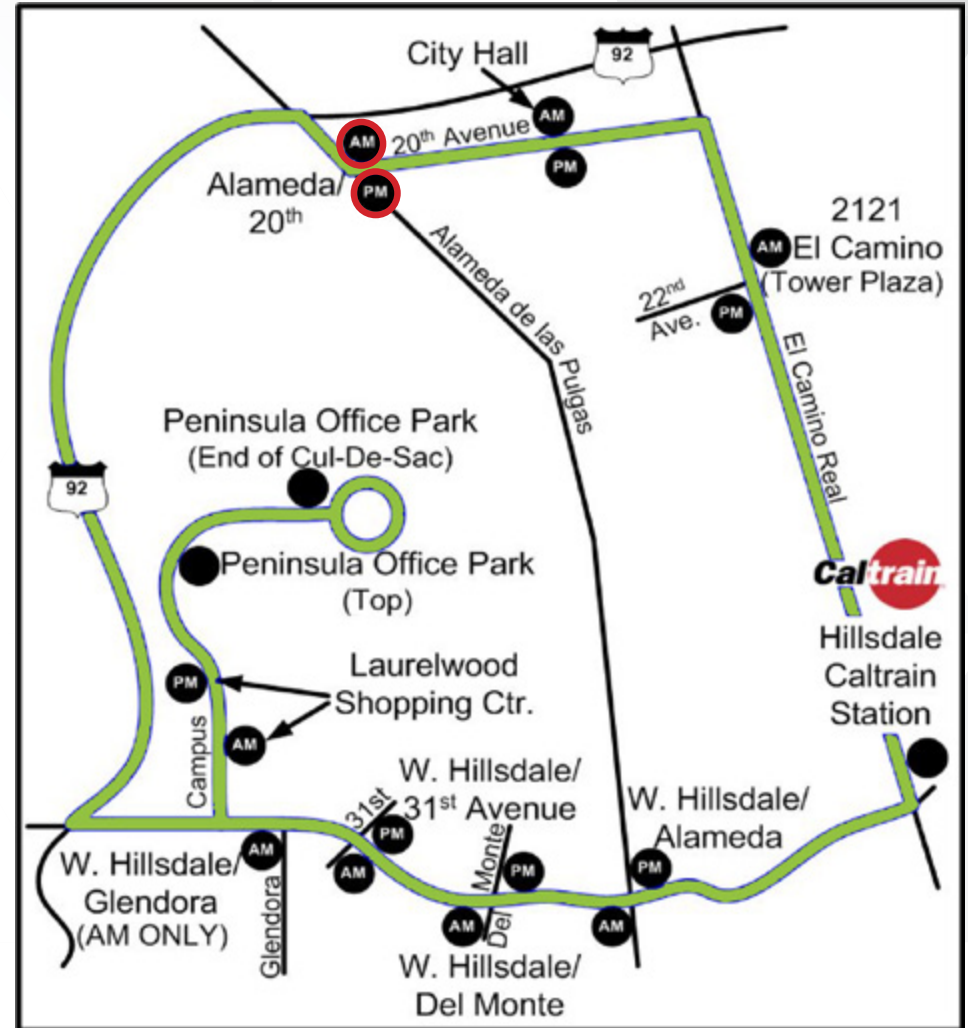



**DEBORAH O'REILLY**  
DIRECTOR

---

650.358.5256  
doreilly@ngkf.com  
CA RE License #01895522

**JOSH ROWELL**  
EXECUTIVE MANAGING DIRECTOR

---

650.358.5261  
jrowell@ngkf.com  
CA RE License #01236434

**CRAIG KALINOWSKI**  
SENIOR MANAGING DIRECTOR

---

650.358.5287  
ckalinowski@ngkf.com  
CA RE License #01260870

**ROGER FIELDS**  
PENINSULA LAND

---

650.327.2014  
650.207.1610  
rfields@peninsulaland.com

2950 SOUTH DELAWARE STREET, SUITE 125, SAN MATEO, CA 94403

The distributor of this communication is performing acts for which a real estate license is required. The information contained herein has been obtained from sources deemed reliable but has not been verified and no guarantee, warranty or representation, either express or implied, is made with respect to such information. Terms of sale or lease and availability are subject to change or withdrawal without notice. 17-1117 • 03/20

