

# For Lease



102,261 SF | DIVISIBLE  
Anchor Space Opportunity  
New Development

Westfield

DICK'S  
SPORTING

Macy's  
CHINESE KITCHEN • BAR

DICK'S  
SPORTING GOODS

Barnes & Noble  
BURGER & GRILL

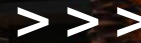

Westfield Palm Desert  
72-880 Highway 111 | Palm Desert, CA

Proximity to:  
*Dick's Sporting Goods, JCPenney,  
Macy's and Barnes & Noble*

Seritage.com





# Property Highlights

- Strong box opportunity for lease at major entrance of the high profile Westfield Palm Desert Regional Mall
- Opportunities for portion of Sears building include 27,770 SF ground level space, 17,751 SF lower level space, 19,569 SF sublevel space, and Auto: 10,978 SF (Divisible - off map)
- Westfield Palm Desert is a 980,000 SF regional mall located along the highly -trafficked Highway 111 at Monterey Avenue
- Additional mall anchors include Dick's Sporting Goods, JCPenney, Macy's and Barnes & Noble
- Interior mall tenants include F21, Tilly's, Victoria Secret, Justice and American Eagle Outfitters

## Westfield Palm Desert

102,261 SF Available (Divisible)

### Sears Auto Center:

6,250 SF

# Center Profile

★macy's JCPenney PACSUN

sears

H&M



# Site Plan

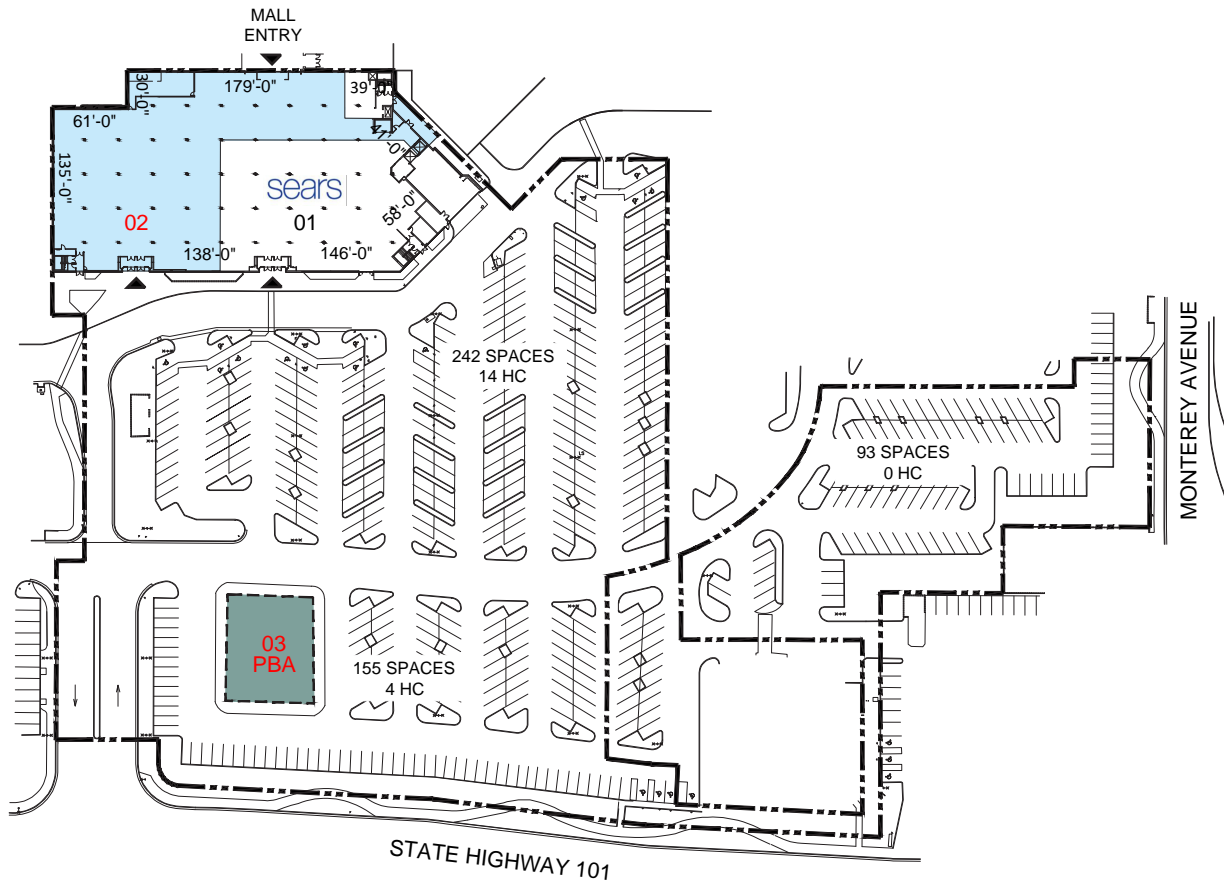

GROUND LEVEL

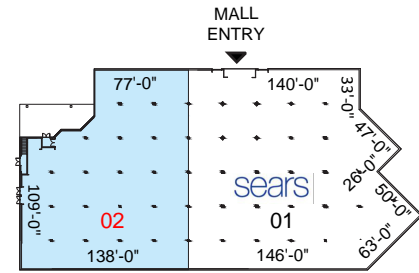

LOWER LEVEL 1

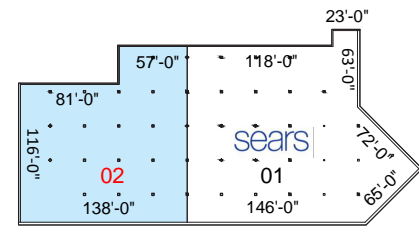

LOWER LEVEL 2

PALM DESERT, CA - 140,900 SF

○ 01	SEARS	69,550 SF
● 02	AVAILABLE	65,100 SF
● 03	AVAILABLE - PBA	6,250 SF

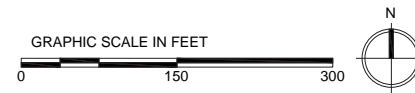

# Site Plan

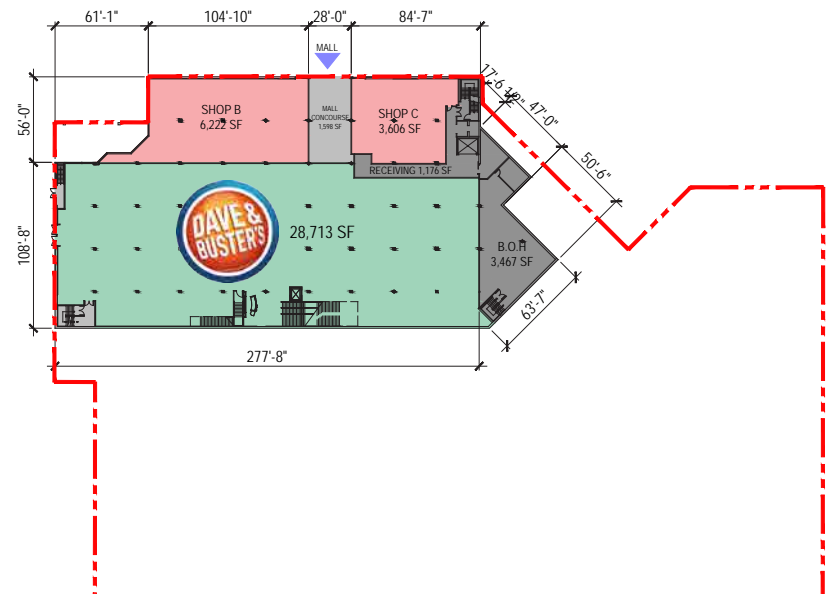
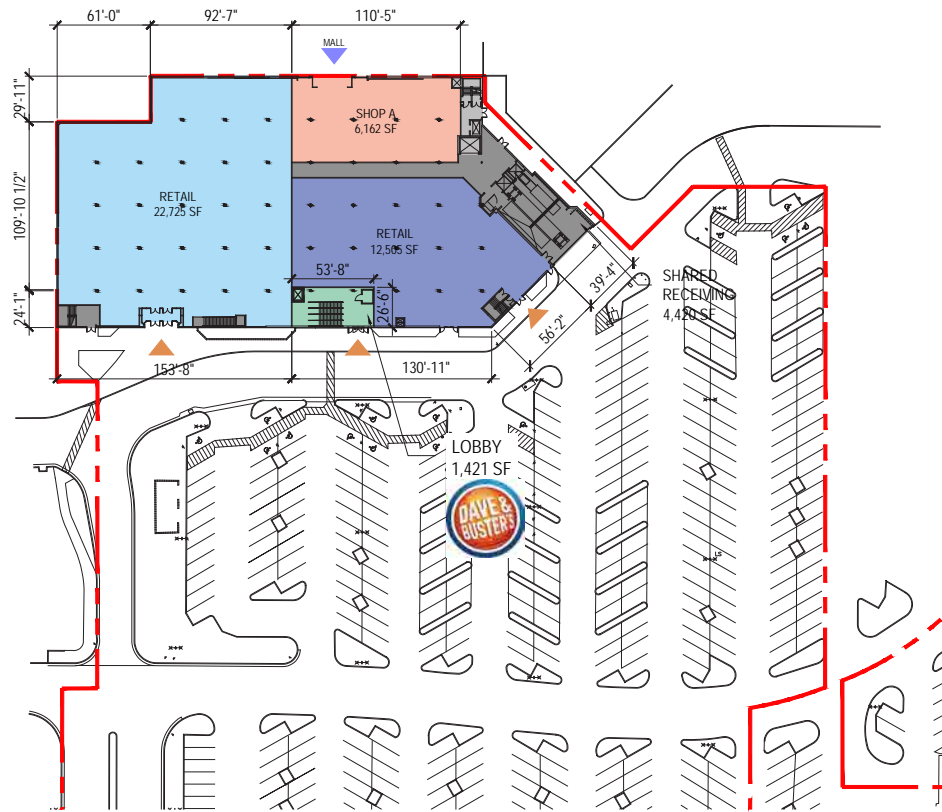

# Area Demographics



**40,348 | 66,707 | 270,065**  
3 mile ----- 5 miles ----- 10 miles  
**Total Population**



**\$530,217 | \$564,862 | \$439,412**  
3 mile ----- 5 miles ----- 10 miles  
**Median Home Value**

**2.08 | 2.02 | 2.43**  
3 mile ----- 5 miles ----- 10 miles  
**Average Household Size**



**\$104,444 | \$113,802 | \$97,427**  
3 mile ----- 5 miles ----- 10 miles  
**Average Household Income**





# Area Retailers

TRAFFIC COUNT:  
Over 30,656 Cars Per Day  
HWY 111 & Monterey Ave

(Per ESRI Traffic Count Profile)

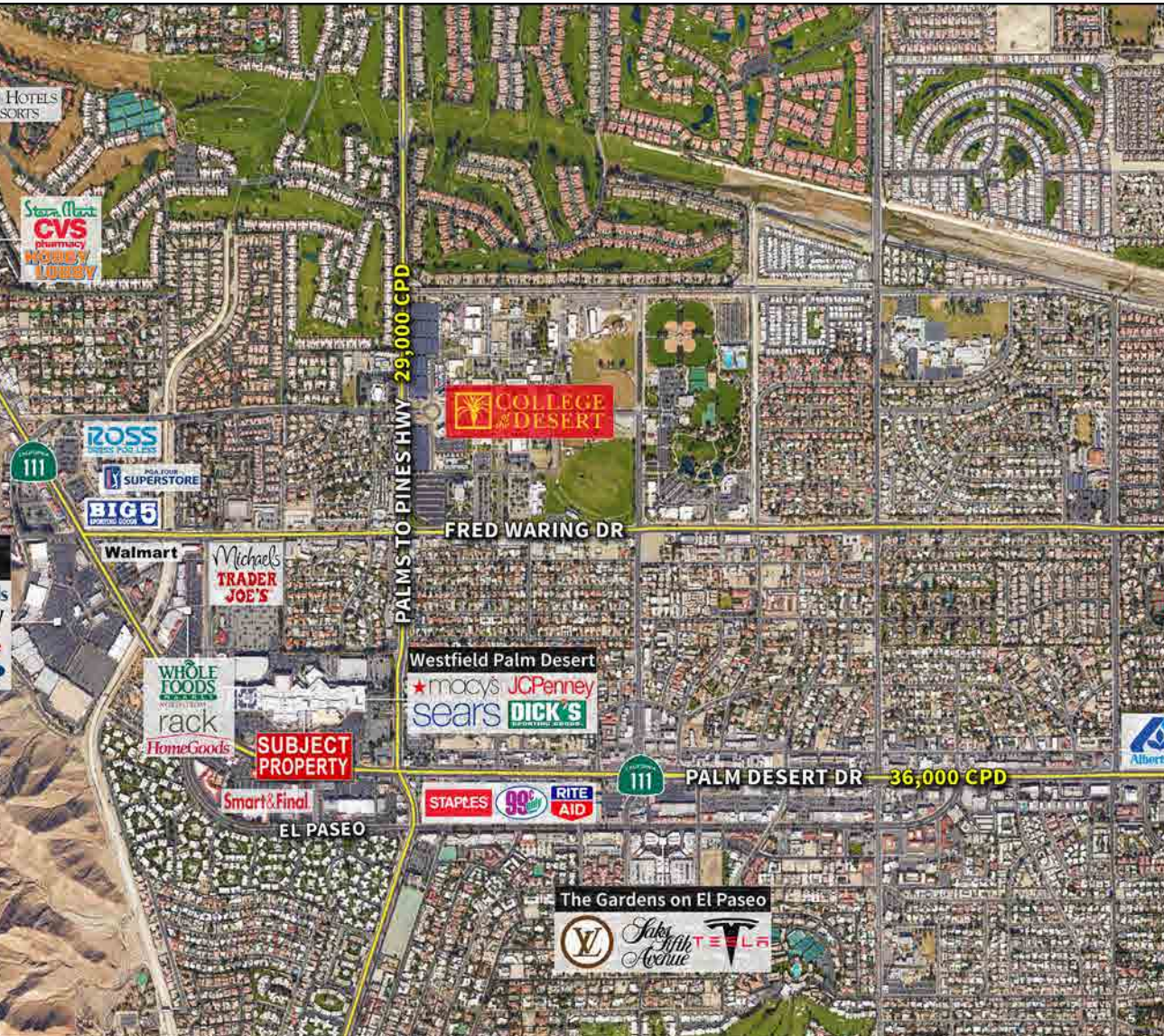

# The Team

Our retail advisors are here to support your business goals.  
Let our expertise guide you in brokerage, investments,  
management, development and more.



**Scott Burns**  
Managing Director  
License #01237652  
+1 310 694 3188  
scott.burns@am.jll.com



**Shauna Mattis**  
Executive Vice President  
License #01071320  
+1 310 694 3190  
shauna.mattis@am.jll.com



**Jared Davis**  
Vice President  
License # 01504667  
Tel +1 949 296 3602  
jaredc.davis@am.jll.com



**Alex Otto**  
Associate  
License # 02042292  
Tel +1 424 901 8193  
alex.otto@am.jll.com

