



# St. Johns County, FL

### Tax Bill

### Estimate Taxes

### 2020 TRIM Notice

### 2019 TRIM Notice

### Summary

**Parcel ID** 1358110174  
**Location Address** 89 MOULTRIE CREEK CIR  
 SAINT AUGUSTINE 32086-0000  
**Neighborhood** Moultrie Woods Townhouses (2256.01)  
**Tax Description\*** OR720/681 MOULTRIE WOODS BLDG 17 LOT D (AKA UNIT 17-D) OR4643/1979  
*\*The Description above is not to be used on legal documents.*  
**Property Use Code** Single Family Townhouse (0130)  
**Subdivision** N/A  
**Sec/Twp/Rng** 2-8-29  
**District** County (District 300)  
**Millage Rate** 13.3141  
**Acreage** 0.020  
**Homestead** N

### Owner Information

**Owner Name** [Bacon James E, Loell J](#) 100%  
[Bacon Loell J](#) 100%  
**Mailing Address** 55 FERROL RD  
 SAINT AUGUSTINE, FL 32084-0000

### Map



**Valuation Information**

	2021
Building Value	\$55,497
Extra Features Value	\$0
Total Land Value	\$24,000
Agricultural (Assessed) Value	\$0
Agricultural (Market) Value	\$0
Just (Market) Value	<b>\$79,497</b>
Total Deferred	\$0
Assessed Value	<b>\$79,497</b>
Total Exemptions	\$0
Taxable Value	<b>\$79,497</b>

Values listed are from our working tax roll and are subject to change.

**Historical Assessment Information**

Year	Building Value	Extra Feature Value	Total Land Value	Ag (Market) Value	Ag (Assessed) Value	Just (Market) Value	Assessed Value	Exempt Value	Taxable Value
2020	\$57,154	\$0	\$24,000	\$0	\$0	\$81,154	\$81,154	\$0	\$81,154
2019	\$55,904	\$0	\$24,000	\$0	\$0	\$79,904	\$79,904	\$0	\$79,904
2018	\$57,376	\$0	\$24,000	\$0	\$0	\$81,376	\$51,402	\$29,974	\$51,402
2017	\$42,373	\$0	\$17,000	\$0	\$0	\$59,373	\$46,729	\$12,644	\$46,729
2016	\$34,481	\$0	\$8,000	\$0	\$0	\$42,481	\$42,481	\$0	\$42,481
2015	\$35,510	\$0	\$8,000	\$0	\$0	\$43,510	\$43,510	\$0	\$43,510
2014	\$35,538	\$0	\$9,000	\$0	\$0	\$44,538	\$44,274	\$264	\$44,274
2013	\$30,749	\$0	\$9,500	\$0	\$0	\$40,249	\$40,249	\$0	\$40,249
2012	\$28,968	\$0	\$11,500	\$0	\$0	\$40,468	\$40,468	\$0	\$40,468
2011	\$43,272	\$0	\$12,500	\$0	\$0	\$55,772	\$55,772	\$0	\$55,772
2010	\$62,333	\$0	\$20,000	\$0	\$0	\$82,333	\$82,333	\$0	\$82,333

**Building Information**

<b>Building</b>	1	<b>Roof Structure</b>	Gable Hip
<b>Actual Area</b>	848	<b>Roof Cover</b>	Composite Shingle
<b>Conditioned Area</b>	1078	<b>Interior Flooring</b>	Carpet, Sheet Vinyl
<b>Actual Year Built</b>	1986	<b>Interior Wall</b>	Drywall
<b>Use</b>	Single Family Townhouse	<b>Heating Type</b>	Air Duct
<b>Style</b>	01	<b>Heating Fuel</b>	
<b>Class</b>	N	<b>Air Conditioning</b>	Central
<b>Exterior Wall</b>	Stucco, Wood	<b>Baths</b>	

Category	Type	Pct
Exterior Wall	Wood	80%
Exterior Wall	Stucco	20%
Roofing Structure	Gable Hip	100%
Roofing Cover	Composite Shingle	100%
Interior Walls	Drywall	100%
Interior Flooring	Carpet	70%
Interior Flooring	Sheet Vinyl	30%
Heating Type	Air Duct	100%
Air Conditioning	Central	100%
Frame	Wood Frame	100%
Plumbing	7 Fixtures	100%
Electrical	Good	100%
Foundation	Concrete Perimeter Footing	100%
Condition	Good	100%
Floor System	Concrete Slab	100%

Description	Conditioned Area	Actual Area
FINISHED DECK	0	224
2 STORY	1024	512
FRAME UTILITY	0	16
BASE AREA	54	54
FINISHED OPEN PORCH	0	42
Total SqFt	1078	848

**Land Information**

Use Description	Front	Depth	Total Land Units	Unit Type	Land Value
Single Family Townhouse	0	0	1	UT	\$24,000

**Sale Information**

Recording Date	Sale Date	Sale Price	Instrument Type	Book	Page	Qualification	Vacant/Improved	Grantor	Grantee
11/21/2018	11/21/2018	\$96,000.00	WD	<a href="#">4643</a>	<a href="#">1979</a>	Q	I	BAGDY MARK R,DONNA J	BACON JAMES E,LOELL J
	10/1/1986	\$54,250.00		<a href="#">721</a>	<a href="#">1251</a>	Q	I		BAGDY MARK R,DONNA J
	1/1/1986	\$0.00		<a href="#">720</a>	<a href="#">668</a>	U	V		

**Sketch Information**

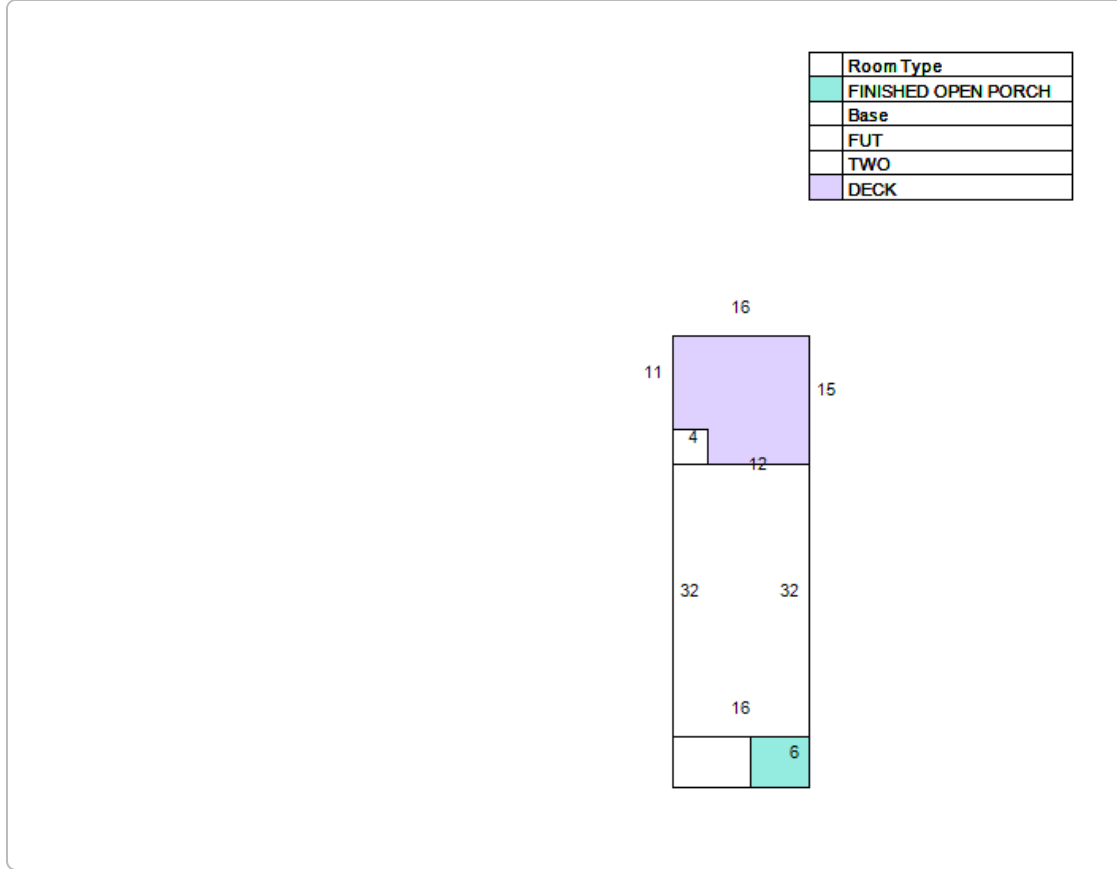

No data available for the following modules: Exemption Information, Extra Feature Information.

[User Privacy Policy](#)  
[GDPR Privacy Notice](#)

Last Data Upload: 10/13/2020, 12:17:40 AM



Version 2.3.90