



Park Corners II

13560 Circle Drive | Orland Park, Illinois

Highlights

- Move in Condition
- Charming brick building
- Class A office space
- Frontage on LaGrange Road
- Conveniently located near downtown Orland Park

Details

- Building size: **11,600 SF**
- Parking: **46 free surface spaces**
- Year Built: **2008**

Pricing

- Lease Price: **\$13.50 PSF Net**
- CAM: **\$4.93 PSF**
- R.E. Taxes: **\$5.90 PSF**

For More Information, Contact:

Rawly Lantz

D: 630.729.7944

M: 630.810.0300 Ext. 116

rlantz@cawleychicago.com

Tony Russo

D: 630.729.7935

M: 630.810.0300 Ext. 112

trusso@cawleychicago.com

Available

- Suite 203: **1,158 SF**

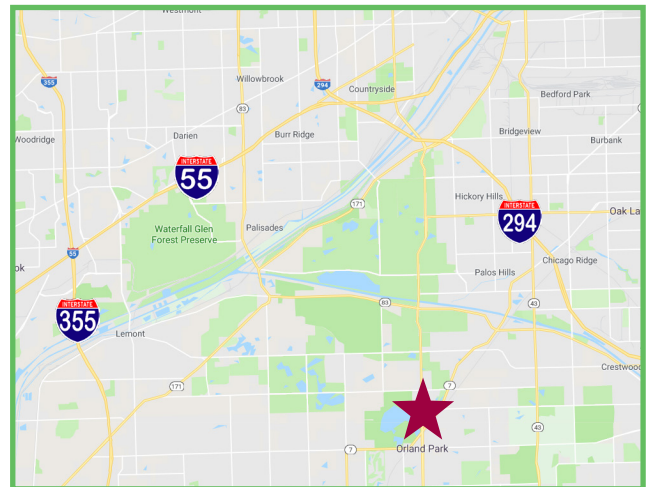

Floor Plan

2nd Floor | 13560 Circle Drive, Orland Park

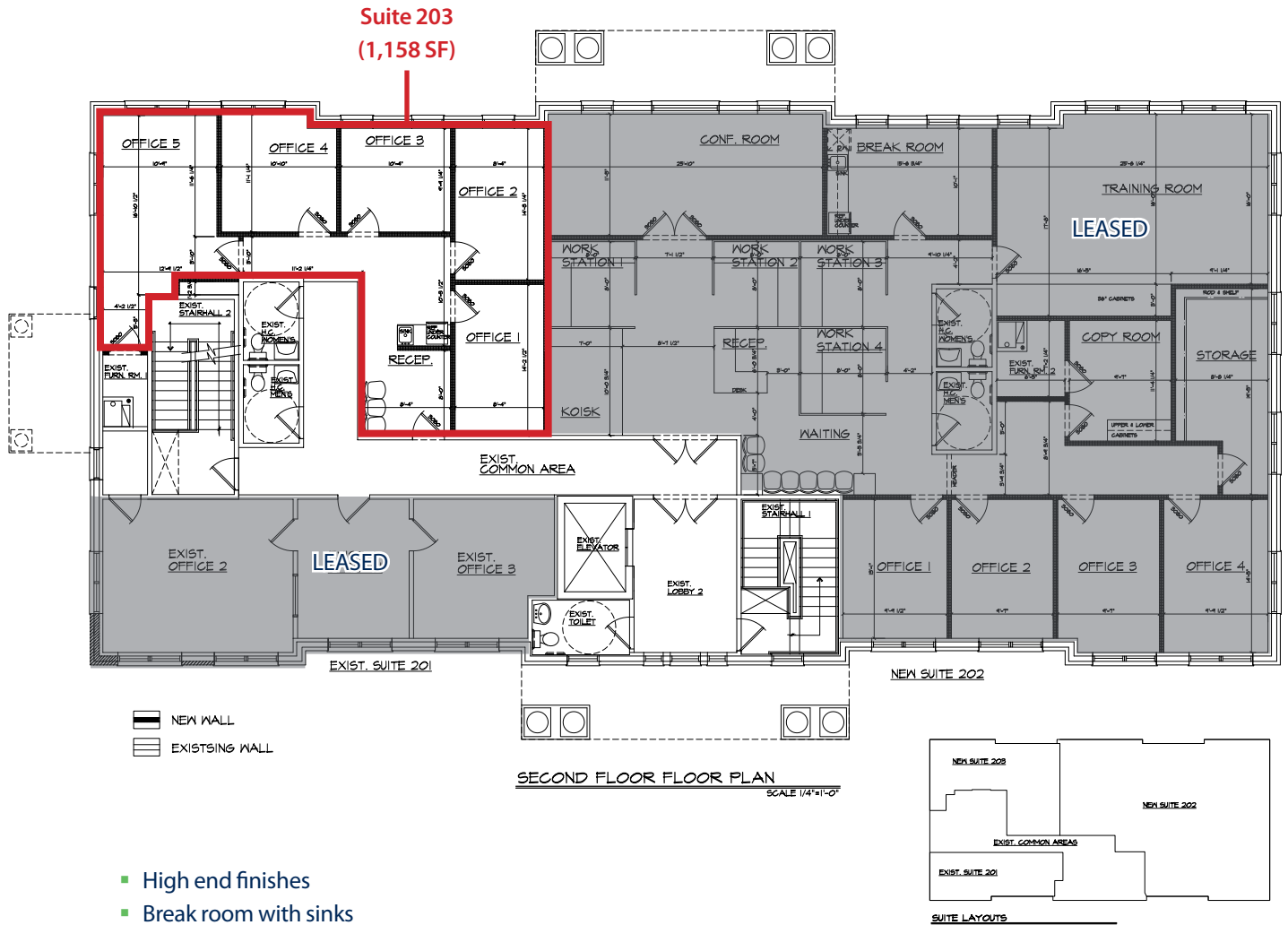

- High end finishes
- Break room with sinks
- Individual offices available for lease

For More Information, Contact:

Rawly Lantz

D: 630.729.7944

M: 630.810.0300 Ext. 116

rlantz@cawleychicago.com

Tony Russo

D: 630.729.7935

M: 630.810.0300 Ext. 112

trusso@cawleychicago.com