



## Former Vern Eide Auto Body Shop

2309 S. Spring Avenue, Sioux Falls, SD 57105

### Property Features

- Service garage for sale
- Building size: 18,046 sq. ft.
- Year built: 1957
- Lot size: .53 acres (23,179 sq. ft.)
- Radiant heat
- Zoning: C-2
- Includes 3 auto paint booths and other equipment

### Pricing

- Price Reduced: \$795,000 (\$44.05/ sq. ft.)
- 2018 Real Estate Taxes: \$9,513.80

### Location

- Located one block west of Minnesota Avenue
- Area neighbors include: Coca-Cola, Tires, Tires, Tires, Get n' Go, US Bank, Bagel Boy, Year Round Brown, Breadsmith

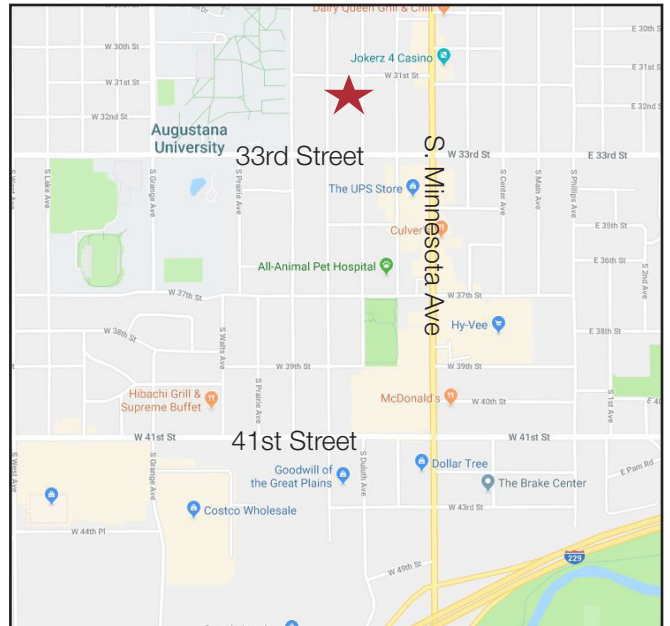

**Craig Hagen, CCIM, SIOR**

+1 605 444 7115 Direct  
+1 605 310 4227 Cell  
chagen@naisiouxfalls.com

For Sale  
Industrial Building

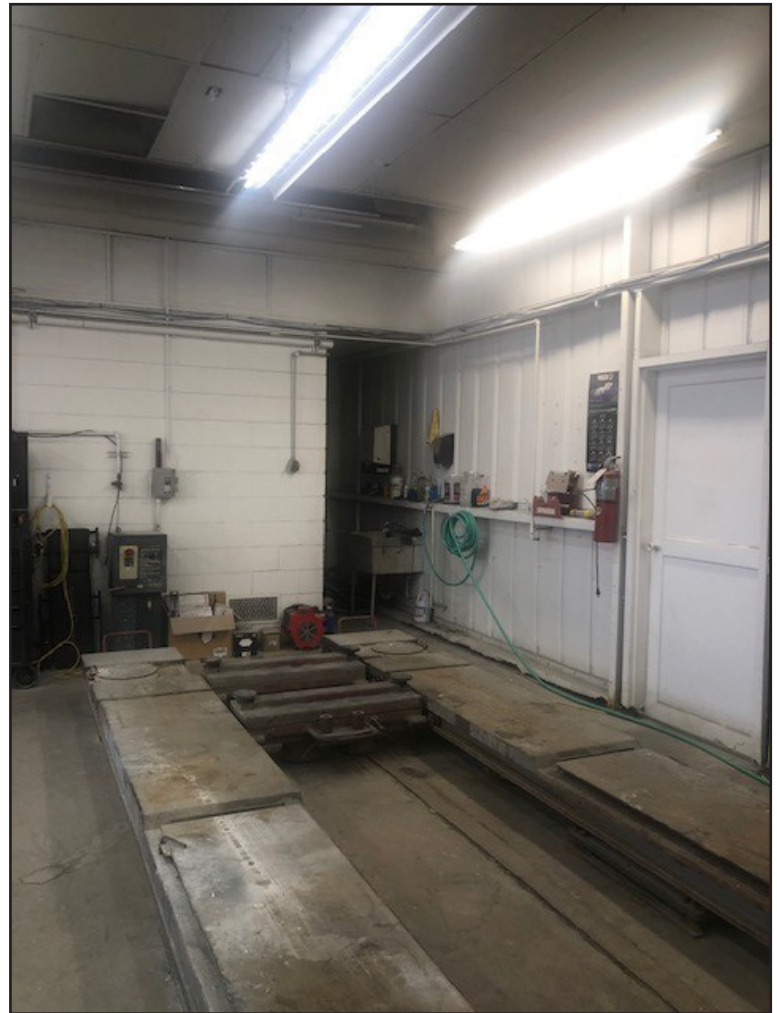
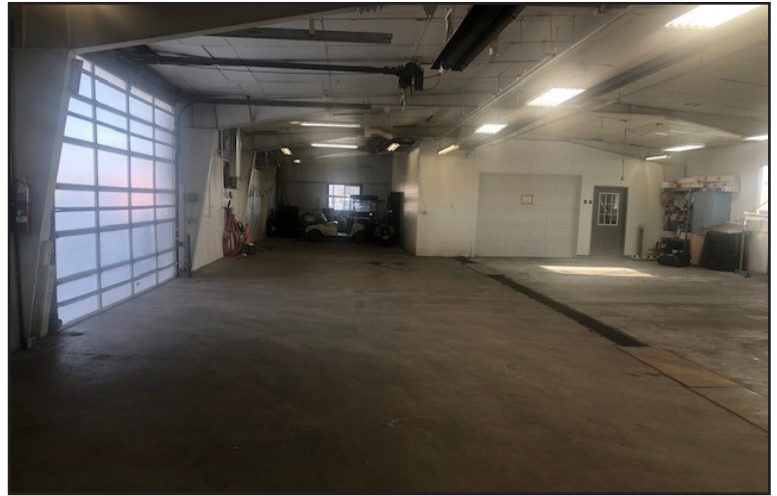

# For Sale Industrial Building

