

11300 RICHMOND AVENUE
Houston, Texas 77082

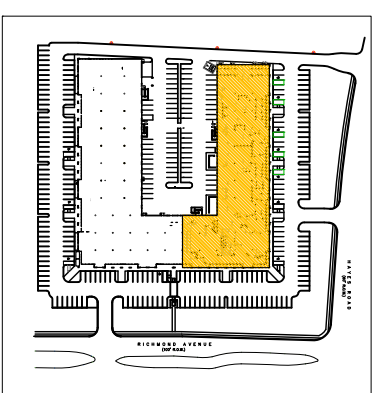

AREA MAP



SITE PLAN

BUILDING SUMMARY
LEASING AREA: 36,900 SQ. FT.

BUILDING FEATURES

- MASTER PLANNED BUSINESS PARK
- EASY ACCESS TO BELTWAY 8
- 100 % FIRE SPRINKLED
- 300 KW NATURAL GAS POWERED GENERATOR
- CONVERTENTS HVAC AUTOMATION SYSTEM
- NEGATIVE PRESSURE DOSING CHAMBER
- 237 PATIENT BED CLINIC SECURITY SYSTEM
- CLOSED CIRCUIT TV MONITORING SYSTEM
- SECURITY LIGHTING
- CONCRETE TILT WALL CONSTRUCTION
- ALL CONCRETE PAVING
- COVERED PARKING



2000 West Loop South, Suite 430
Houston, Texas 77027
Ph# (713) 366-3143

YONG ARCHITECTS, INC. 4-22-2019



SUITE 11300 FLOOR PLAN