

FOR LEASE

36,680 SF

INDUSTRIAL
SPACE FOR
LEASE

MULTI-
TENANTED



TRANSWESTERN

REAL ESTATE
SERVICES

1 DODGE DRIVE

West Caldwell, NJ

[CLICK FOR VIRTUAL TOUR](#)



Availability:

- Total: 36,680 SF
- Office area: 2,969 SF
- Warehouse area: 33,613 SF

Space Features:

- Ceiling height: 21'
- Loading: 2 tailgates
- Column span: 40' x 40'
- Sprinkler: wet system
- Power: 400 Amps, 480 Volts
- Taxes & CAM: \$3.51 PSF
- Rent: Negotiable

Location Features:

- Professionally owned and managed building
- Easily accessible to Routes US-46, I-80, I-280, I-287
- Amenities in the immediate area include restaurants, banks, shopping centers and hotels

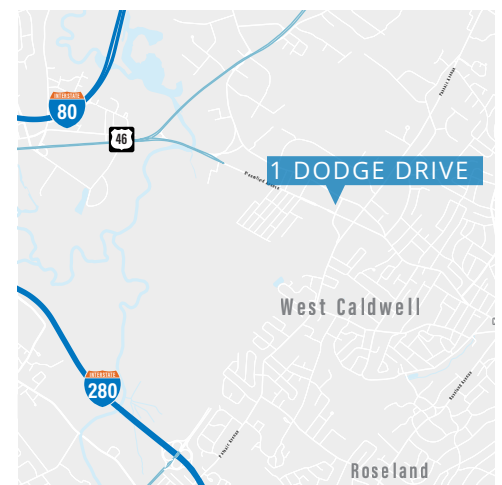

Leasing Information:

Alex Previdi
973.947.9215
Alex.Previdi@transwestern.com

The information provided herein was obtained from sources believed reliable; however, Transwestern makes no guarantees, warranties or representations as to the completeness of accuracy thereof. The presentation of this property is submitted subject to errors, omissions, change of price or conditions, prior to sale or lease, or withdrawal without notice. Copyright © 2020 Transwestern.

1 DODGE DRIVE

West Caldwell, NJ



TRANSWESTERN

REAL ESTATE
SERVICES

AVAILABLE: 36,680 SF

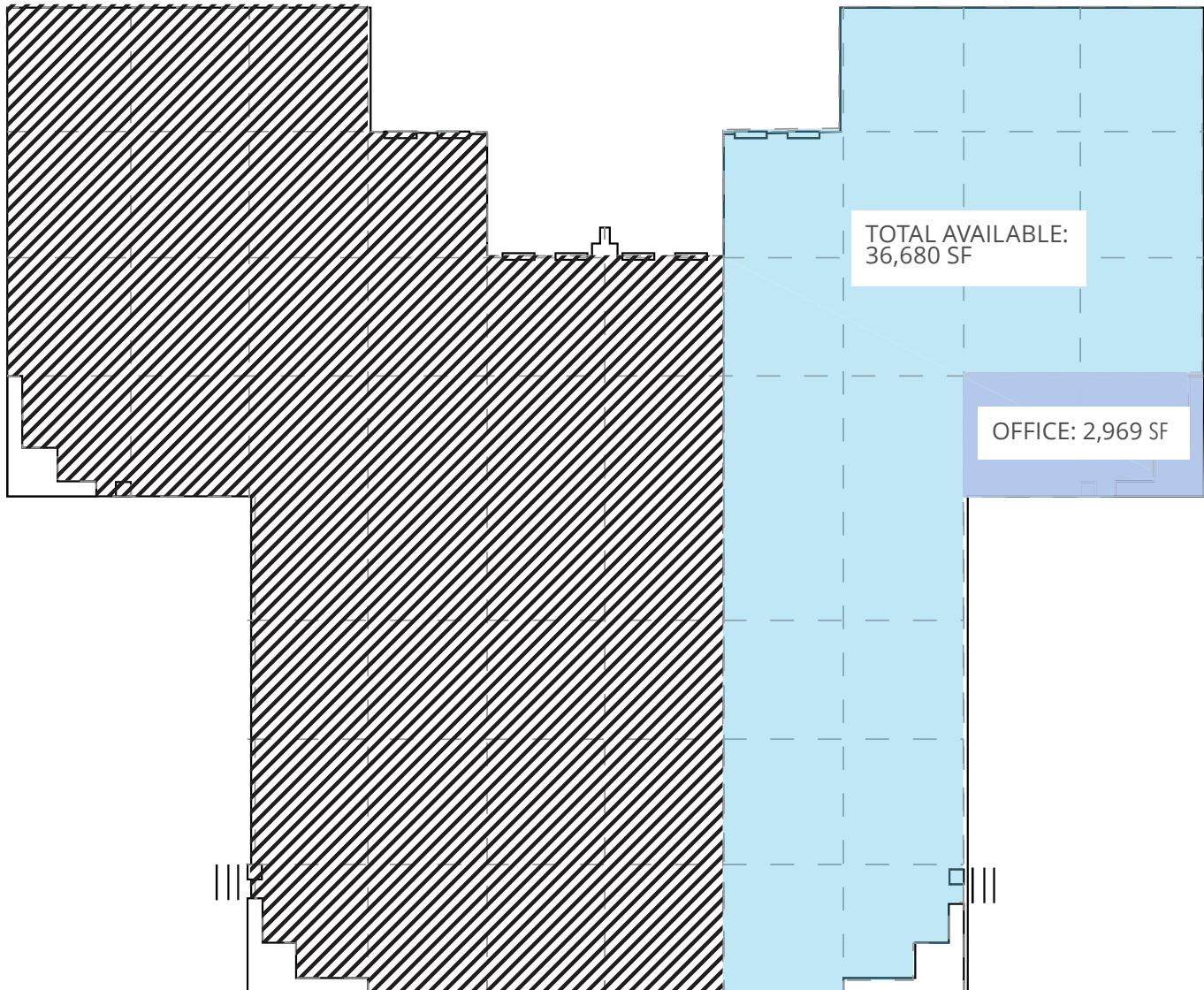

Leasing Information:

Alex Previdi

973.947.9215

Alex.Previdi@transwestern.com

The information provided herein was obtained from sources believed reliable; however, Transwestern makes no guarantees, warranties or representations as to the completeness of accuracy thereof. The presentation of this property is submitted subject to errors, omissions, change of price or conditions, prior to sale or lease, or withdrawal without notice. Copyright © 2020 Transwestern.