



West Cherry Street Land

1016 & 1008 W. Cherry St., Vermillion, SD 57069

Property Features

- 1016 W Cherry Street (land with existing building)
- Building size: 3,840 sq. ft.
- Year built: 1974
- Zoning: G-B

Pricing

- Proposed Lot 6A w/ building: \$135,000 (\$35.15/ sq. ft. building) lot size: 21,600 sq. ft.
- Proposed Lot 6B: \$24,000 - 16,000 sq. ft. (\$1.50/ sq. ft.)
- Proposed Lot 7A: \$54,000 - 27,000 sq. ft. (\$2.00/ sq. ft.)
- Proposed Lot 7B: \$30,000 - 20,000 sq. ft. (\$1.50/ sq. ft.)
- 2016 Real Estate Taxes Lot 6= \$1,904.20
- 2016 Real Estate Taxes Lot 7= \$1,787.08

Location

- Area neighbors include: Sturdevant's, Campbell's Supply, Pump 'n Pak, and Brunick Furniture
- Located 1 mile west of the University of SD campus

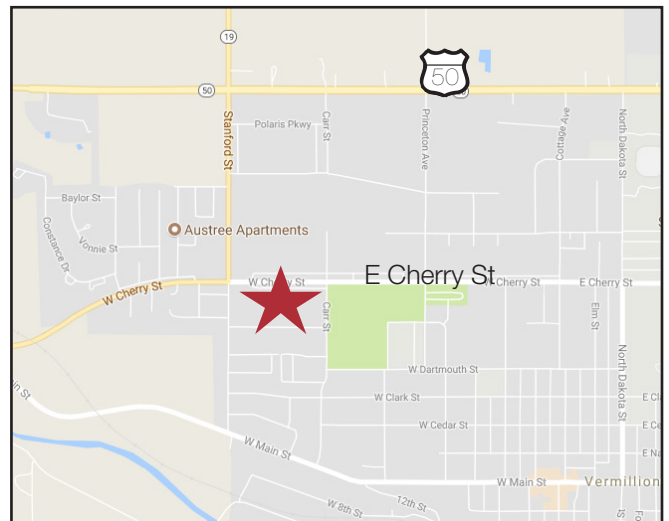

Dennis Breske, CCIM, SIOR

+1 605 444 7100 Direct

+1 605 310 6666 Cell

dbreske@naisiouxfalls.com

Co-listed with Premier Realty

NO WARRANTY OR REPRESENTATION, EXPRESS OR IMPLIED, IS MADE AS TO THE ACCURACY OF THE INFORMATION CONTAINED HEREIN, AND THE SAME IS SUBMITTED SUBJECT TO ERRORS, OMISSIONS, CHANGE OF PRICE, RENTAL OR OTHER CONDITIONS, PRIOR SALE, LEASE OR FINANCING, OR WITHDRAWAL WITHOUT NOTICE, AND OF ANY SPECIAL LISTING CONDITIONS IMPOSED BY OUR PRINCIPALS NO WARRANTIES OR REPRESENTATIONS ARE MADE AS TO THE CONDITION OF THE PROPERTY OR ANY HAZARDS CONTAINED THEREIN ARE ANY TO BE IMPLIED.

2500 W. 49th Street, Suite 100
Sioux Falls, SD 57105
+1 605 357 7100
naisiouxfalls.com

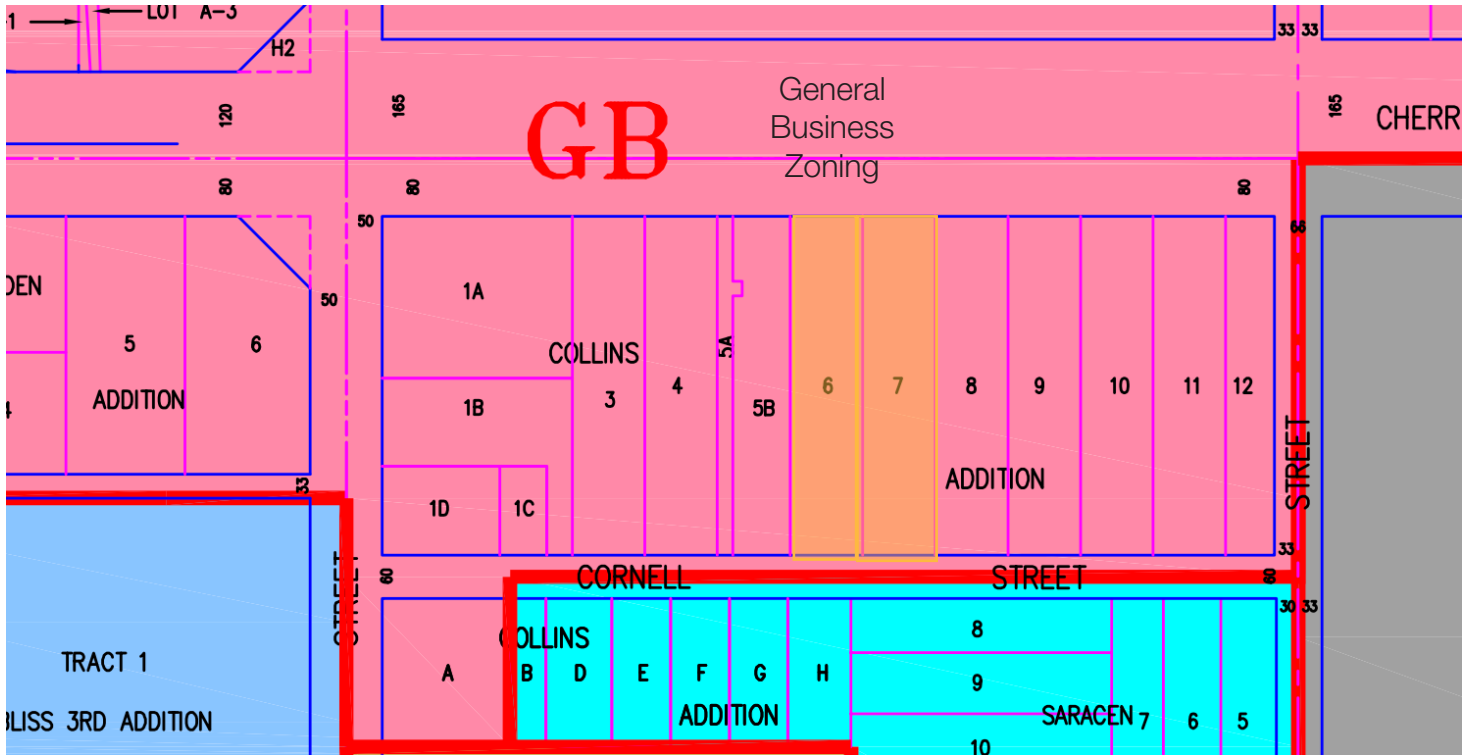

For Sale
Industrial Building & Land

