

**FOR SALE  
FREEZER/COOLER SPACE**

# 4810 NEWPORT STREET

**:: COMMERCE CITY, COLORADO**

**15,225 SF  
FREEZER/COOLER SPACE**

**USDA APPROVED FACILITY  
8,400 SF FOOD PROCESSING  
1,750 SF FREEZER SPACE  
8,000 SF FENCED YARD**



## LOCATION MAP

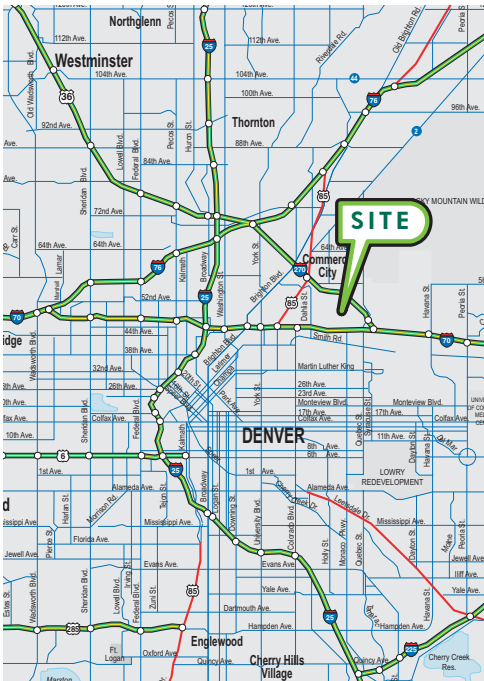

**TOTAL BUILDING SF:** 15,225 SF  
**OFFICE:** 2,253 SF  
**LAND AREA:** .78 Acres  
**LOADING:** 1 Drive-in and 8 Dock high  
**ELECTRICAL:** (to be verified by an electrician)  
**YEAR BUILT:** 1970  
**ZONING:** I-1, Adams County  
**SALE PRICE:** \$775,000 (\$50.90/SF)

## BUILDING FEATURES

- Refrigerated USDA production areas
- Secured/gated yard
- Floor drains with grease traps
- Freezer space at 0° - 18°
- Food processing from 48° - 52°

**FOR MORE  
INFORMATION  
PLEASE CONTACT**

**Paul Kluck, SIOR**  
720.528.6405  
paul.kluck@cbre.com  
www.cbre.com/paul.kluck

**Daniel Close**  
720.528.6342  
daniel.close@cbre.com  
www.cbre.com/daniel.close

**CBRE**

FOR SALE  
FREEZER/  
COOLER SPACE

# 4810 NEWPORT STREET

:: COMMERCE CITY, COLORADO

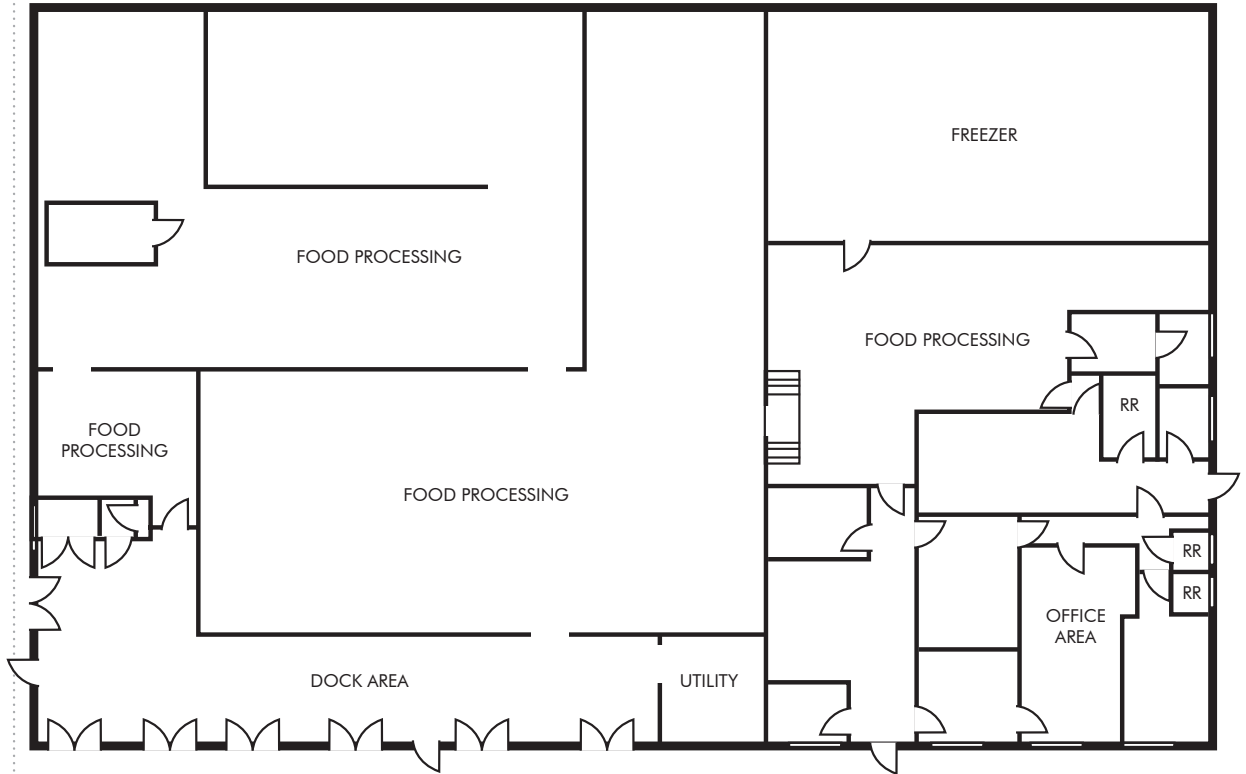

FOR MORE  
INFORMATION  
PLEASE  
CONTACT

**Paul Kluck, SIOR**

First Vice President  
T 720.528.6405  
paul.kluck@cbre.com



**Daniel Close**

Associate  
720.528.6342  
daniel.close@cbre.com

CBRE | 8390 E. Crescent Parkway | Suite 300 | Greenwood Village, CO 80111 | [www.cbre.com/denver](http://www.cbre.com/denver)

© 2013 CBRE, Inc. This information has been obtained from sources believed reliable. We have not verified it and make no guarantee, warranty or representation about it. Any projections, opinions, assumptions or estimates used are for example only and do not represent the current or future performance of the property. You and your advisors should conduct a careful, independent investigation of the property to determine to your satisfaction the suitability of the property for your needs.

