

Dierbergs Wentzville Crossing



Development

For More Information Contact:



314-991-8900

Weller Meyer (x226)
wmeyer@caplaco.com

11850 Studt Avenue
P.O. Box 419121
St. Louis, Missouri 63141

Fax 314-991-2474

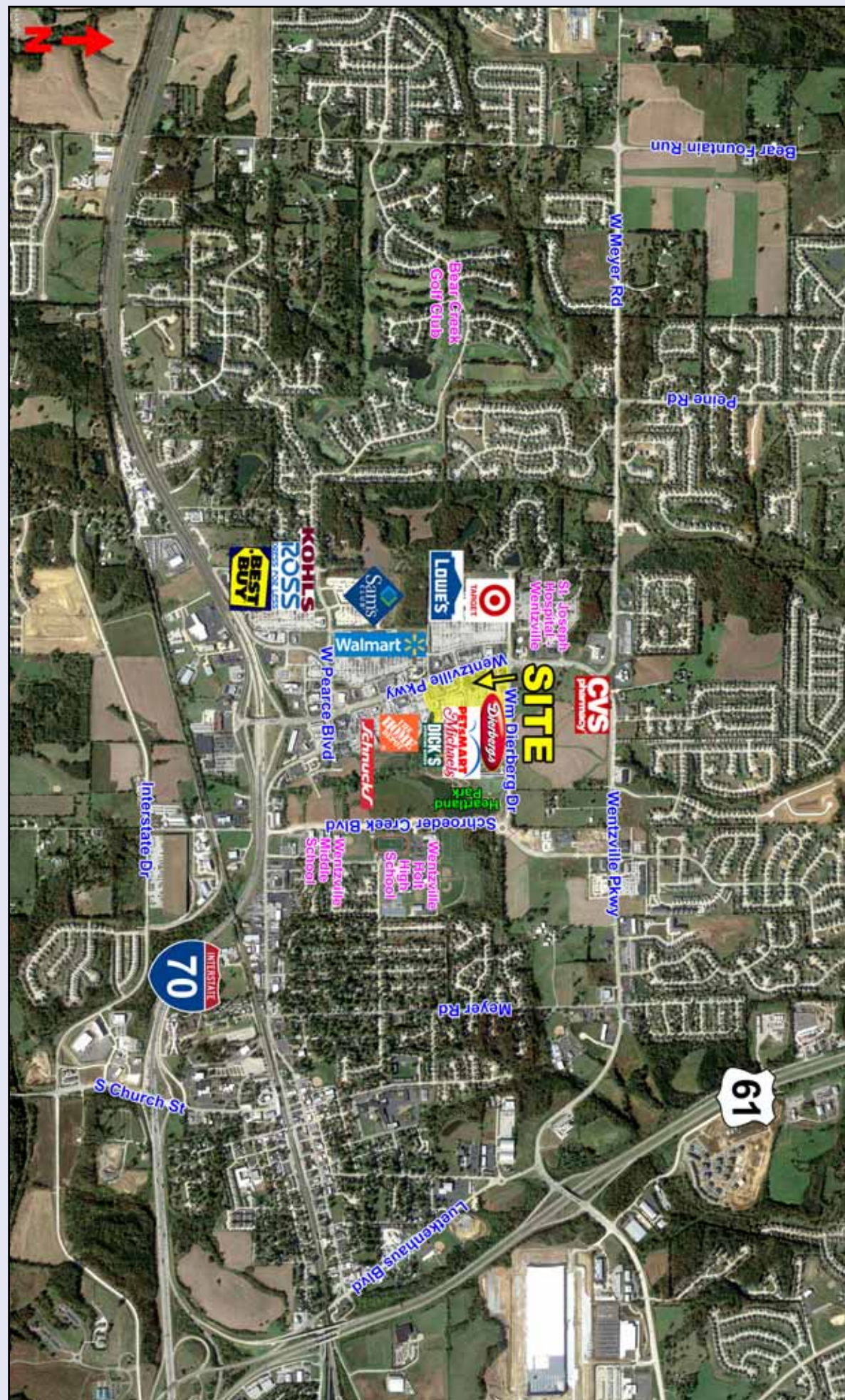

11850 Studt Avenue
P.O. Box 419121
St. Louis, Missouri 63141
Telephone: (314)991-8900
Fax: (314)991-2474

The information contained herein was obtained from sources deemed reliable, however, Capitol Realty Group makes no guarantees as to the completeness or accuracy thereof. This information is subject to error, omission, change in price or conditions, prior sale or lease, or withdrawal without notice.

	Demographics	1-Mile	3-Mile	5-Mile
2020 Population		5,825	38,060	57,585
2020 Households		2,106	13,159	20,417
2020 Avg. Household Income		\$104,916	\$109,259	\$110,898

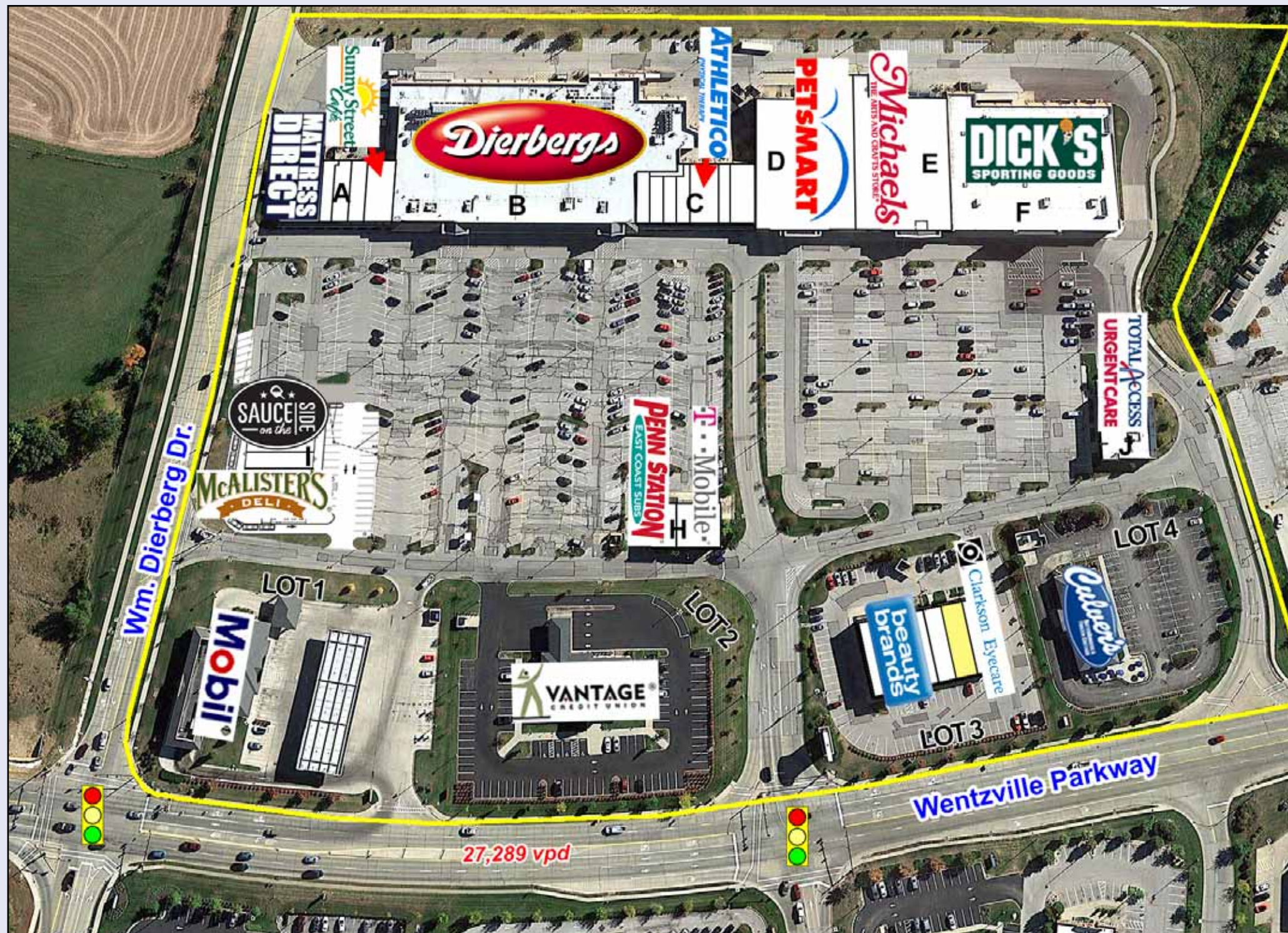

<u>Bldg.</u>	<u>Tenant</u>	<u>Sq. Ft.</u>
A	Mattress Direct Fantastic Sams Investors Title Victorian Nails Sunny Street Cafe'	4,000 1,227 1,538 1,600 2,838
B	Dierbergs	66,756
C	Apple Cleaners Edward Jones CPR Southwest Hearing Pro Rehab Marshall Wireless Dr. Kraner, DDS	1,076 1,160 956 1,282 2,885 1,200 2,341
D	Petsmart	22,743
E	Michaels	21,683
F	Dick's Sporting Goods	35,116
H	Penn Station T-Mobile	1,524 2,498
I	Sauce on the Side Profile by Sanford McAlister's Deli	2,895 1,605 4,189
J	Total Access Urgent Care	4,997

<u>Outlot</u>	<u>Tenant</u>	<u>Size</u>
Lot 1	Mobil	2.01 ac
Lot 2	Vantage Credit Union	1.98 ac
Lot 3	Beauty Brands Supplement Superstore	5,982 sf 1,597 sf
	Available	2,015 sf
	Clarkson Eyecare	2,402 sf
Lot 4	Culver's	1.33 ac

Updated 02/20/20

