



**715 SOUTH POINT
PETALUMA | CA**

WAREHOUSE & OFFICE AVAILABLE

Trevor Buck

Executive Director
+1 415 451 2436
trevor.buck@cushwake.com
LIC #01255462

Steven Leonard

Managing Director
+1 415 451 2434
steven.leonard@cushwake.com
LIC #00909604

Brian Foster

Managing Director
+1 415 451 2437
brian.foster@cushwake.com
LIC #01393059

Property Highlights:

- Dock high loading
- 24' minimum clear height
- Divisible
- Yard and extra parking potentially available
- 3 grade level roll-up doors
- Office areas with multiple entrance access
- Freeway visibility
- Easy access

Office Space: ±10,715 Sq. Ft. of 2nd floor space (divisible)

Warehouse Space: ±19,222 Sq. Ft.

(divisible) (Main building)

±8,000 Sq. Ft. ± 1 acre secure fenced yard (Back building)

Asking Rent:

\$1.25 Offices PSF NNN

\$1.15 Warehouse PSF NNN

View Site Specific COVID-19 Prevention Plan

**715 SOUTH POINT
PETALUMA | CA**

WAREHOUSE & OFFICE AVAILABLE

Trevor Buck

Executive Director

+1 415 451 2436

trevor.buck@cushwake.com

LIC #01255462

Steven Leonard

Managing Director

+1 415 451 2434

steven.leonard@cushwake.com

LIC #00909604

Brian Foster

Managing Director

+1 415 451 2437

brian.foster@cushwake.com

LIC #01393059

FOR LEASE
1ST FLOOR | 19,222 SQ. FT.

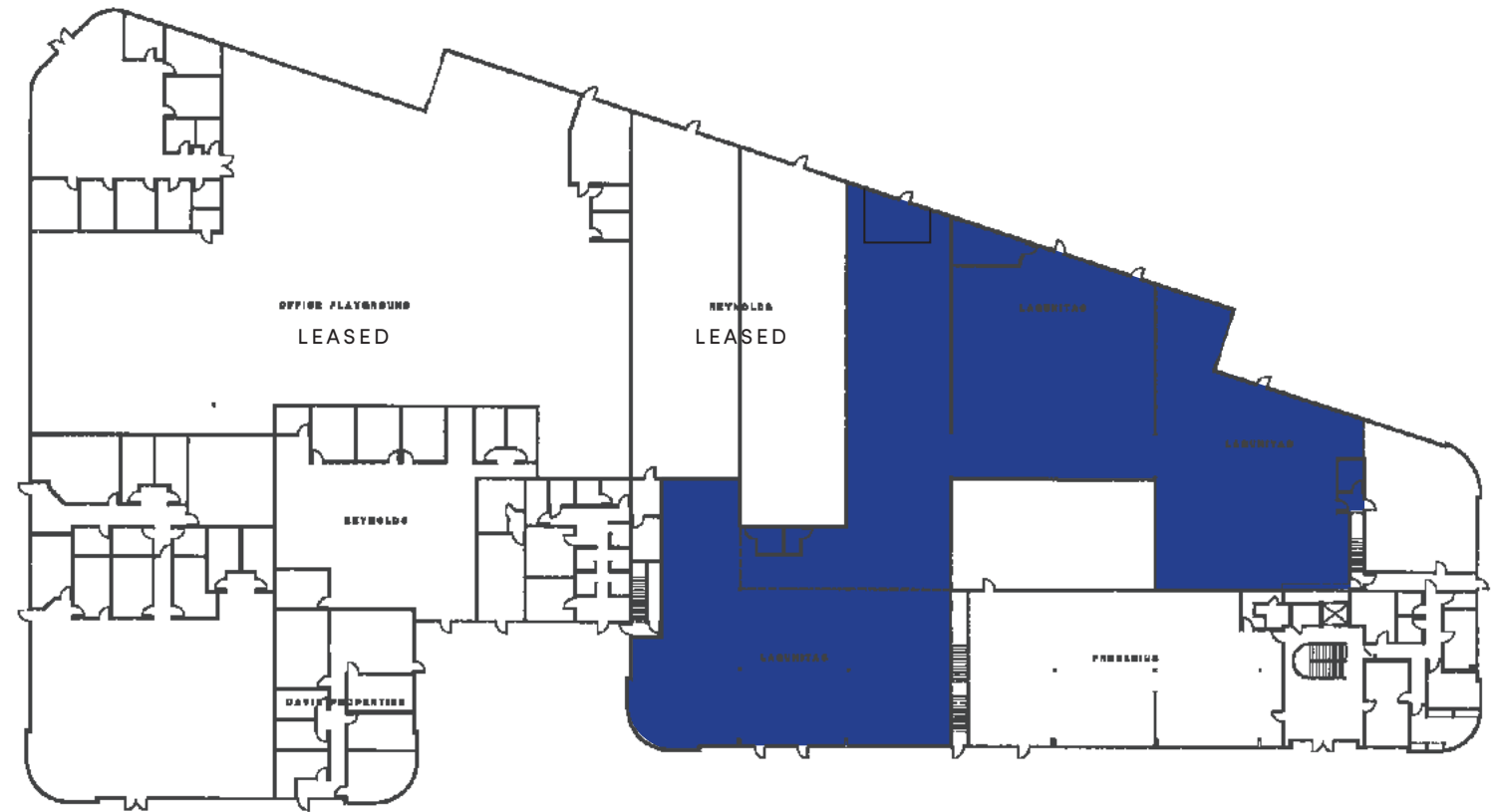

AVAILABLE - 

715 SOUTH POINT
PETALUMA | CA

WAREHOUSE & OFFICE AVAILABLE

Trevor Buck
Executive Director
+1 415 451 2436
trevor.buck@cushwake.com
LIC #01255462

Steven Leonard
Managing Director
+1 415 451 2434
steven.leonard@cushwake.com
LIC #00909604

Brian Foster
Managing Director
+1 415 451 2437
brian.foster@cushwake.com
LIC #01393059



FOR LEASE
2ND FLOOR | 10,715 SQ. FT.

AVAILABLE - 



715 SOUTH POINT
PETALUMA | CA

WAREHOUSE & OFFICE AVAILABLE

Trevor Buck
Executive Director
+1 415 451 2436
trevor.buck@cushwake.com
LIC #01255462

Steven Leonard
Managing Director
+1 415 451 2434
steven.leonard@cushwake.com
LIC #00909604

Brian Foster
Managing Director
+1 415 451 2437
brian.foster@cushwake.com
LIC #01393059



**±8,000 SQ. FT.
WAREHOUSE ON ±1 ACRE
AVAILABLE**

**715 SOUTH POINT
PETALUMA | CA**

WAREHOUSE & OFFICE AVAILABLE

Trevor Buck
Executive Director
+1 415 451 2436
trevor.buck@cushwake.com
LIC #01255462

Steven Leonard
Managing Director
+1 415 451 2434
steven.leonard@cushwake.com
LIC #00909604

Brian Foster
Managing Director
+1 415 451 2437
brian.foster@cushwake.com
LIC #01393059