

675 EAST MIDDLEFIELD ROAD

MOUNTAIN VIEW | ±20,000 - 58,584 SF PLUG AND PLAY SUBLEASE



Rob Souza
+1 408 615 3448
LIC#: 01916129

Bob Simpson
+1 408 615 3421
LIC#: 01240540

Todd Beatty
+1 408 615 3418
LIC#: 00976940

Dave Hiebert
+1 650 320 0250
LIC#: 01189320



PROJECT HIGHLIGHTS

- Full Building Available (\$4.99/sf NNN)
- Flexible Size: 20,000 - 58,584 SF
- Flexible Sublease Term
- Premier Class A improved interiors with T24 LED lighting
- Fully furnished and wired with sit-stand benching workstations
- Collaborative outdoor area with seating and volleyball court
- Exceptional corporate tenant neighborhood
- Close proximity to Highway 237, US 101 and Central Expressway
- Abundant parking with 3.6/1000 ratio
- Onsite EV charging stations
- VTA Lightrail station directly adjacent to property

AMENITIES MAP

RESTAURANTS

- 1 Zucca
- 2 Golden Wok
- 3 Chez TJ
- 4 Fiesta Del Mar Too
- 5 Spice Island
- 6 St. Stephen's Green
- 7 Cafe' Yulong
- 8 Dana Street Roasting
- 9 Sushi Tomi
- 1 Temptations
- 2 TK Noodle
- 3 Cascal
- 4 Cantankerous Fish
- 5 Starbucks
- 6 Carl's Jr.
- 7 Roger's Deli
- 8 Clock Tower Cafe
- 9 Symantec Cafeteria
- 10 Specialty's Bakery & Cafe
- 11 Peet's Coffee & Tea
- 12 Lookout Restaurant
- 13 Minerva Cafe
- 14 Sushi Club
- 15 Senior Jalapeno
- 16 Cafe Dolce
- 17 Subway
- 18 Jamba Juice
- 19 Round Table Pizza
- 20 Specialty's Cafe & Bakery

HOTELS

- 1 Pacific Euro Hotel
- 2 Holiday Inn Express

BANKS

- 1 Bank of America
- 2 Wells Fargo
- 3 Chase
- 4 Tech Credit Union

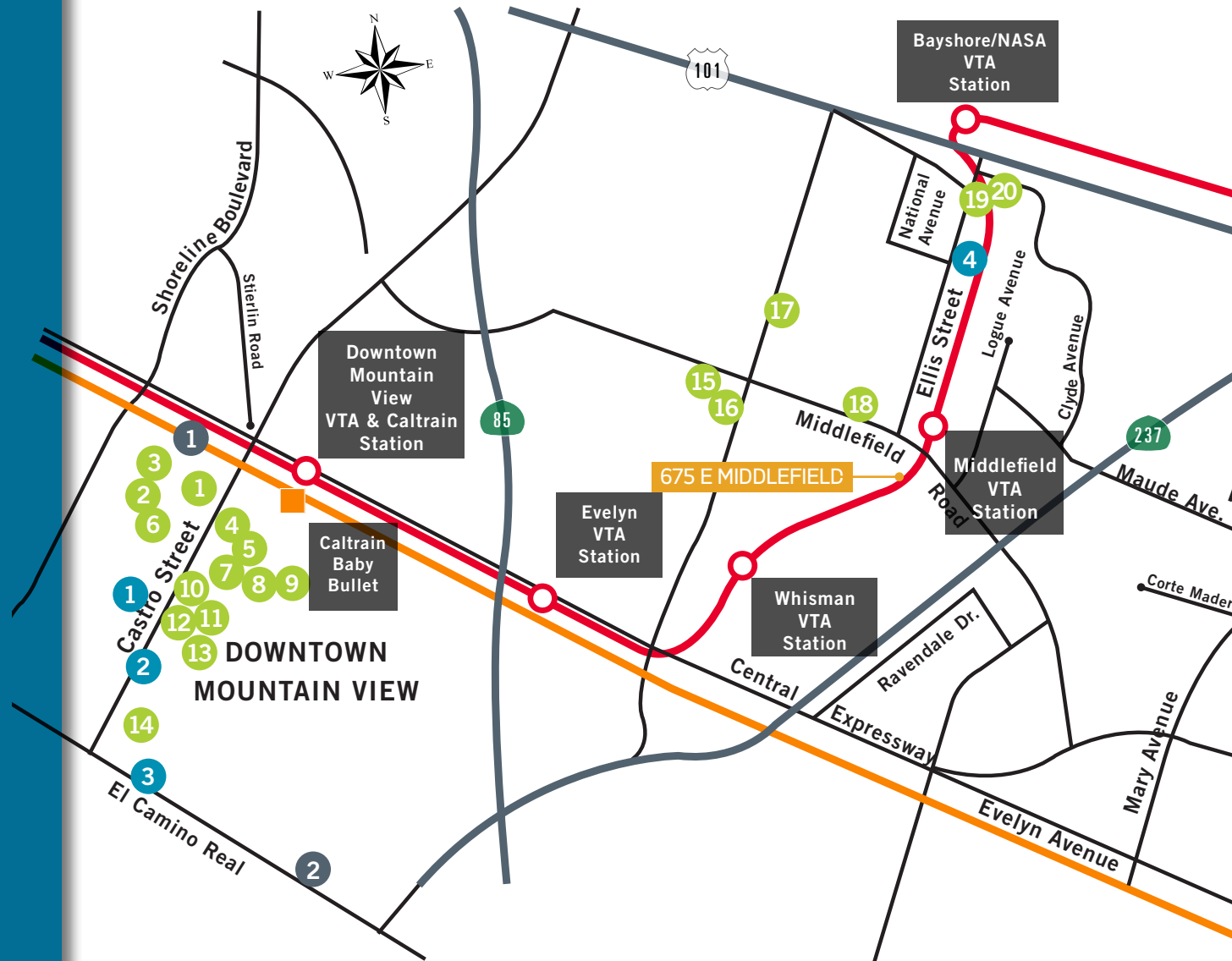

- VTA Light Rail Stations
- Caltrain

EXISTING AS-BUILT

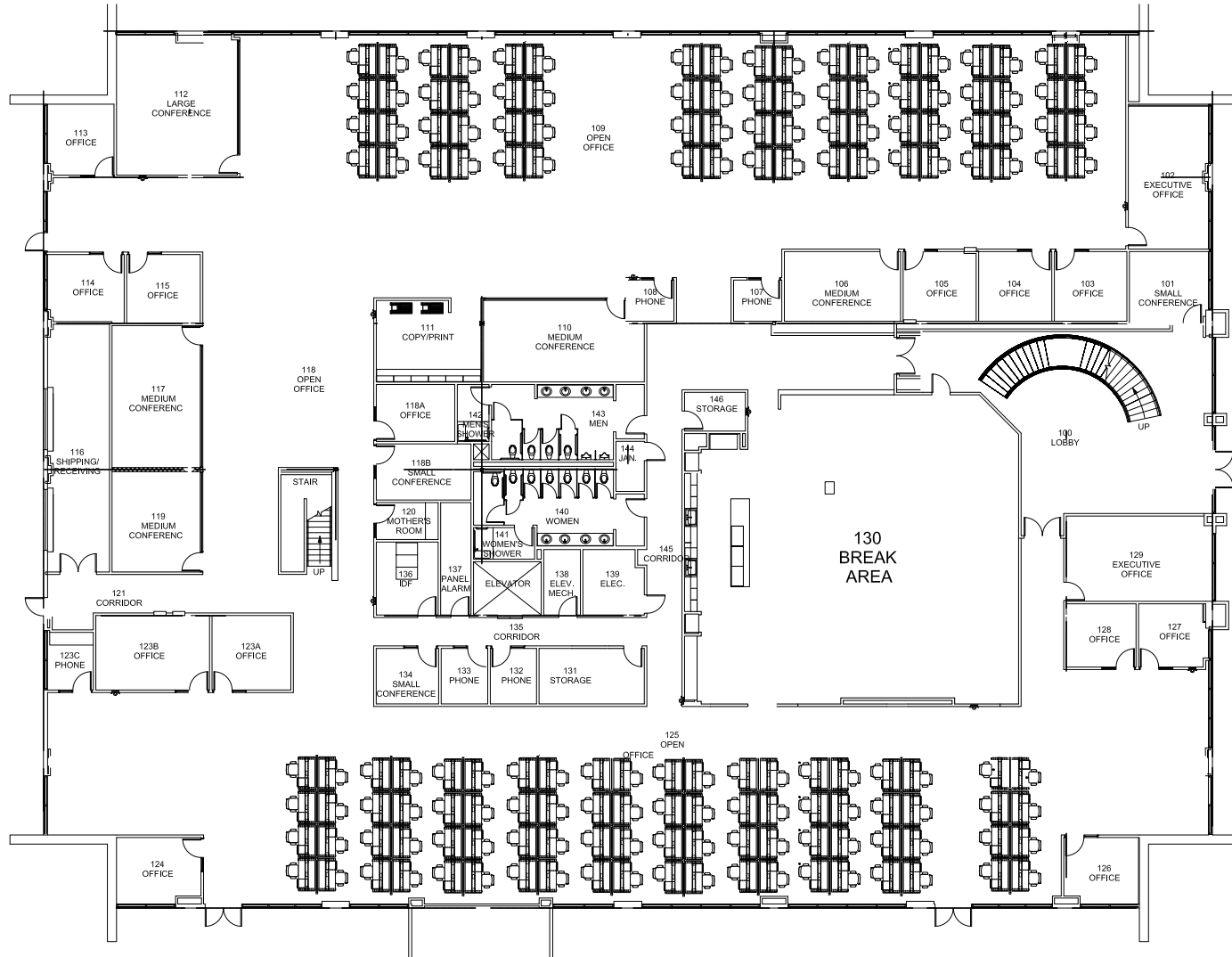

1ST FLOOR | 29,292 ± Square feet

EXISTING AS-BUILT

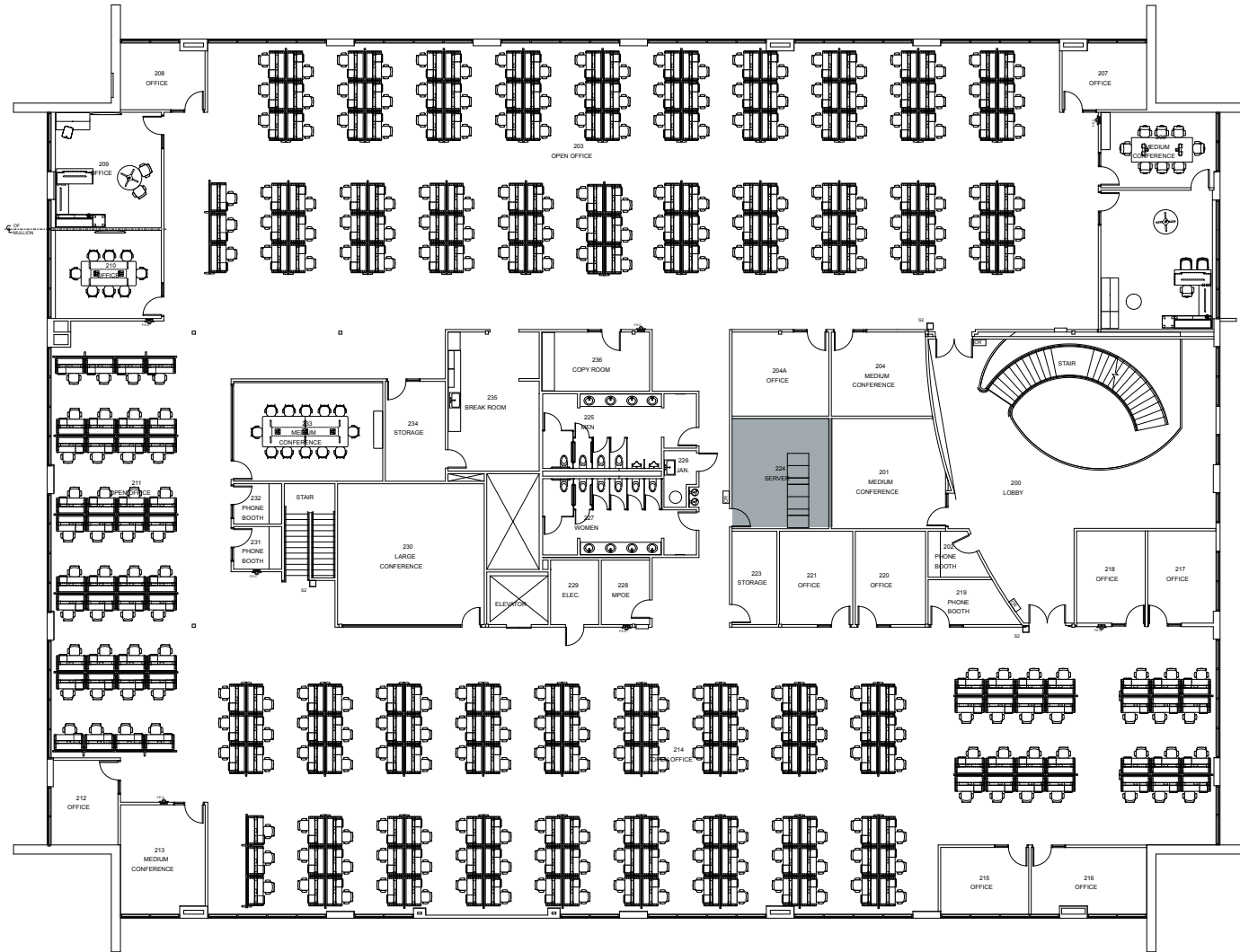

■ NOT A PART

2ND FLOOR | 29,292 ± Square feet

675 EAST MIDDLEFIELD ROAD

MOUNTAIN VIEW | ±20,000 - 58,584 SF PLUG AND PLAY SUBLEASE



Rob Souza
+1 408 615 3448
LIC#: 01916129

Bob Simpson
+1 408 615 3421
LIC#: 01240540

Todd Beatty
+1 408 615 3418
LIC#: 00976940

Dave Hiebert
+1 650 320 0250
LIC#: 01189320