

2020 Patton Chapel Road

Hoover, Alabama 35216



Building Features

- + **2,806 SF** former bank branch on **0.88 AC**
- + Sale Price - **\$1,000,000**
- + Located near the Montgomery Highway (Highway 31) intersection.
 - Over 8,000 VPD on Patton Chapel Road
 - 34,000 VPD on Montgomery Highway
- + Surrounded by major retailers including Walmart, TJ Maxx, Home Goods, Burlington, Party City, Walgreens, and more.
- + Site will be deed restricted for 5 years against other financial institutions.

Contact Us

Shannon Tyndall

Vice President

+1 205 563 4583

shannon.tyndall@cbre.com

Floor Plan

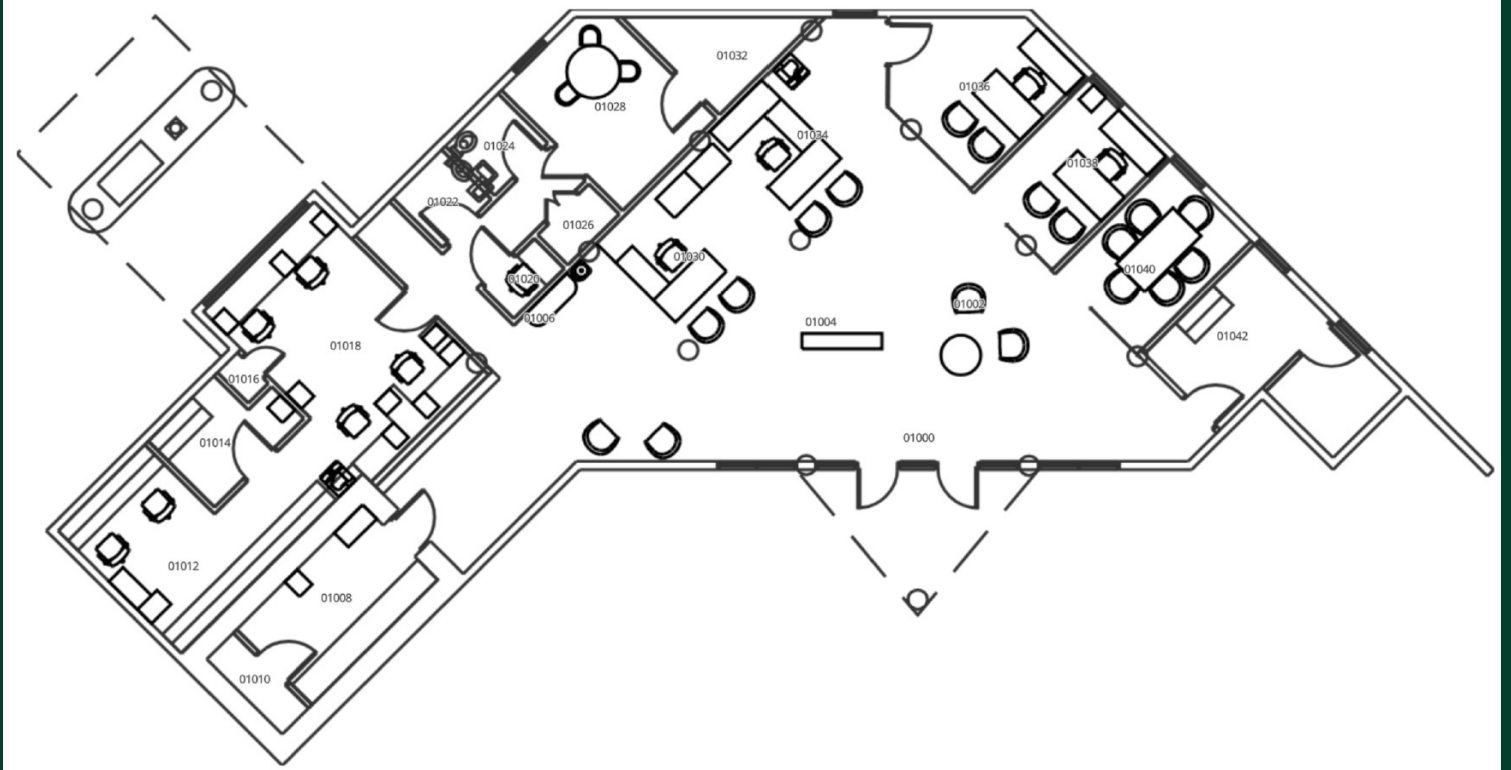

© 2022 CBRE, Inc. All rights reserved. This information has been obtained from sources believed reliable, but has not been verified for accuracy or completeness. You should conduct a careful, independent investigation of the property and verify all information. Any reliance on this information is solely at your own risk. CBRE and the CBRE logo are service marks of CBRE, Inc. All other marks displayed on this document are the property of their respective owners, and the use of such logos does not imply any affiliation with or endorsement of CBRE. Photos herein are the property of their respective owners. Use of these images without the express written consent of the owner is prohibited.

Area Retail

