

FOR LEASE

OFFICE/WAREHOUSE 4127 Silver Star Road, Orlando 32808



Rental Rate

\$3,900/mo.

Modified Gross

Silver Star Road

OFFICE/WAREHOUSE SPACE for LEASE

- 4,800 Square Feet - office/restroom
- 2 Dock High Doors - Cross dock
- Zoned I-G, City of Orlando
- Outside Storage possible
- Sprinklered; upgraded electric power
- **AVAILABLE September, 2020**

CONTACT EXCLUSIVE AGENT:

Jeff Gindi, Broker/Principal

407.925.4464 Cell

JeffGindi@ResultsREPartners.com

RESULTS REAL ESTATE PARTNERS, LLC

Licensed Commercial Real Estate Brokers

108 Commerce St, Suite 200

Lake Mary, FL 32746

Office (407) 647-0200

Fax (407) 647-0205

www.ResultsREPartners.com



This information is from sources we deem reliable and is subject to prior sale, lease, withdrawal without notice, or change in prices, rates, or conditions.
No representation is made as to the accuracy of any information furnished.

LOCATOR MAP

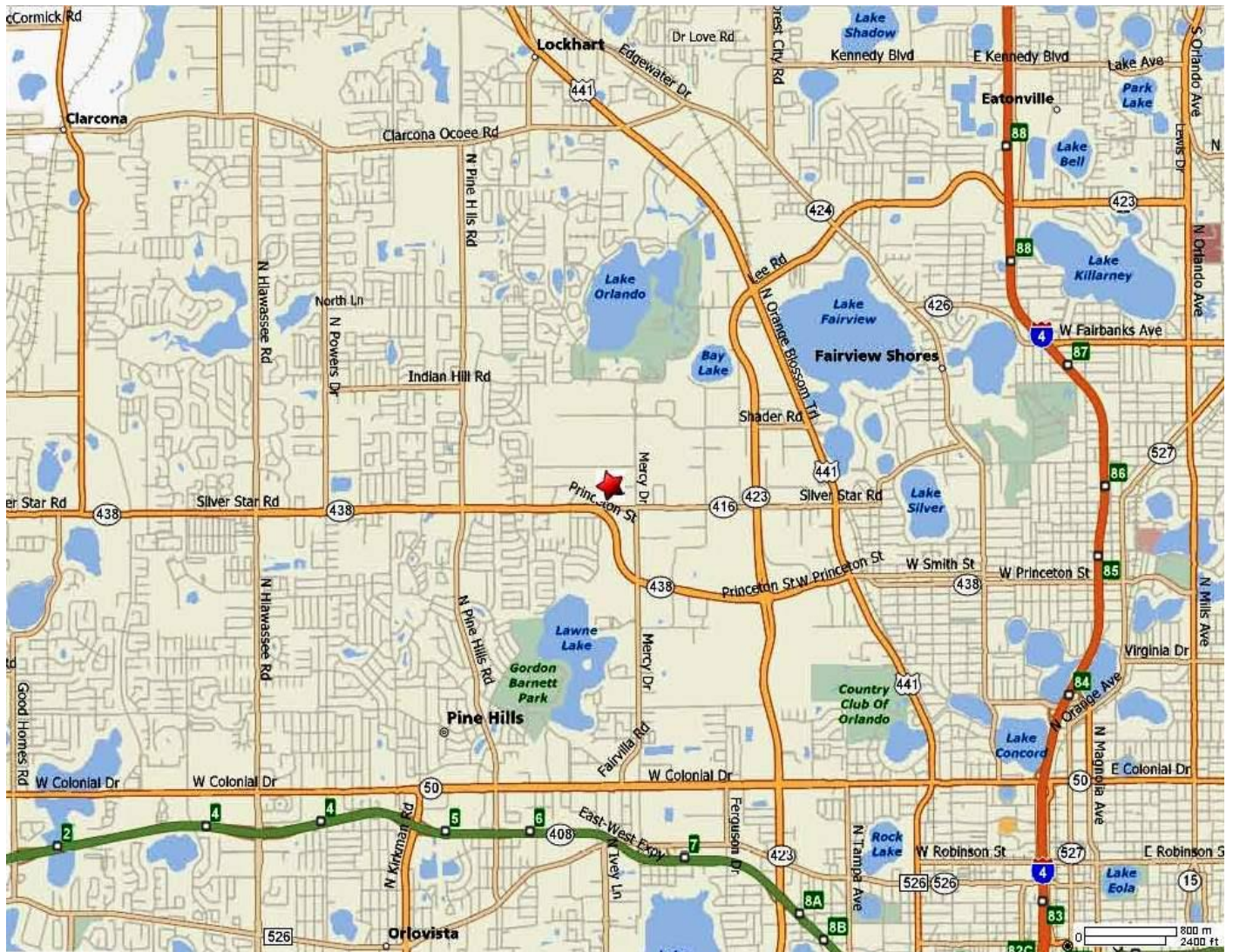

CONTACT EXCLUSIVE AGENT:

Jeff Gindi, Broker/Principal

407.925.4464 Cell

JeffGindi@ResultsREPartners.com



RESULTS REAL ESTATE PARTNERS, LLC

Licensed Commercial Real Estate Brokers

108 Commerce St, Suite 200

Lake Mary, FL 32746

Office (407) 647-0200

Fax (407) 647-0205

www.ResultsREPartners.com

This information is from sources we deem reliable and is subject to prior sale, lease, withdrawal without notice, or change in prices, rates, or conditions. No representation is made as to the accuracy of any information furnished.

FLOOR PLAN

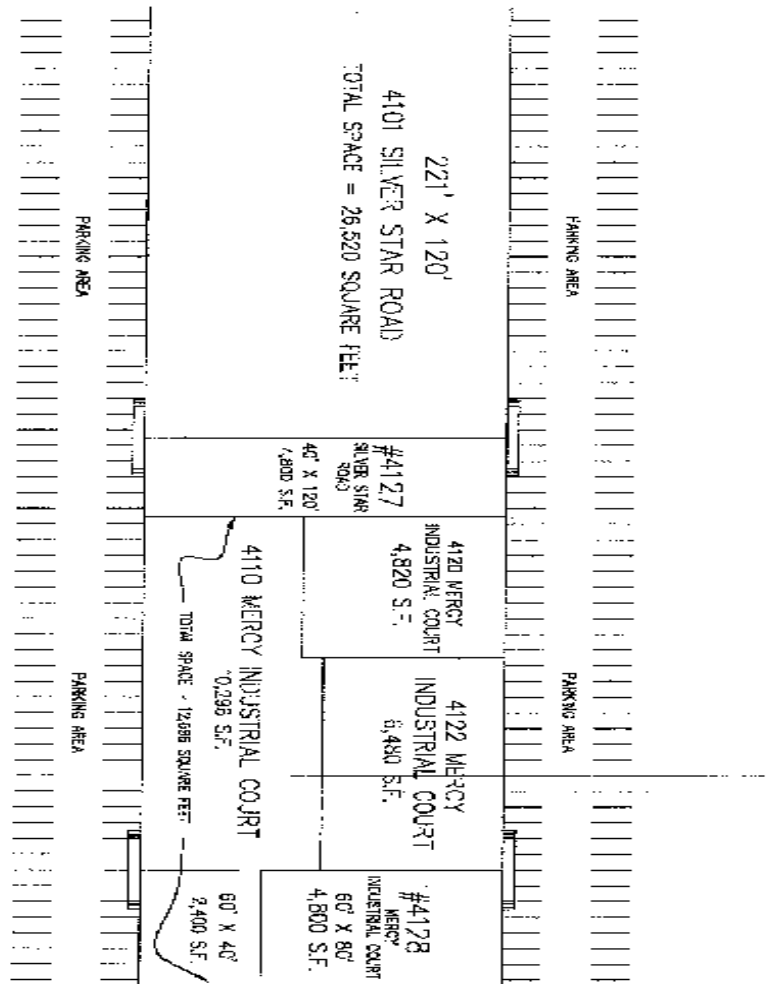

CONTACT EXCLUSIVE AGENT:

Jeff Gindi, Broker/Principal

407.925.4464 Cell

JeffGindi@ResultsREPartners.com

RESULTS REAL ESTATE PARTNERS, LLC

Licensed Commercial Real Estate Brokers

108 Commerce St, Suite 200

Lake Mary, FL 32746

Office (407) 647-0200

Fax (407) 647-0205

www.ResultsREPartners.com



This information is from sources we deem reliable and is subject to prior sale, lease, withdrawal without notice, or change in prices, rates, or conditions. No representation is made as to the accuracy of any information furnished.

FLOOR PLAN

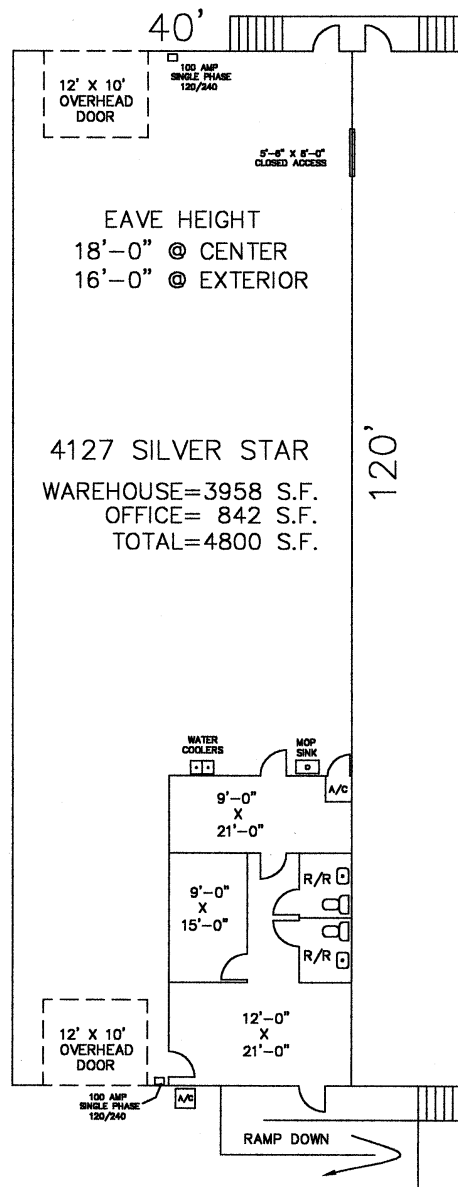

CONTACT EXCLUSIVE AGENT:

Jeff Gindi, Broker/Principal

407.925.4464 Cell

JeffGindi@ResultsREPartners.com



RESULTS REAL ESTATE PARTNERS, LLC

Licensed Commercial Real Estate Brokers

108 Commerce St, Suite 200

Lake Mary, FL 32746

Office (407) 647-0200

Fax (407) 647-0205

www.ResultsREPartners.com

This information is from sources we deem reliable and is subject to prior sale, lease, withdrawal without notice, or change in prices, rates, or conditions. No representation is made as to the accuracy of any information furnished.