



PRIME RETAIL SPACE IN VENICE CALIFORNIA

709 LINCOLN BOULEVARD, VENICE, CA 90291

David Ashkenasy
Senior Managing Director
Phone: 310.272.7381
Email: davida@cag-re.com
Lic: 01714442

Alex Shabani
Senior Managing Director
Phone: 310.272.7397
Email: alex@cag-re.com
Lic: 01352902

cag | COMMERCIAL
ASSET GROUP



BUSY THRU-FAIR LINCOLN BLVD RETAIL AVAILABLE

709 LINCOLN BOULEVARD, VENICE, CA 90291

Highlights

- Approximately 1,496 SQ FT Retail Space on Lincoln Blvd Corridor Available
- Excellent Curb Appeal & Signage
- Additional Parking in Rear
- Ideal for Beauty Supply, Tax or Insurance, Torturing Center, Personal Training, Hair Salon, Cell Phone
- Busy High Traffic Street
- High Profile Lincoln Location
- CPD: 55,000
- Adjacent to Countless Eateries, Cafés and Numerous National Retailers
- Dense Population Demographics, Population: 1 Mile Radius 38,000

Space SF: +/- 1,498 RSF

Rental Rate: \$2.95 NNN

SITE PLAN

709 LINCOLN BOULEVARD, VENICE, CA 90291

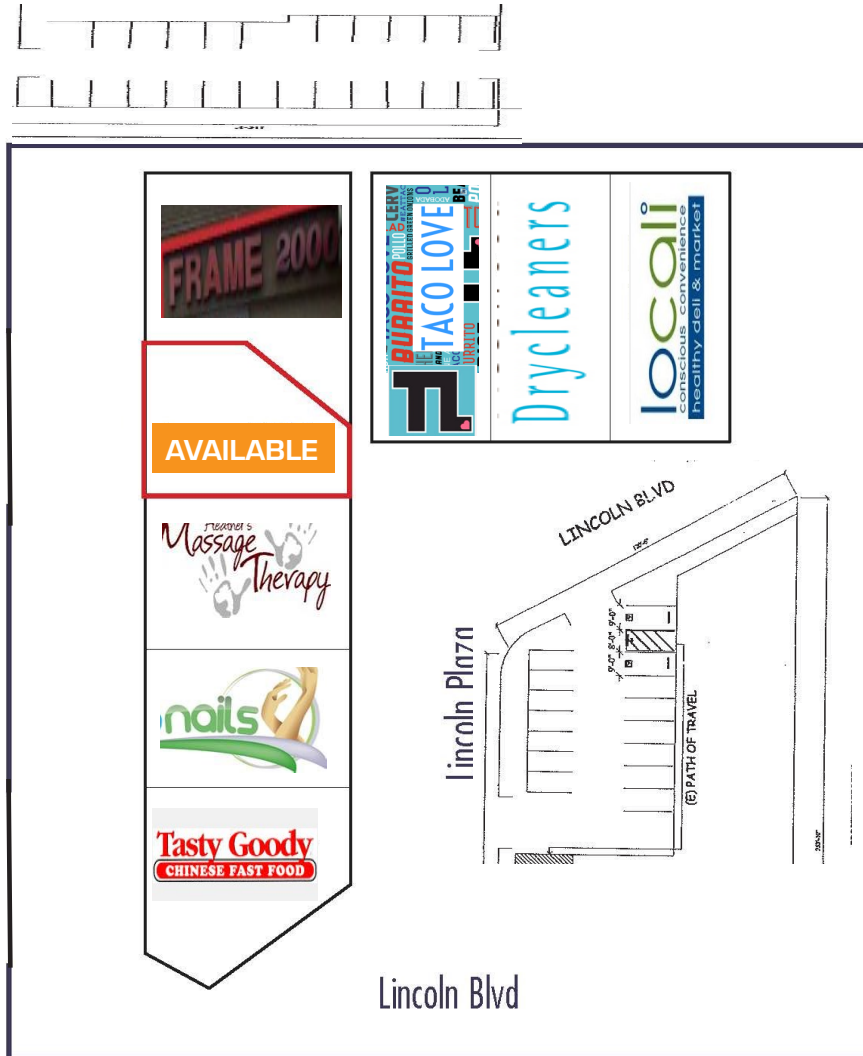

Size: 1,496 SF
Parking: 39 Spaces for Center
Total Bldg Size: 10,880 SF

ADDITIONAL PHOTOS

709 LINCOLN BOULEVARD, VENICE, CA 90291



* ADDITIONAL PARKING IN REAR

AERIAL

709 LINCOLN BOULEVARD, VENICE, CA 90291

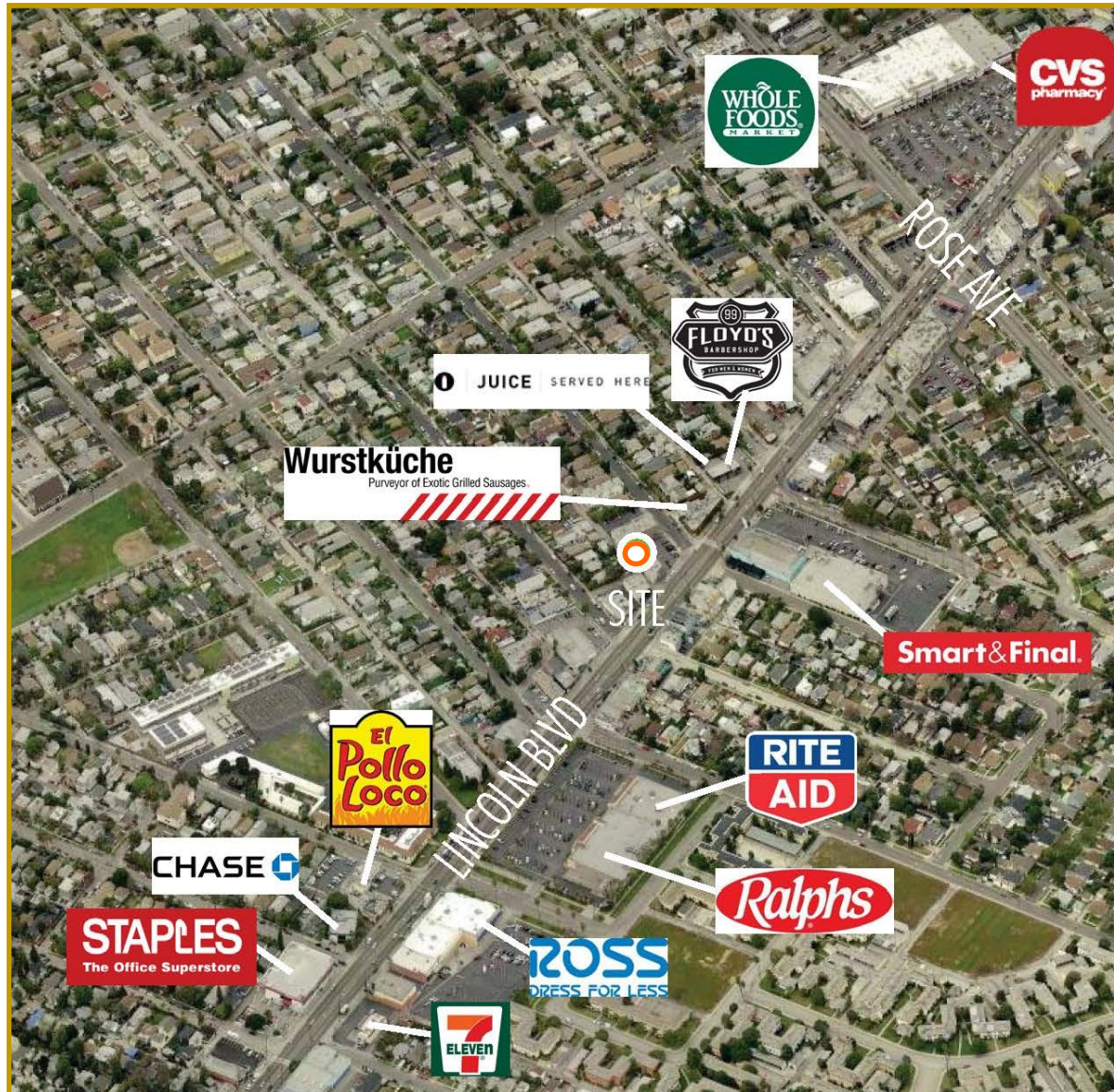

AERIAL

709 LINCOLN BOULEVARD, VENICE, CA 90291

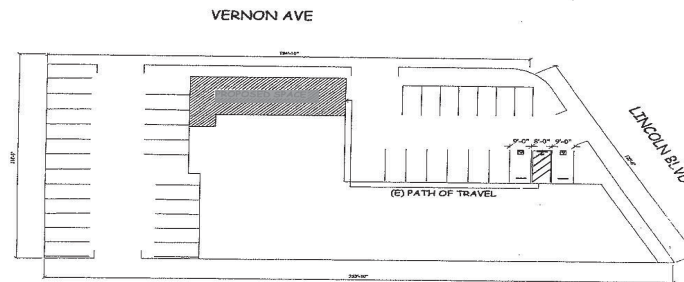

SITE PLAN
1/4" = 1'

DEMOGRAPHICS

709 LINCOLN BOULEVARD, VENICE, CA 90291

Demographic Snapshot Comparison Report for My Site, 709 Lincoln Blvd, Venice, CA, 90291:

	1 mile(s)	3 mile(s)	5 mile(s)
Population: 2015A			
Total Population	38,018	233,875	489,807
Female Population	49.10%	50.31%	51.24%
Male Population	50.90%	49.69%	48.76%
Population Density	12,100	8,270	6,236
Population Median Age	39.2	38.9	38.0
Employed Civilian Population 16+	22,548	130,522	270,512
% White Collar	79.4%	79.5%	81.0%
% Blue Collar	20.6%	20.5%	19.0%
Total Employees	13,352	136,713	344,009
Total Establishments*	2,434	19,274	39,110
Population Growth 2000-2010	-6.00%	4.66%	4.97%
Population Growth 2015A-2020	-0.08%	2.50%	2.29%
Income: 2015A			
Average Household Income	\$110,686	\$106,969	\$116,076
Median Household Income	\$68,633	\$67,245	\$71,300
Per Capita Income	\$56,137	\$54,477	\$56,243
Avg Income Growth 2000-2010	51.27%	45.64%	36.45%
Avg Income Growth 2015A-2020	16.42%	16.35%	15.24%
Households: 2015A			
Households	19,189	118,529	235,622
Average Household Size	1.96	1.95	2.03
Hhld Growth 2000-2010	-5.81%	5.39%	4.65%
Hhld Growth 2015A-2020	0.03%	3.09%	2.78%
Housing Units: 2015A			
Occupied Units	19,189	118,529	235,622
% Occupied Units	94.15%	96.57%	97.05%
% Vacant Housing Units	5.85%	3.43%	2.95%
Owner Occ Housing Growth 2000-2010	0.79%	6.82%	5.47%
Owner Occ Housing Growth 2000-2020	1.38%	10.15%	8.88%
Owner Occ Housing Growth 2015A-2020	-0.65%	2.16%	1.74%
Occ Housing Growth 2000-2010	-5.81%	5.39%	4.65%
Occ Housing Growth 2010-2020	6.01%	9.56%	8.65%
Occ Housing Growth 2015A-2020	0.03%	3.09%	2.78%
Race and Ethnicity: 2015A			
% American Indian or Alaska Native Population	0.62%	0.56%	0.44%
% Asian Population	5.53%	12.49%	14.56%
% Black Population	4.56%	4.30%	4.79%
% Hawaiian or Pacific Islander Population	0.17%	0.18%	0.17%
% Multirace Population	4.87%	5.27%	5.56%
% Other Race Population	7.40%	7.91%	6.77%
% White Population	76.85%	69.29%	67.70%
% Hispanic Population	19.19%	20.30%	17.54%
% Non Hispanic Population	80.81%	79.70%	82.46%



For more information, please call.



1801 Century Park East, Suite 1420
Los Angeles, California 90067
Phone 310.275.8222 Fax 310.275.8223
www.cag-re.com
License #01876070

Alex Shabani
Senior Managing Director
Phone: 310.272.7397
Email: alex@cag-re.com
Lic: 01352902

These materials are based on information and content provided by others, which we believe are accurate. No guarantee, warranty or representation is made by Commercial Asset Group, Inc. or its personnel. All interested parties must independently verify accuracy and completeness. As well, any projections, assumptions, opinion, or estimates are used for example only and do not represent the current or future performance of the identified property. Your tax, financial, legal and toxic substance advisors should conduct a careful investigation of the property and its suitability for your needs, including land use limitations. The property is subject to prior lease, sale, change in price, or withdrawal from the market without notice.