

# FOR LEASE MEDICAL SUITE

**CORONA CORPORATE CENTRE - 2,945 SF**

2083 Compton Avenue , Suite 201  
Corona, CA 92881

**FREEWAY SIGNAGE AVAILABLE**

**DESIGN YOUR OWN SUITE**



## BUILDING FEATURES

- Premier Medical Corner Unit
- Design your suite
- Direct Access to the 15 Freeway
- Adjacent to Numerous Retail Amenities
- Opportunity to Custom Design Space
- Excellent Freeway Access
- Building Top Freeway Signage Available



### ESTIMATED 2016 POPULATION

5 Mile Radius

**203,820**



### MEDIAN HOUSEHOLD INCOME

5 Mile Radius

**\$90,000**



### DAYTIME POPULATION

5 Mile Radius

**92,297**



### TRAFFIC COUNTS

Ontario Ave & Compton Ave

**46K MPSI**

\*Source: Regis

## CONTACT

**ANDREW PEAKE**

951.276.3644

apeake@lee-associates.com

License ID# 01398894

**THOMAS P. PIERIK, SIOR**

951.276.3610

tpierik@lee-associates.com

License ID# 00982027

Lee & Associates Commercial Real Estate Services, Inc. - Riverside.

4193 Flat Rock Drive, Suite 100 Riverside, CA 92505 | Corporate ID# 01048055

No warranty or representation has been made to the accuracy of the foregoing information. Terms of sale or lease and availability are subject to change or withdrawal without notice.

**LEE & ASSOCIATES**

COMMERCIAL REAL ESTATE SERVICES

Corporate ID# 01048055

# FOR LEASE MEDICAL SUITE

**CORONA CORPORATE CENTRE - 2,945 SF**

2083 Compton Avenue , Suite 201  
Corona, CA 92881

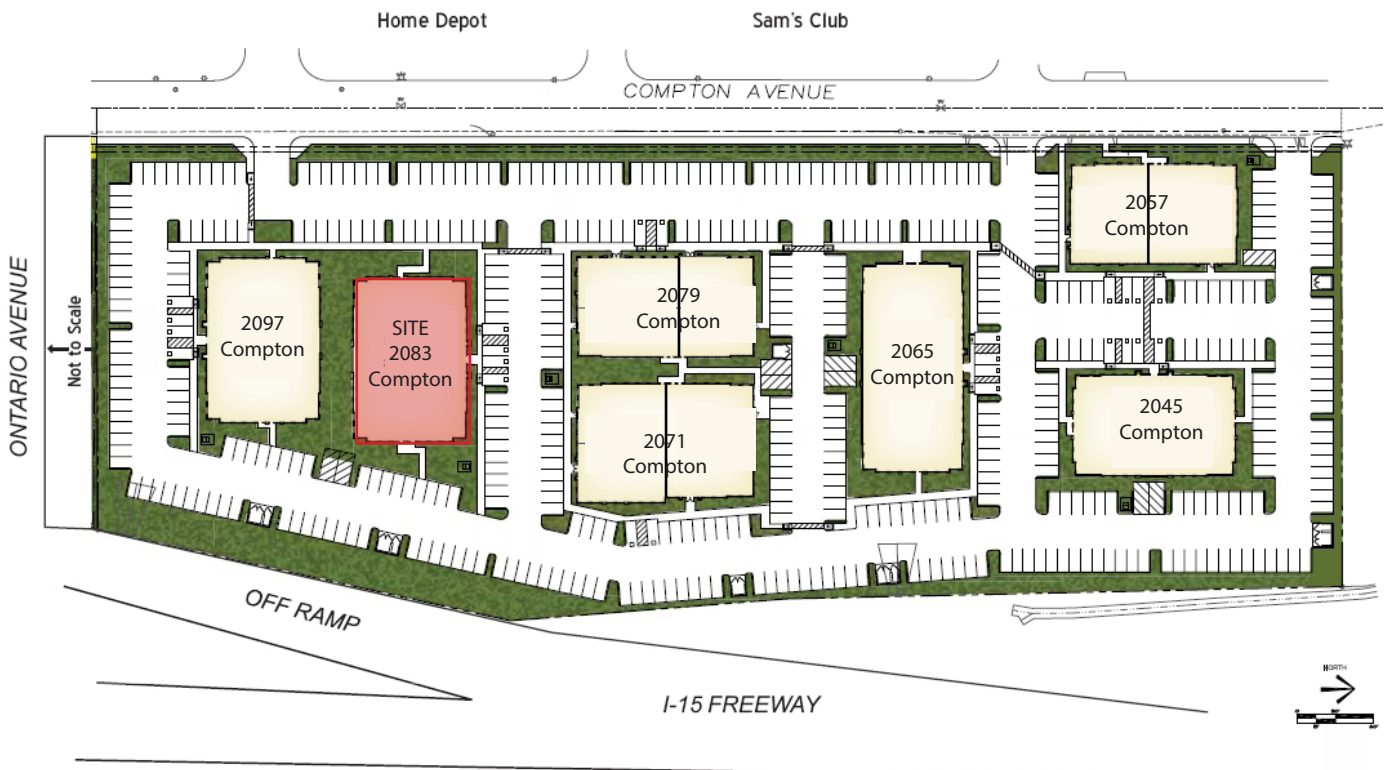
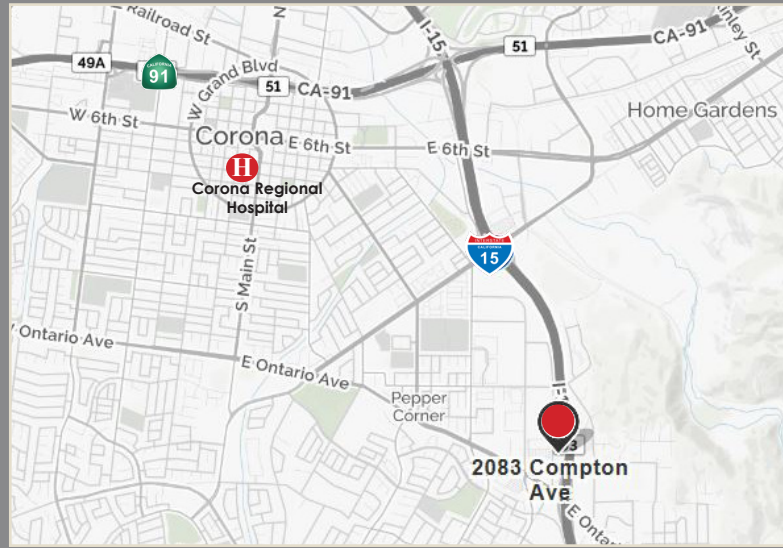

## CONTACT

**ANDREW PEAKE**

951.276.3644

[apeake@lee-associates.com](mailto:apeake@lee-associates.com)

License ID# 01398894

**THOMAS P. PIERIK, SIOR**

951.276.3610

[tpierik@lee-associates.com](mailto:tpierik@lee-associates.com)

License ID# 00982027

Lee & Associates Commercial Real Estate Services, Inc. - Riverside.

4193 Flat Rock Drive, Suite 100 Riverside, CA 92505 | Corporate ID# 01048055

No warranty or representation has been made to the accuracy of the foregoing information. Terms of sale or lease and availability are subject to change or withdrawal without notice.



Corporate ID# 01048055