

# FOR LEASE

# 160-170 VANDER STREET, CORONA CA



## LISTING HIGHLIGHTS:

- » 170 VANDER ST., UNIT AB - ±3,818 SF AVAILABLE
- » RECEPTION, 2 PRIVATE OFFICES, KITCHENETTE, 2 RR'S, & 2 GL DOORS
- » 2 MULTI TENANT INDUSTRIAL BUILDINGS TOTALING ±28,025 SQUARE FEET
- » AMPLE PARKING ON-SITE
- » GROUND LEVEL LOADING
- » EASY ACCESS TO THE 91, 71, & I-15 FREEWAYS

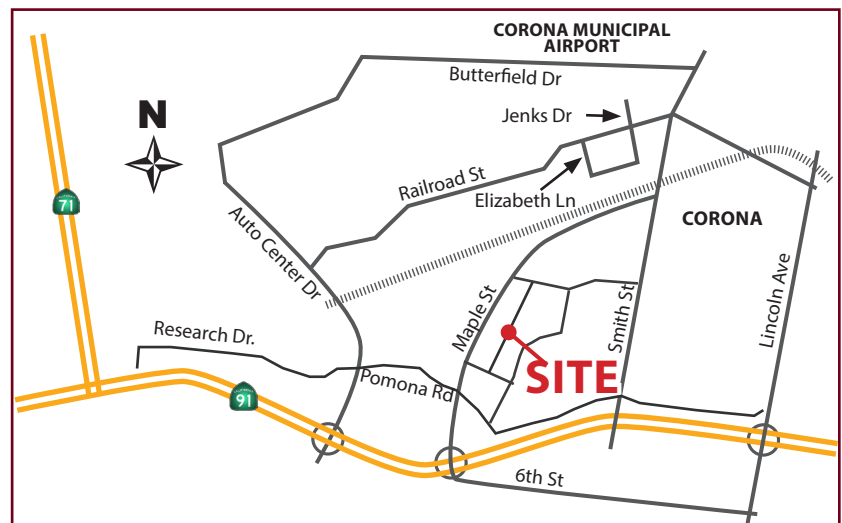

**LEE & ASSOCIATES®**  
COMMERCIAL REAL ESTATE SERVICES

**TOBY TEWELL**

951.276.3662

TTEWELL@LEERIVERSIDE.COM | LICENSE #01822772

**JEFF RUSCIGNO, SIOR**

951.276.3630

JRUSCIGNO@LEERIVERSIDE.COM | LICENSE #001030286

# FOR LEASE

# 160-170 VANDER STREET, CORONA CA

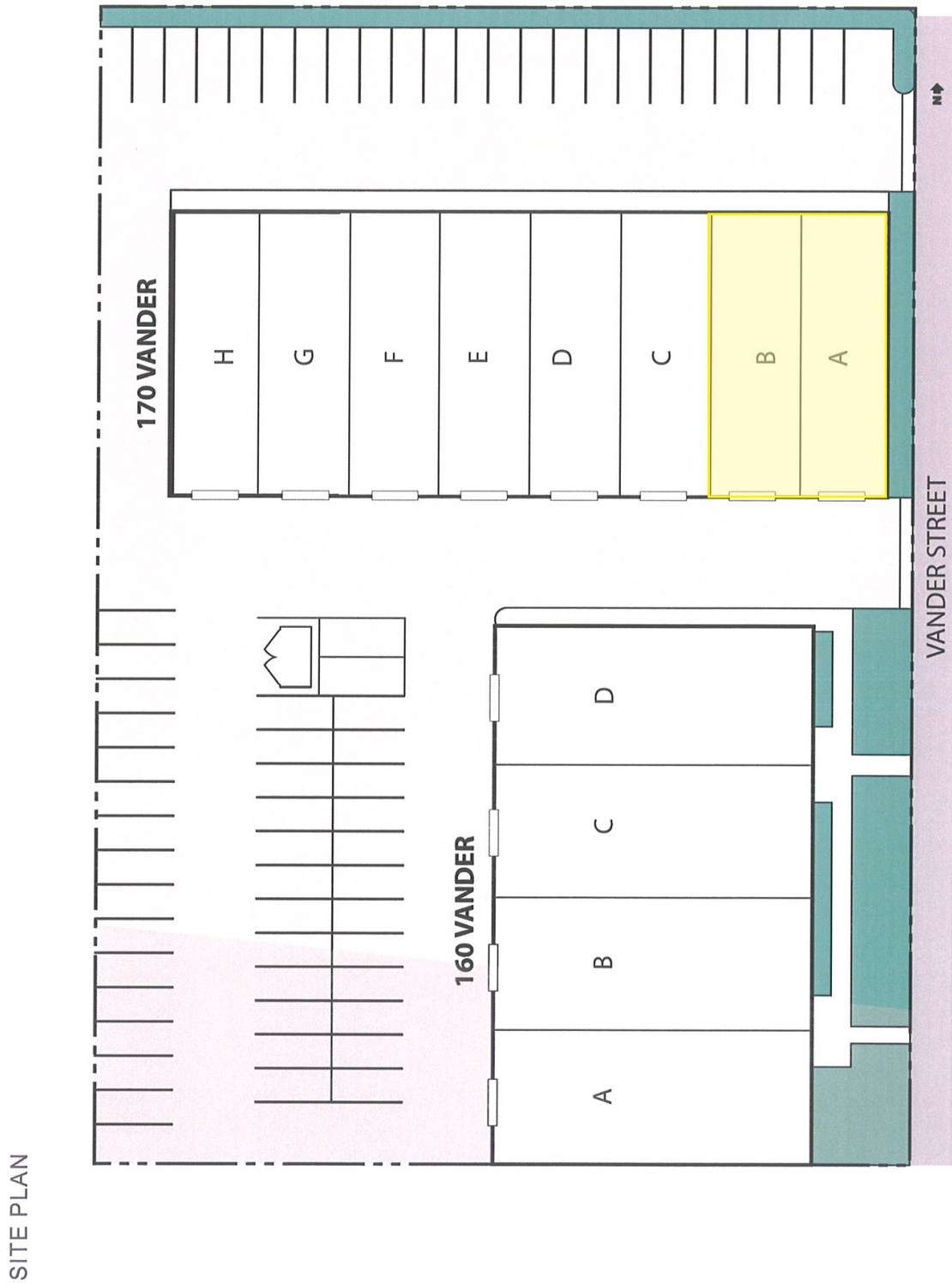

**TOBY TEWELL**

951.276.3662

TTEWELL@LEERIVERSIDE.COM | LICENSE #01822772

**JEFF RUSCIGNO, SIOR**

951.276.3630

JRUSCIGNO@LEERIVERSIDE.COM | LICENSE #001030286

No warranty or representation has been made to the accuracy of the foregoing information. Terms of sale or lease and availability are subject to change or withdrawal without notice.

Lee & Associates Commercial Real Estate Services, Inc. -Riverside. 3240 Mission Inn Avenue - Riverside, CA 92507 | Corporate ID# 01048055