

12,255 SF FOR LEASE

16701 STAGG ST. &
7861 RUFFNER AVE.
VAN NUYS, CA 91406



- + FLIGHT INDUSTRIAL PARK
- + THE PREMIER ENVIRONMENT FOR BUSINESS IN THE VALLEY
- + QUIET, SECURE NEIGHBORHOOD
- + GREAT CENTRAL VALLEY/VAN NUYS AIRPORT LOCATION
- + GREAT 405/101 FREEWAY ACCESS
- + M2 ZONED/ NO CAM CHARGES

PROPERTY INFO

LEASE RATE/SF:	\$1.33 G
LEASE RATE/MONTH:	\$16,299
AVAILABLE SF:	12,255
OFFICE SF/#:	820 / 2
OFFICE HVAC:	Yes
GROUND LEVEL DOORS:	3 / 12' x 12'
CLEAR HEIGHT:	14'

POWER:	A:400, V:120/240, P:3, W:4
PARKING SPACES/RATIO:	24 / 2:1
RESTROOMS:	4
ZONING:	M2
APN#:	2205-009-027
POSSESSION:	Immediate
TO SHOW:	Call Agent

LOCATOR MAP:

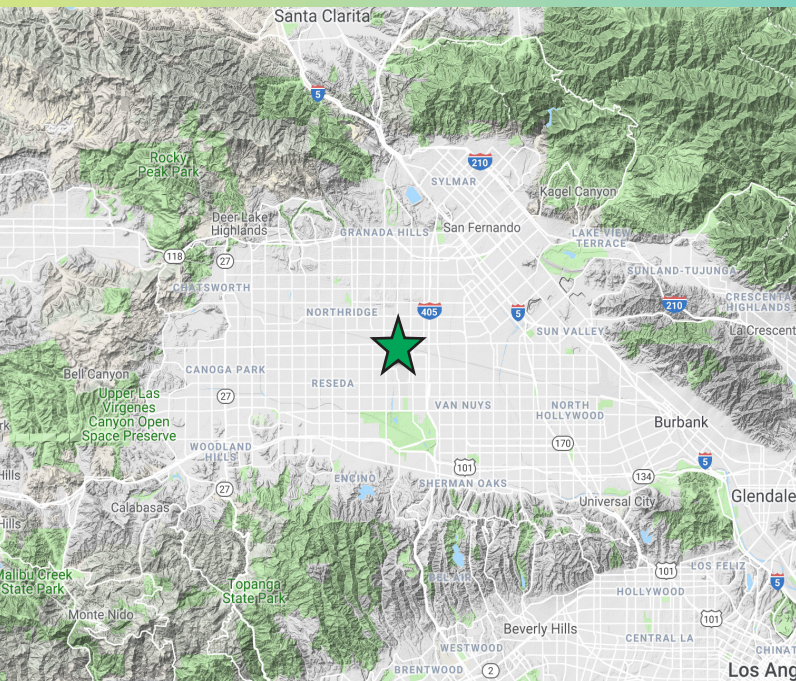

SITE PLAN:

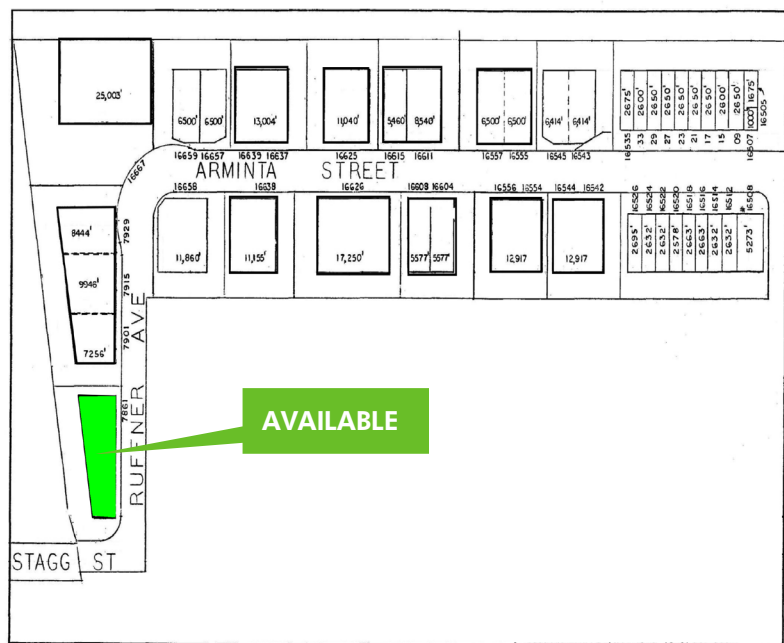

LAYOUTS:

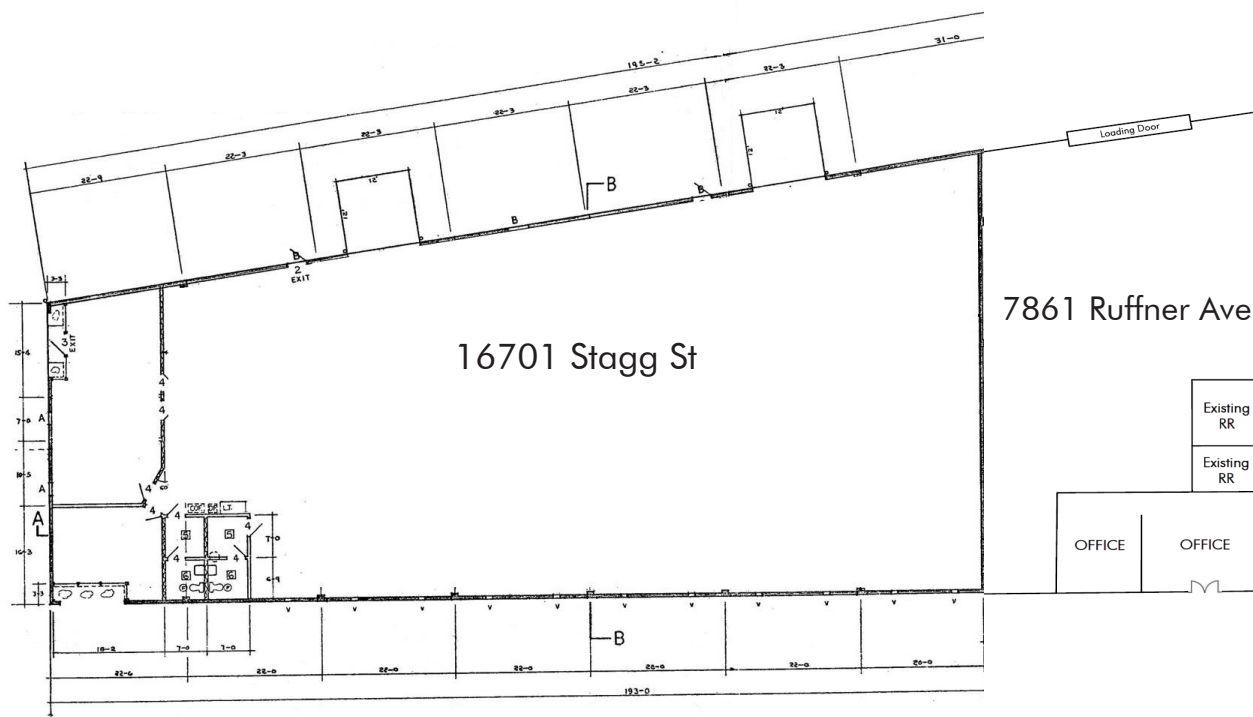

FOR MORE INFORMATION, PLEASE CONTACT:



BILLY WALK
 First Vice President
 +1 818 502 6733
 william.walk@cbre.com
 Lic 01398310



DAVID HARDING
 Senior Vice President
 +1 818 502 6731
 david.harding@cbre.com
 Lic 01049696



GREG GERACI
 Senior Vice President
 +1 818 502 6741
 greg.geraci@cbre.com
 Lic 01004871



MATT DIERCKMAN
 Senior Vice President
 +1 818 502 6752
 matt.dierckman@cbre.com
 Lic 01301723

www.cbre.com/lanorth

© 2019 CBRE, Inc. All rights reserved. This information has been obtained from sources believed reliable, but has not been verified for accuracy or completeness. You should conduct a careful, independent investigation of the property and verify all information. Any reliance on this information is solely at your own risk. CBRE and the CBRE logo are service marks of CBRE, Inc. All other marks displayed on this document are the property of their respective owners. Photos herein are the property of their respective owners. Use of these images without the express written consent of the owner is prohibited.

