

2323

PLUG & PLAY

Owen Street, Santa Clara, CA

±13,220 SF CLASS A OFFICE/R&D SPACE FOR LEASE

Kent Hillhouse

kent.hillhouse@cushwake.com

+1 408 615 3413

LIC. 00817501

Clark Steele

clark.steele@cushwake.com

+1 408 436 3653

LIC. 01995379



**CUSHMAN &
WAKEFIELD**

[View Site Specific COVID-19 Prevention Plan](#)

PROPERTY HIGHLIGHTS

±13,220 SF Class A Office/R&D Space For Lease

- New Market Ready Space
- 60+ Workstations Available
- New Exterior Upgrade Complete
- High Image Building w/ Excellent Street Presence
- Updated Lobby, Restrooms & Break Room
- 100% Drop Ceiling w/ Expansive Window Line
- Affordable Santa Clara Power
- Strategic Location at San Tomas & Central Expressways
- Monument Signage Available
- 3.1/1,000 Parking
- Grade Level & Dock Loading Access Available
- Electric Charging Stations On-Site
- Call for Touring Instructions
- Available Q4 2020

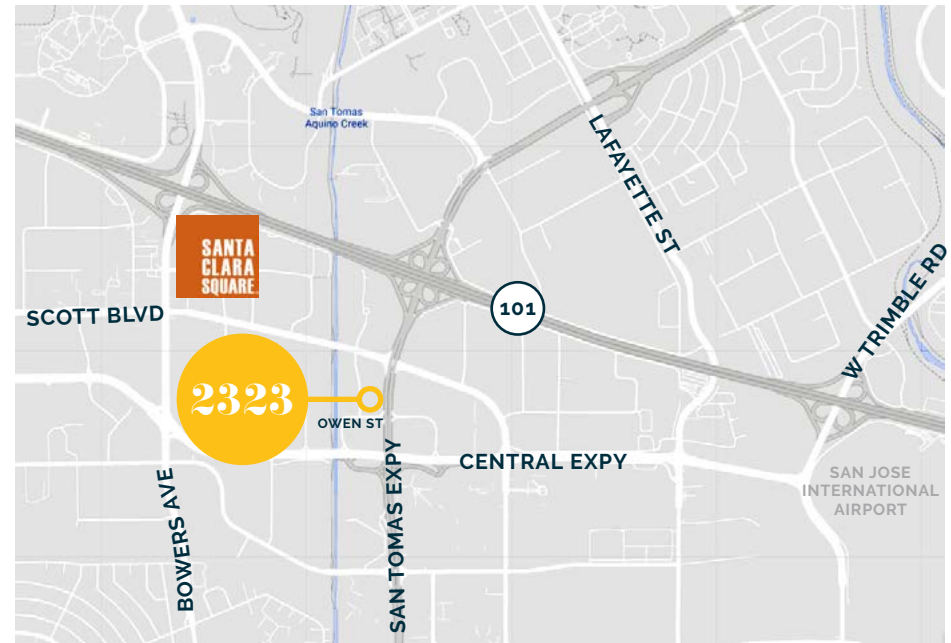





SITE PLAN

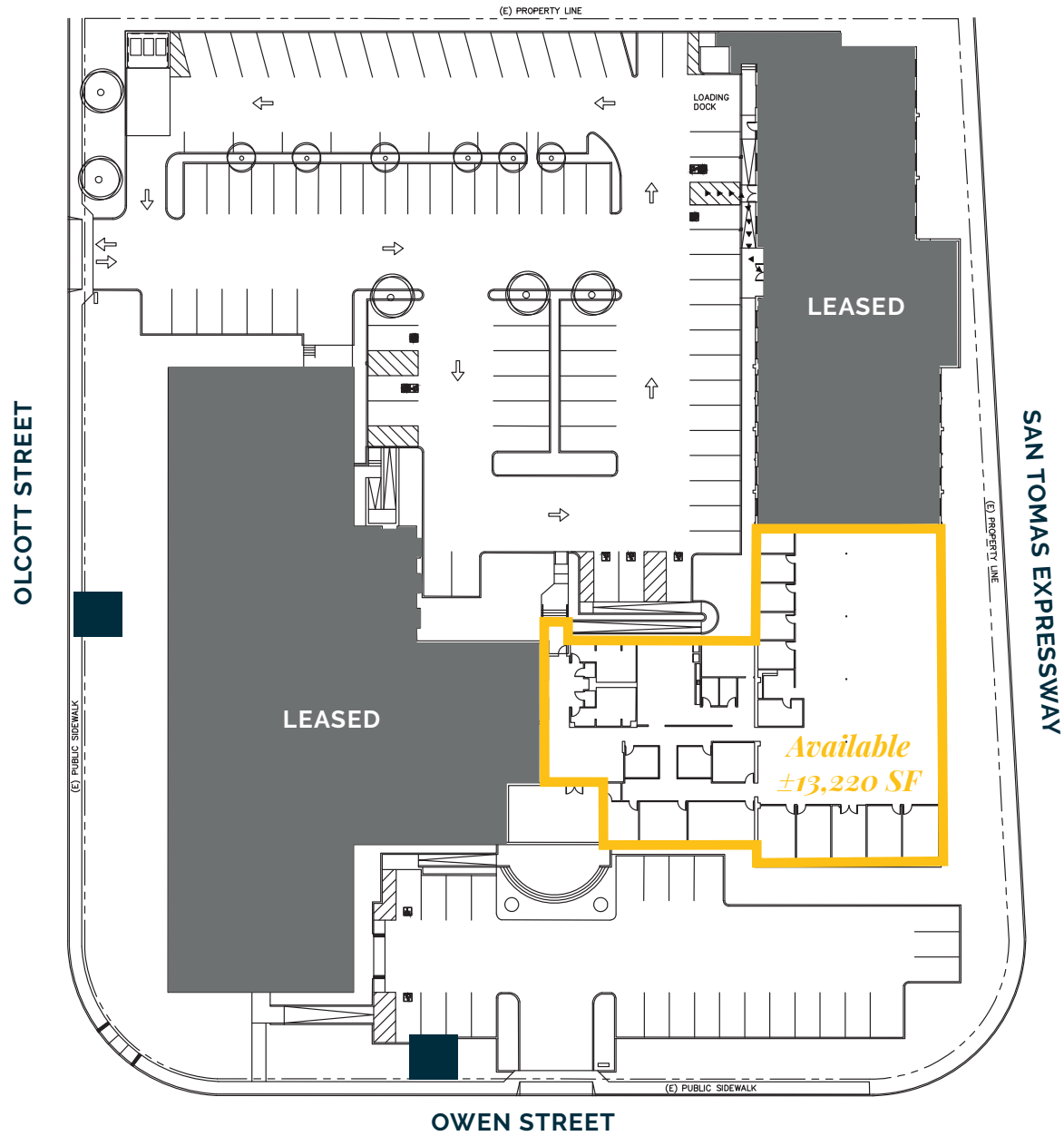

■ MONUMENT SIGNAGE

FLOOR PLAN

±13,220 SF Available

- Plug & Play
- 60+ Workstations Available
- 9 Private Offices
- 7 Conference Rooms
- Open Office Area
- 2 Call Rooms
- Large Break Room
- Workroom
- IT/Server Rooms
- Grade Level & Dock Loading Access Available
- Available Q4 2020

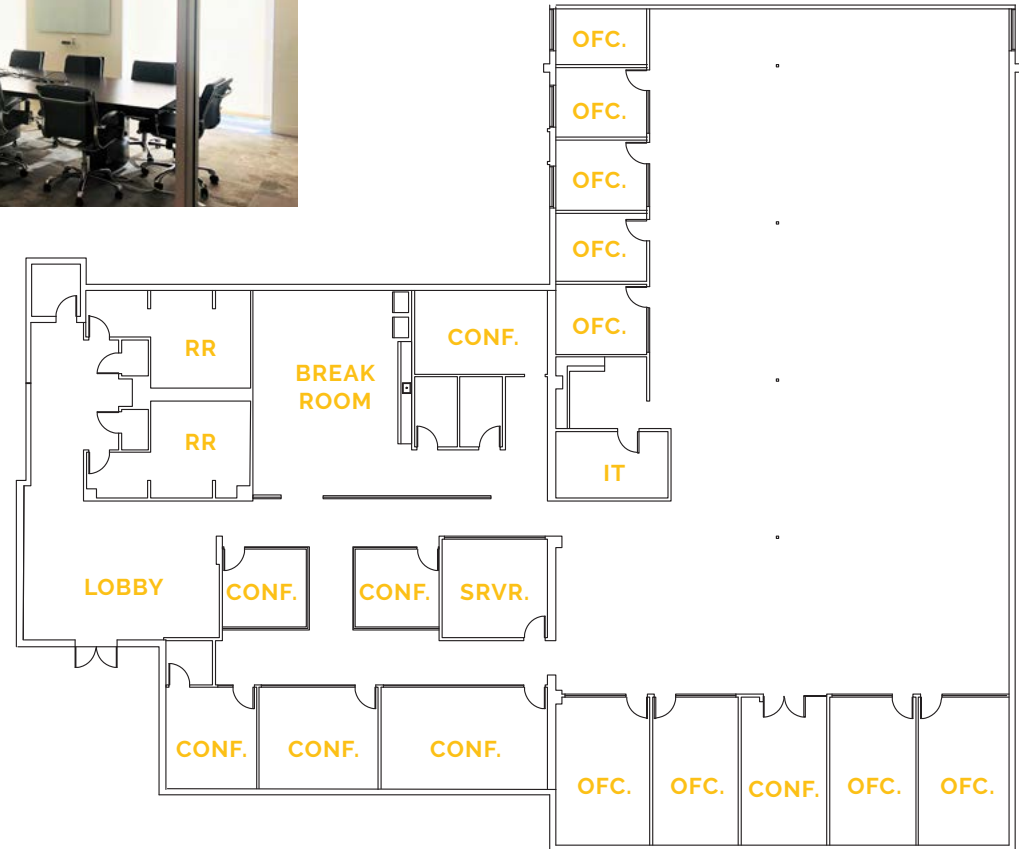
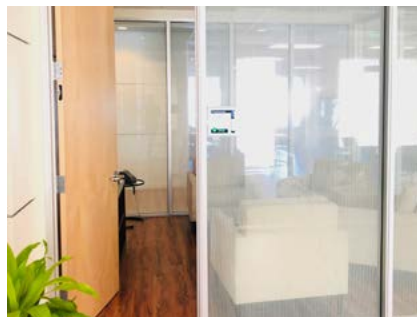

AMENITIES MAP

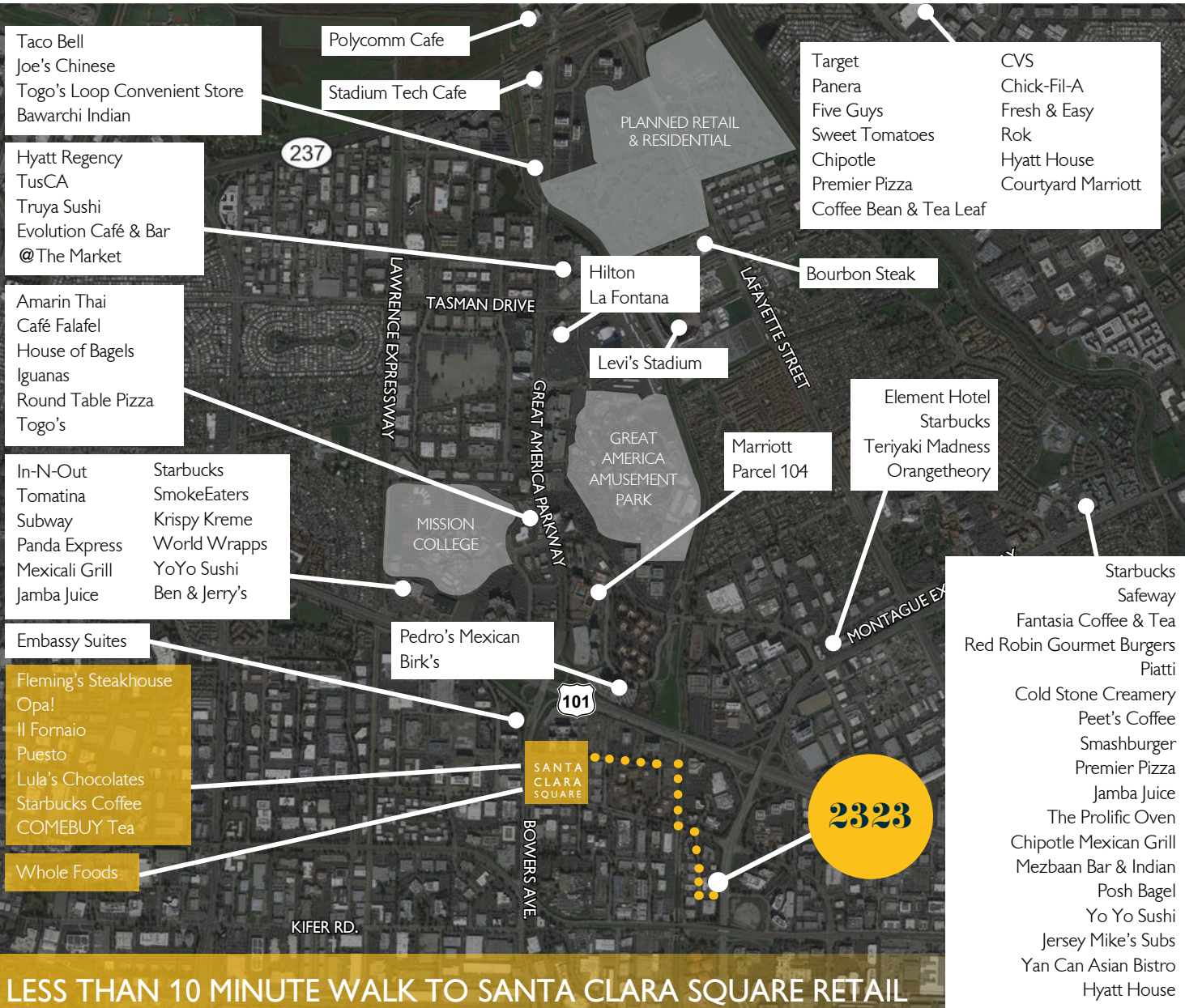

TRANSPORTATION MAP



BLOCKS FROM ACE TRAIN SHUTTLE TO GREAT AMERICA STATION

ACE SHUTTLE CONNECTS TO LAWRENCE CALTRAIN SHUTTLE

APPROXIMATELY 60 MINUTES TO SAN FRANCISCO CALTRAIN

2323

Owen Street, Santa Clara, CA

Kent Hillhouse

kent.hillhouse@cushwake.com
+1 408 615 3413
LIC. 00817501

Clark Steele

clark.steele@cushwake.com
+1 408 436 3653
LIC. 01995379

