

PACIFIC TECHNOLOGY PARK
9393 WAPLES STREET, SUITE 100
SAN DIEGO, CA 92121

R&D FOR LEASE
Approximately 30,610 SF



SORRENTO MESA



BUILDING FEATURES

AVAILABLE	30,610 SF
RENTAL RATE	\$0.95/SF NNN
NNN	\$0.22/SF

PROPERTY FEATURES

- End Unit of the Building
- Approx. 20% Office, 80% HVAC Production/Warehouse
- Power: 1,200 Amps, 277/480 Volts
- 27' Clear Height in Warehouse
- 2 Docks, 1 Oversized Ramp Up Door and Knockout Panel for Grade Level Door
- IL-2-I Zoning
- Fully Sprinklered
- 60' x 60' Column Spacing

For more information, please contact:

MICKEY MORERA
Executive Director
(858) 558 5639
mickey.morera@cushwake.com
CA License No. 950071

JAMES DUNCAN
Director
(858) 558 5664
james.duncan@cushwake.com
CA License No. 1253770

PHILIP ROBERTS
Associate
(858) 558 5651
philip.roberts@cushwake.com
CA License No. 01908296

CUSHMAN & WAKEFIELD OF SAN DIEGO, INC.
CA License No. 1329963
4747 Executive Drive, Suite 900
San Diego, CA 92121
www.cushmanwakefield.com

The depiction in the included photograph of any person, entity, sign, logo or property, other than Cushman & Wakefield's (C&W) client and the property offered by C&W, is incidental only, and is not intended to connote any affiliation, connection, association, sponsorship or approval by or between that which is incidentally depicted and C&W or its client. This listing shall not be deemed an offer to lease, sublease or sell such property; and, in the event of any transaction for such property, no commission shall be earned by or payable to any cooperating broker except if otherwise provided pursuant to the express terms, rates and conditions of C&W's agreement with its principal, if, as and when such commission (if any) is actually received from such principal. (A copy of the rates and conditions referred to above with respect to this property is available upon request.)

Floor Plan

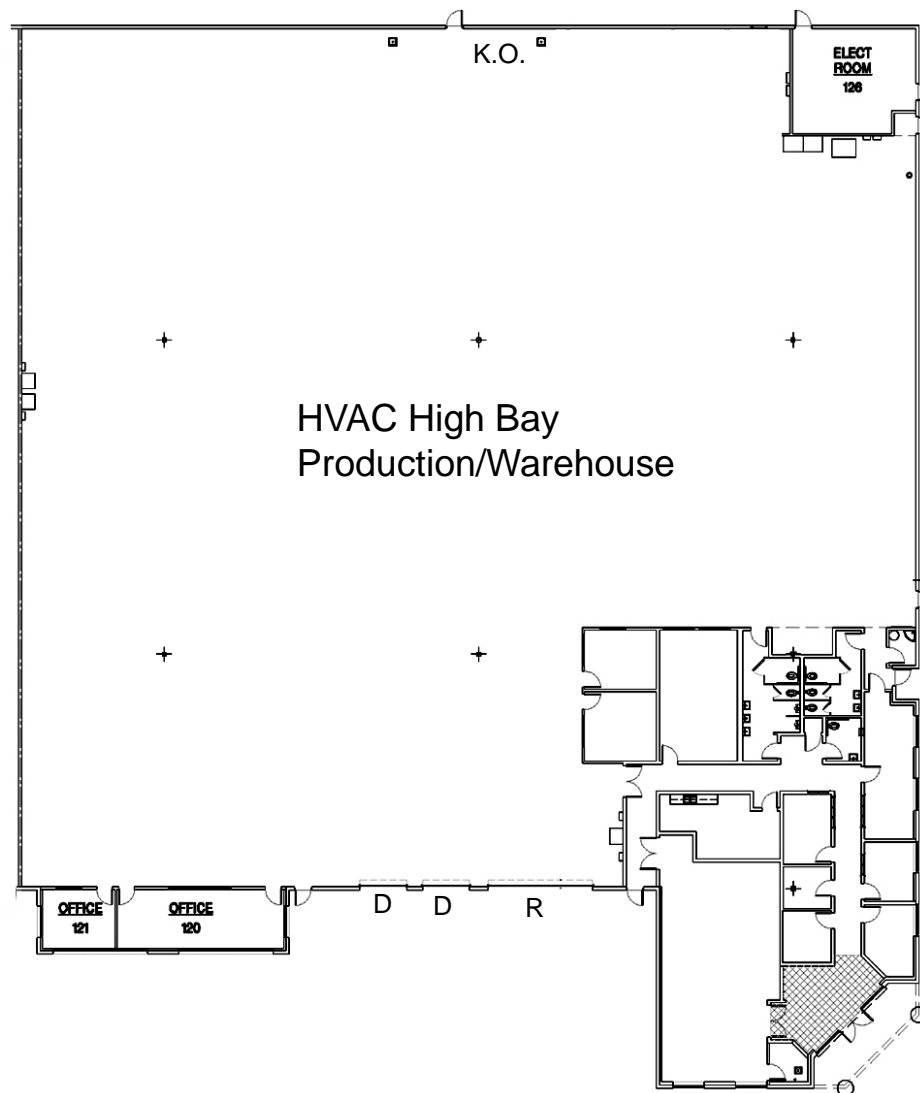

Legend:
D – Dock
R – Ramp
K.O. – Knockout Panel For
Grade Door

For more information, please contact:

MICKEY MORERA
Executive Director
(858) 558 5639
Mickey.Morera@cushwake.com
CA License No. 950071

JAMES DUNCAN
Director
(858) 558 5664
James.Duncan@cushwake.com
CA License No. 1253770

PHILIP ROBERTS
Associate
(858) 558 5651
philip.roberts@cushwake.com
CA License No. 01908296

CUSHMAN & WAKEFIELD OF SAN DIEGO, INC.
CA License No. 1329963
4747 Executive Drive, Suite 900
San Diego, CA 92121
www.cushmanwakefield.com

The depiction in the included photograph of any person, entity, sign, logo or property, other than Cushman & Wakefield's (C&W) client and the property offered by C&W, is incidental only, and is not intended to connote any affiliation, connection, association, sponsorship or approval by or between that which is incidentally depicted and C&W or its client. This listing shall not be deemed an offer to lease, sublease or sell such property; and, in the event of any transaction for such property, no commission shall be earned by or payable to any cooperating broker except if otherwise provided pursuant to the express terms, rates and conditions of C&W's agreement with its principal, if, as and when such commission (if any) is actually received from such principal. (A copy of the rates and conditions referred to above with respect to this property is available upon request.)

9393 WAPLES STREET, SUITE 100

R&D for Lease

30,610 SF
AVAILABLE
FOR LEASE

Aerial



For more information, please contact:

MICKEY MORERA
Executive Director
(858) 558 5639
Mickey.Morera@cushwake.com
CA License No. 950071

JAMES DUNCAN
Director
(858) 558 5664
James.Duncan@cushwake.com
CA License No. 1253770

PHILIP ROBERTS
Associate
(858) 558 5651
philip.roberts@cushwake.com
CA License No. 01908296

CUSHMAN & WAKEFIELD OF SAN DIEGO, INC.
CA License No. 1329963
4747 Executive Drive, Suite 900
San Diego, CA 92121
www.cushmanwakefield.com

The depiction in the included photograph of any person, entity, sign, logo or property, other than Cushman & Wakefield's (C&W) client and the property offered by C&W, is incidental only, and is not intended to connote any affiliation, connection, association, sponsorship or approval by or between that which is incidentally depicted and C&W or its client. This listing shall not be deemed an offer to lease, sublease or sell such property; and, in the event of any transaction for such property, no commission shall be earned by or payable to any cooperating broker except if otherwise provided pursuant to the express terms, rates and conditions of C&W's agreement with its principal, if, as and when such commission (if any) is actually received from such principal. (A copy of the rates and conditions referred to above with respect to this property is available upon request.)

Location

Pacific Technology Park is located on the corner of Waples Street, approximately one block south of Mira Mesa Blvd.

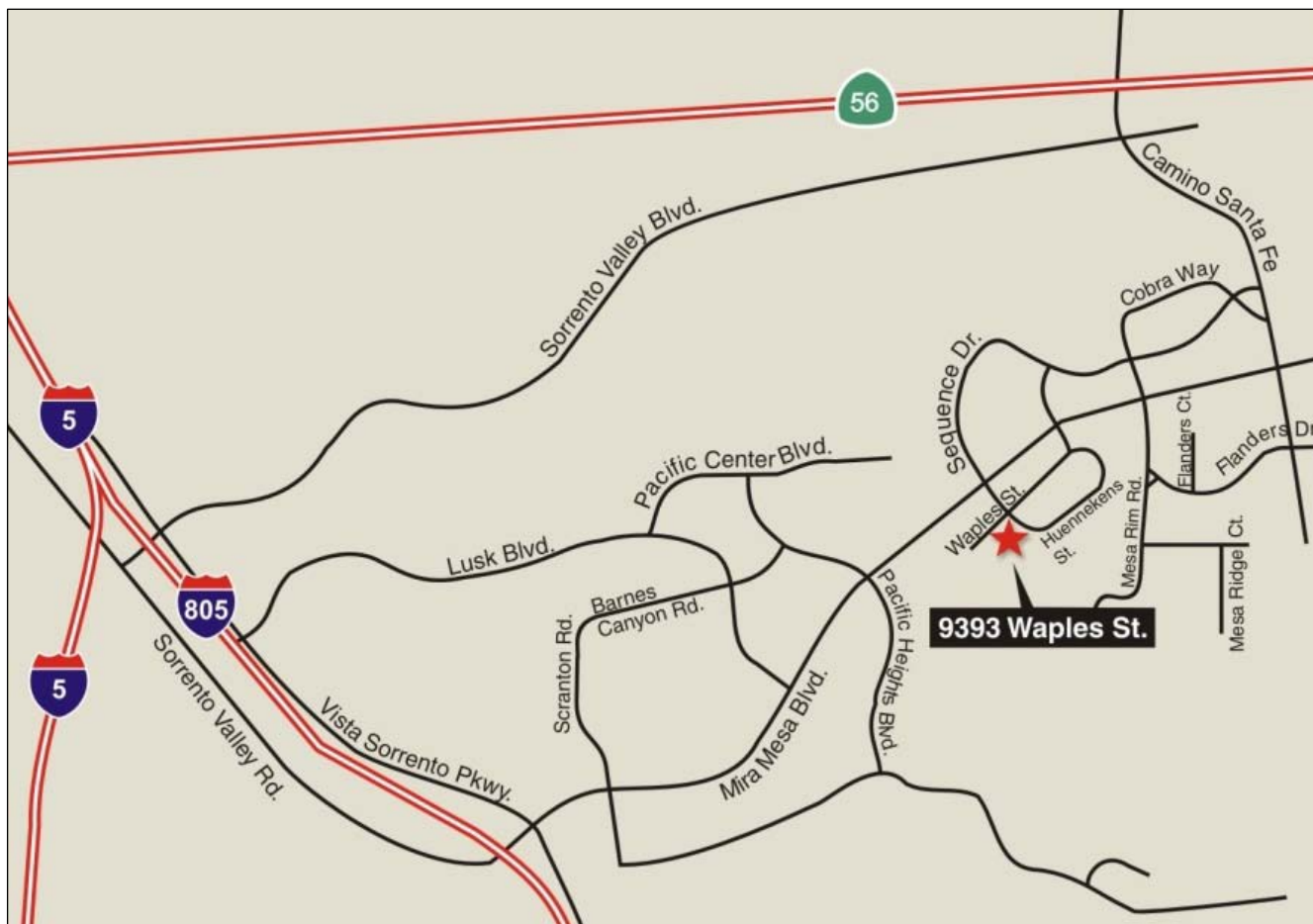

For more information, please contact:

MICKEY MORERA

Executive Director
(858) 558 5639
Mickey.Morera@cushwake.com
CA License No. 950071

JAMES DUNCAN

Director
(858) 558 5664
James.Duncan@cushwake.com
CA License No. 1253770

PHILIP ROBERTS

Associate
(858) 558 5651
philip.roberts@cushwake.com
CA License No. 01908296

CUSHMAN & WAKEFIELD OF SAN DIEGO, INC.

CA License No. 1329963
4747 Executive Drive, Suite 900
San Diego, CA 92121
www.cushmanwakefield.com