

PARK 350

3701 David Howarth Drive
Lafayette, IN 47909



3701 David Howarth Drive, Lafayette, IN 47909

- 114,510 SF Total Available
 - 42,210 SF (Ste. A)
 - 31,500 SF (Ste. C)
 - 40,800 SF (Ste. D)
- Master planned business park with signalized entrance
- Neighbors include GE Aviation, FedEx, Subaru, Heartland Automotive and Wabash National
- Excellent access via I-65, US 52 & SR 38



PARK 350

3701 David Howarth Drive
Lafayette, IN 47909

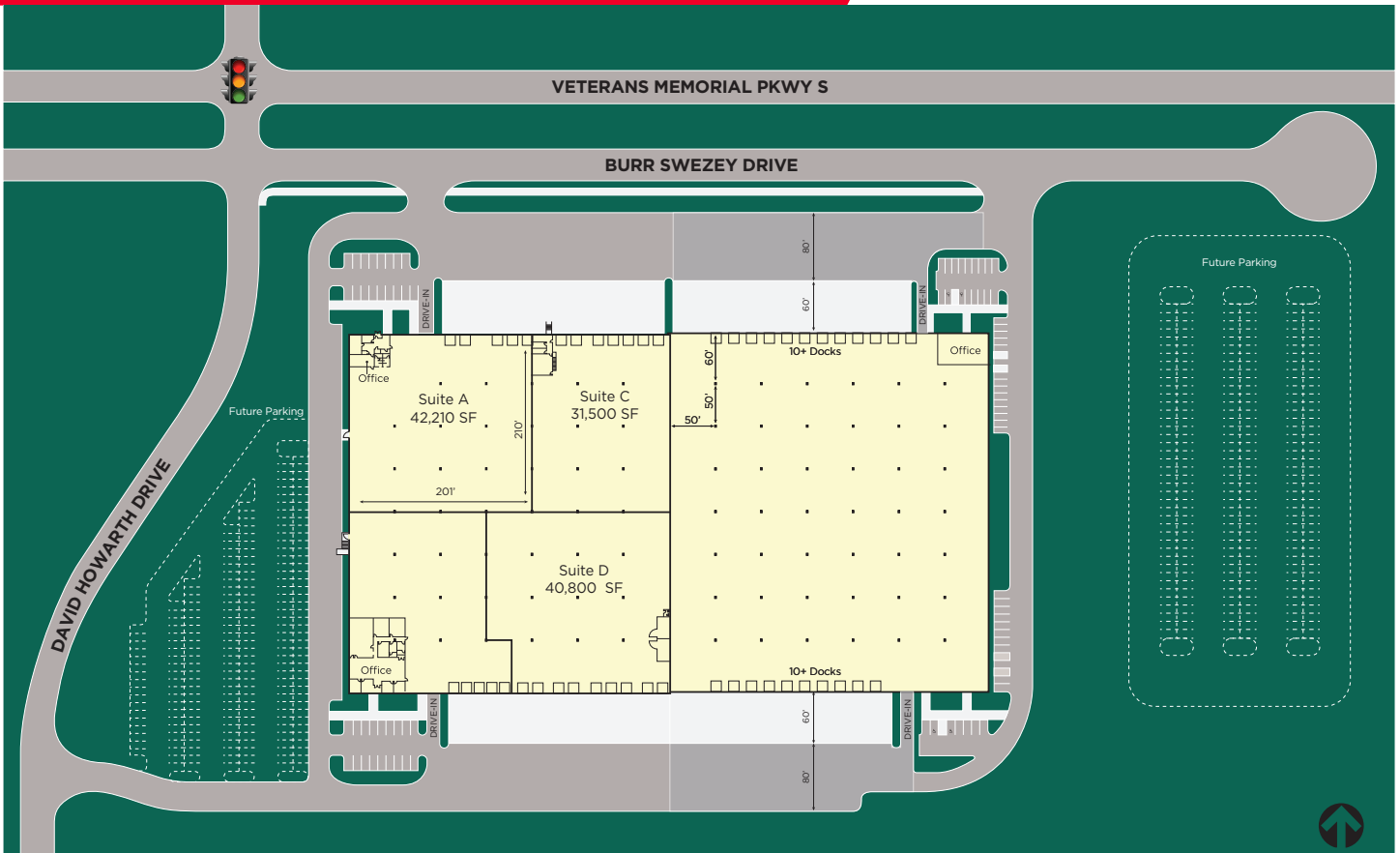

3701 David Howarth Drive, Lafayette, IN 47909

Available Areas: ±114,510 SF (Ste. A, Ste. C & Ste. D) ±42,210 SF (Ste. A) ±31,500 SF (Ste. C) ±40,800 SF (Ste. D)	Roof: Single ply, ballasted, EPDM roof
Total Building Area: 294,730 SF	Floor: 7" unreinforced 4,000 PSI concrete slab with Ashford application
Ceiling Height: 28'	Sprinkler: ESFR
Column Spacing: 50' x 50'	Interior Lighting: T-5 fluorescent
Dock Bay Spacing: 60'	Office: ±1,430 (Ste. A) ±1,000 SF (Ste. C) ±850 SF (Ste. D)
Docks: 21 Total (5-Ste. A, 7-Ste. C, 9-Ste. D)	Heating: Gas-fired make up air units, to maintain 60°F at 0°F
Drive-in: 1 (Ste. A)	Power: 1600A, 480/277V, 3P
Truck Court: 140'	Other: Potential for additional auto & trailer parking on site.
Site Area: 23+ acres	
Construction: Pre-cast insulated concrete walls	

For more information, contact:

Jeff Castell, SIOR, CCIM
Cushman & Wakefield
Executive Director
Direct +1 317 639 0436
jeff.castell@cushwake.com

Mark Castell
The Warehouse of Lafayette
President
Direct +1 765 474 6411
mark@warehouseoflafayette.com

One American Square, Suite 1800
Indianapolis, IN 46282 | USA
Main +1 317 639 0515
Fax +1 317 639 0504
cushmanwakefield.com