

PANAMA CITY SHOPPING CENTER

East 23rd Street and Highway 77 | Panama City, FL 32405

OFFERING SUMMARY

Available SF: 1,600 SF (\$15 NNN)

1,600 SF end suite
(\$17 NNN)

Traffic Count: 26,500 VPD

LOCATION OVERVIEW

Located in a high traffic area in the Northwest Quadrant of East 23rd Street and Highway 77. Up to 20,000 SF available.



RETAIL PROPERTY FOR LEASE

WHITE-SPUNNER
REALTY

ADDITIONAL PHOTOS

East 23rd Street and Highway 77 | Panama City, FL 32405

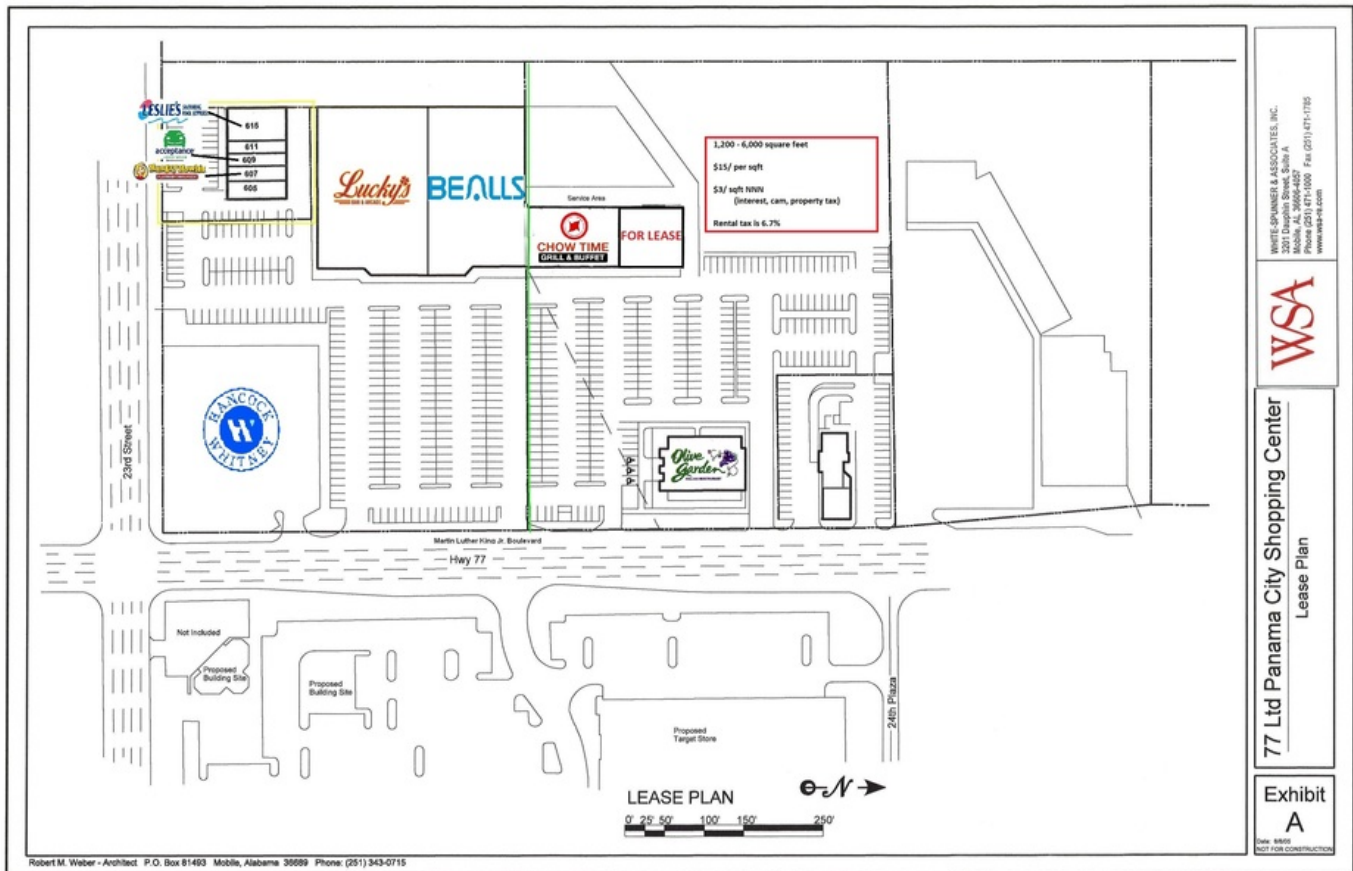

White-Spunner Realty | 251.471.1000 | 3201 Dauphin Street, Suite A | Mobile, AL 36606

MATT WHITE
251.377.3033
matt@white-spinnerrealty.com

White-Spunner has obtained the information from sources it believes to be reliable and believes the information to be correct. No representation or warranties, expressed or implied are made as to the accuracy or reliability of this information. The recipient bears responsibility for verification of the information contained herein and bears all risk for any accuracy.

RETAIL PROPERTY FOR LEASE

WHITE-SPUNNER
REALTY

ADDITIONAL PHOTOS

East 23rd Street and Highway 77 | Panama City, FL 32405



White-Spunner Realty | 251.471.1000 | 3201 Dauphin Street, Suite A | Mobile, AL 36606

MATT WHITE
251.377.3033
matt@white-spunnersrealty.com

White-Spunner has obtained the information from sources it believes to be reliable and believes the information to be correct. No representation or warranties, expressed or implied are made as to the accuracy or reliability of this information. The recipient bears responsibility for verification of the information contained herein and bears all risk for any accuracy.

RETAIL PROPERTY FOR LEASE

WHITE-SPUNNER
REALTY

RETAILER MAP

East 23rd Street and Highway 77 | Panama City, FL 32405



White-Spunner Realty | 251.471.1000 | 3201 Dauphin Street, Suite A | Mobile, AL 36606

MATT WHITE
251.377.3033
matt@white-spunnersrealty.com

White-Spunner has obtained the information from sources it believes to be reliable and believes the information to be correct. No representation or warranties, expressed or implied are made as to the accuracy or reliability of this information. The recipient bears responsibility for verification of the information contained herein and bears all risk for any accuracy.