

BOX SPACE ADJACENT TO KOHL'S

2725 JANITELL ROAD | COLORADO SPRINGS, CO 80906



AREA ANCHORS:



PROPERTY HIGHLIGHTS

- Join Kohl's in a great trade area of southwest Colorado Springs
- 24,700 SF available with great frontage
- Several other national retailers are already in the immediate area including Walmart, Sam's Club, Ross Dress for Less, Sears, PetSmart, Michaels, Bed, Bath & Beyond, Home Depot, Target, OfficeMax, and Natural Grocers
- Very good permanent and daytime population demographics
- Excellent visibility from main thoroughfare

DEMOGRAPHICS

	3 MILE	5 MILES	7 MILES
Population	106,255	227,008	322,654
Avg HH Income	\$58,036	\$63,380	\$64,473
Employees	52,644	120,123	168,580
Businesses	4,804	10,834	15,469

TRAFFIC COUNTS

Source: CO Springs 2015

On Circle Dr east of Janitell Rd	13,767 cars/day
On I-25 north of Circle Dr	97,000 cars/day

1301 CANYON BLVD, SUITE 228 | BOULDER, CO 80302 | 303.534.0900 | WWW.SULLIVANHAYES.COM

SullivanHayes
B R O K E R A G E

Stan Johnson Co.

we are
RETAIL

CHAINLINKS
RETAIL ADVISORS

**AGENCY
DISCLOSURE**

Michael DePalma

720.382.7597 | mdepalma@sullivanhayes.com

David Dobek

720.382.7598 | ddobek@sullivanhayes.com

Sean Kulzer

720.382.7596 | skulzer@sullivanhayes.com

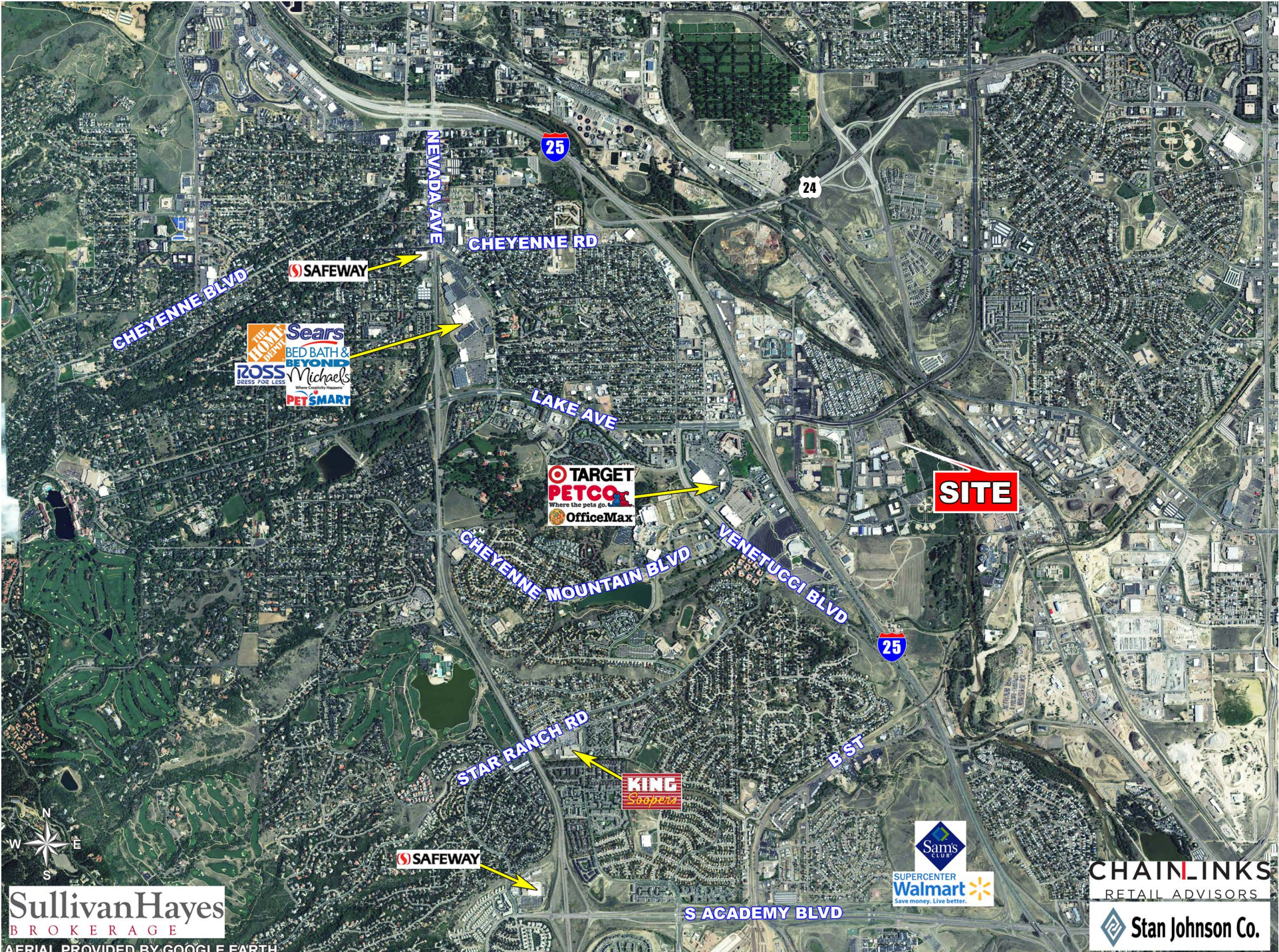

SullivanHayes
BROKERAGE

AERIAL PROVIDED BY GOOGLE EARTH

PROPOSED LOCATIONS FOR INGRESS, EGRESS, SITE LAYOUT, BUILDING PADS, BUILDING FOOTPRINTS, ANCHOR TENANT SPACES AND SMALL SHOP SPACES ARE ILLUSTRATIVE ONLY AND SUBJECT TO CHANGE AT ANY TIME. THE IDENTIFICATION OF PROPOSED TENANTS OR PROPOSED TENANT MIX ARE PRELIMINARY AND SUBJECT TO CHANGE AT ANY TIME. THE IDENTIFICATION OF EXISTING TENANTS OR BUSINESS IS AS OF THE DATE HEREOF AND NOT A GUARANTEE OF FUTURE OCCUPANCY OR OPERATION. R:/AERIALS/KOHL'S/SW CO SPRINGS_TA.PSD

CHAINLINKS
RETAIL ADVISORS

Stan Johnson Co.

PRIME RETAIL SPACE ADJACENT TO KOHL'S

COLORADO SPRINGS, CO 80906 | 2725 JANITELL ROAD | SEC CIRCLE DRIVE & JANITELL ROAD | SW COLORADO SPRINGS #687

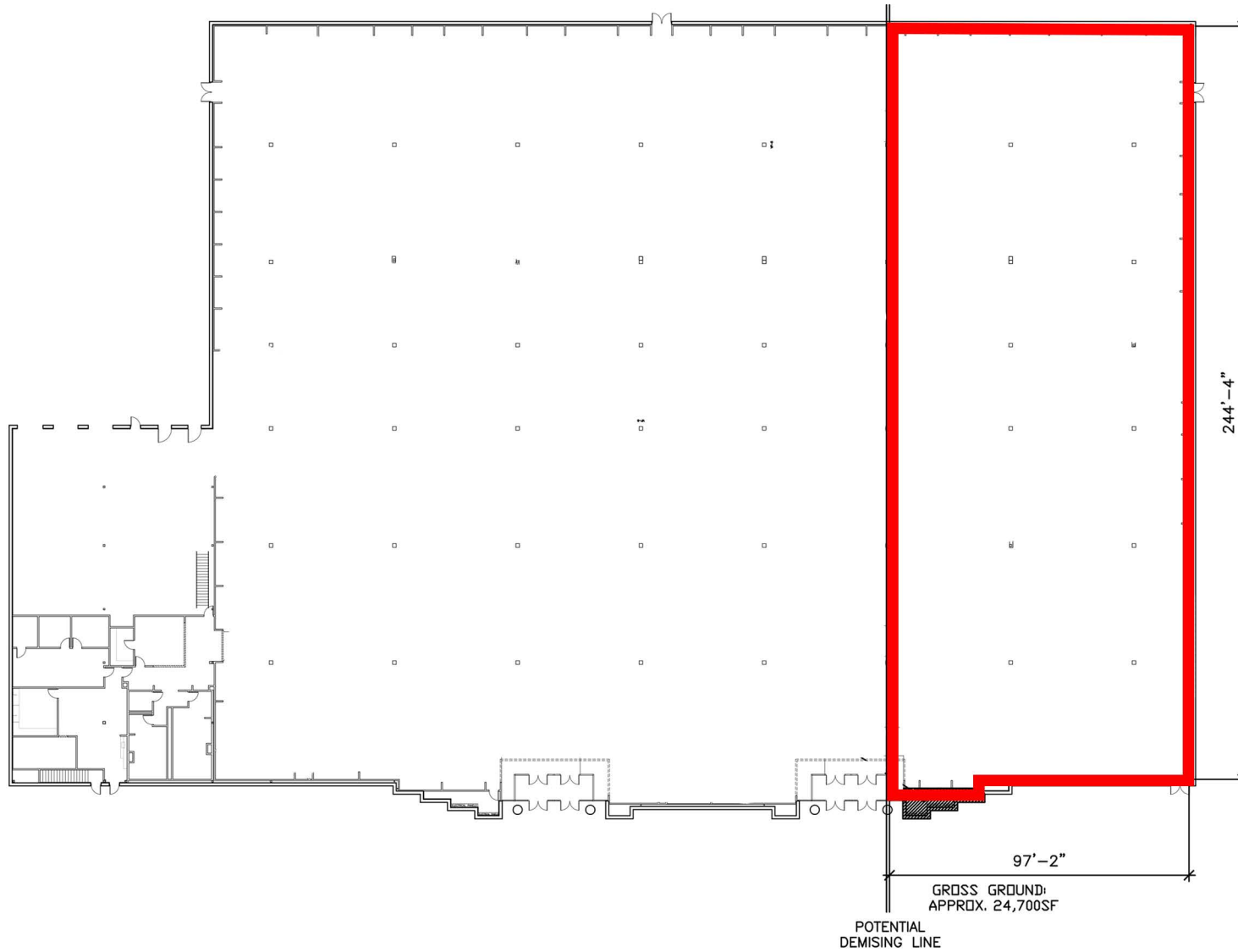

#10687 SW Colorado
Springs, CO

Updated: 12/11/17

SullivanHayes
B R O K E R A G E

MICHAEL DePALMA
720.382.7597
mdepalma@sullivanhayes.com

DAVID DOBEK
720.382.7598
ddobek@sullivanhayes.com

SEAN KULZER
720.382.7596
skulzer@sullivanhayes.com

CHAINLINKS
RETAIL ADVISORS

 **Stan Johnson Co.**

The information contained herein has been compiled from sources believed to be reliable. However, SullivanHayes has not independently verified the same and makes no guarantee, warranty or representation about such information. Any opinions, assumptions or projections used are for illustrative purposes only and do not necessarily represent the current or future performance of the property. Site plans, renderings, aerials, marketing data, pricing and other terms are subject to change at any time. You and your tax, financial and legal advisors should make a thorough independent investigation of the property to determine its suitability to your needs. SullivanHayes, its broker associates and its salespersons, are or will be acting as agents of the seller/lessor with the duty to represent the interests of the seller/lessor. SullivanHayes will not act as your agent unless an agency agreement is signed and in effect.