



FOR LEASE

# 5113 BERWYN ROAD

COLLEGE PARK, MARYLAND 20740

 **TRANSWESTERN**<sup>®</sup>

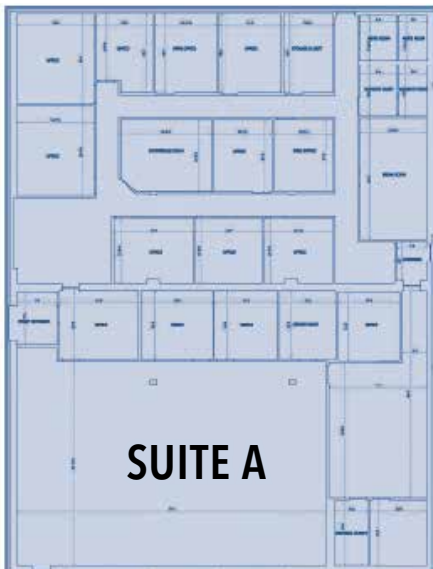
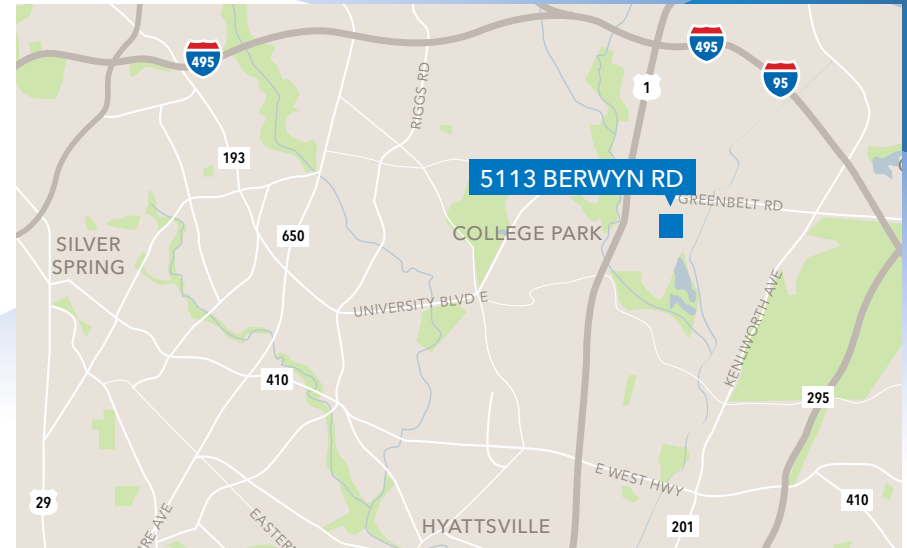

### PROPERTY FEATURES

- 23,325 SF building
- Easy access to I-495, I-95, Route 1, and Route 295
- Fully sprinklered
- Heavy electric power
- 18' clear ceiling height
- Zoned I-1 (Light Industrial)
- Ample free surface parking
- Building signage available

### AVAILABLE SPACE

- **Suite A:** 7,141 SF
  - 60% office/40% warehouse
- One (1) oversized drive-in door

### INFORMATION

**Brian Watts**  
443.285.7673  
brian.watts@transwestern.com

**Jeff Groves**  
443.285.7666  
jeff.groves@transwestern.com

**Jason Sullivan**  
443.285.7663  
jason.sullivan@transwestern.com

7160 Columbia Gateway Drive  
Suite 210  
Columbia, Maryland 21046

443.285.0770  
www.transwestern.com

