



Creative Retail/Showroom/Office/Medical Space For Lease On Historic Grand Avenue

A rare opportunity to secure a Grand Avenue address! Class A creative space is available for lease on Grand Avenue in St. Paul. This classy mixed-use building is home to Edina Realty, Moxie Salon, and 6 upper condo units. Features of the 2,423 square foot vacancy include 14'-0" exposed high ceilings, wide column spacing, and complimentary underground parking. Space would be ideal for a modern office or retail tenant, a medical user, or a design showroom. The suite is mostly open. Private restrooms, a break room, and a storeroom with rear double door loading are built out in the back.

Space Available: 2,423 sf

- Lease Rate: Negotiable
- 2022 CAM/Tax: \$10.94 psf

Demographics and Traffic Counts:

- Average Population: 1 mile - 25,621,
3 miles - 169,039, 5 miles - 363,250
- Average Household Income: 1 mile - \$100,577,
3 miles - \$89,175, 5 miles - \$88,448
- Traffic Count: Grand Avenue - 11,100 vpd

Highlights and Features:

- On Historic Grand Avenue
- Window display case available
- High pedestrian and vehicle traffic counts
- Free underground parking for staff and clients
(53 parking spaces shared with the condo and retail tenants)
- B-3 zoning
- Shared loading (oversized double doors in the rear of the building)
- Break room with refrigerator and sink
- Common trash room off the alley
- Easy access to I-94 and I-35E
- Many area amenities



Christianson & Company
COMMERCIAL REAL ESTATE SERVICES
www.SpaceAvailableMN.com

MARILYN FRITZE

612.804.4364

marilyn@christiansonandco.com

This information is accurate as of the date of printing and is subject to change without notice. All information is deemed accurate, but cannot be guaranteed.

www.SpaceAvailableMN.com

Giving developers, business owners and commercial real estate investors the gifts of experience and personal attention.

Space Plan

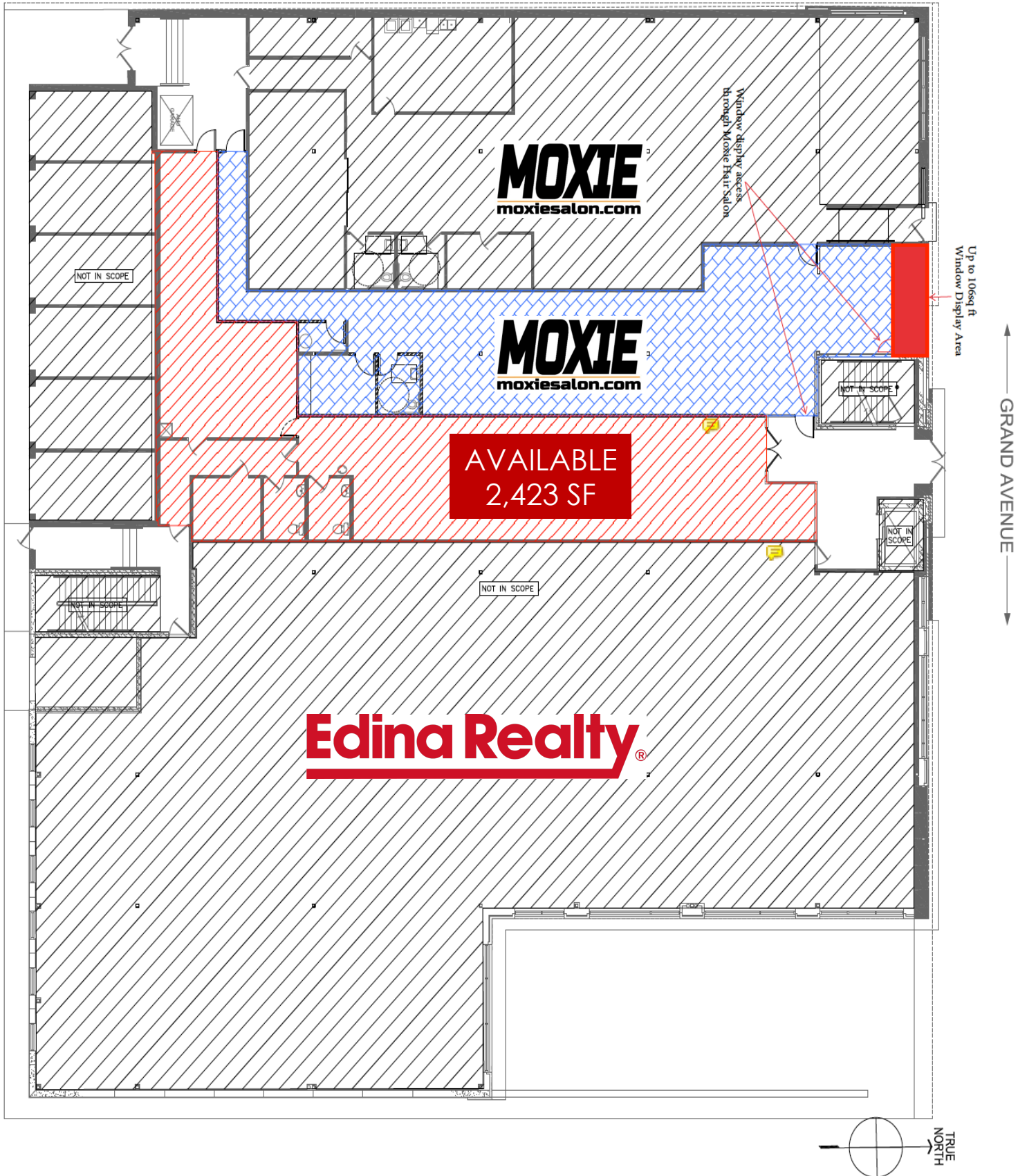

This information is accurate as of the date of printing and is subject to change without notice. All information is deemed accurate, but cannot be guaranteed.

Map

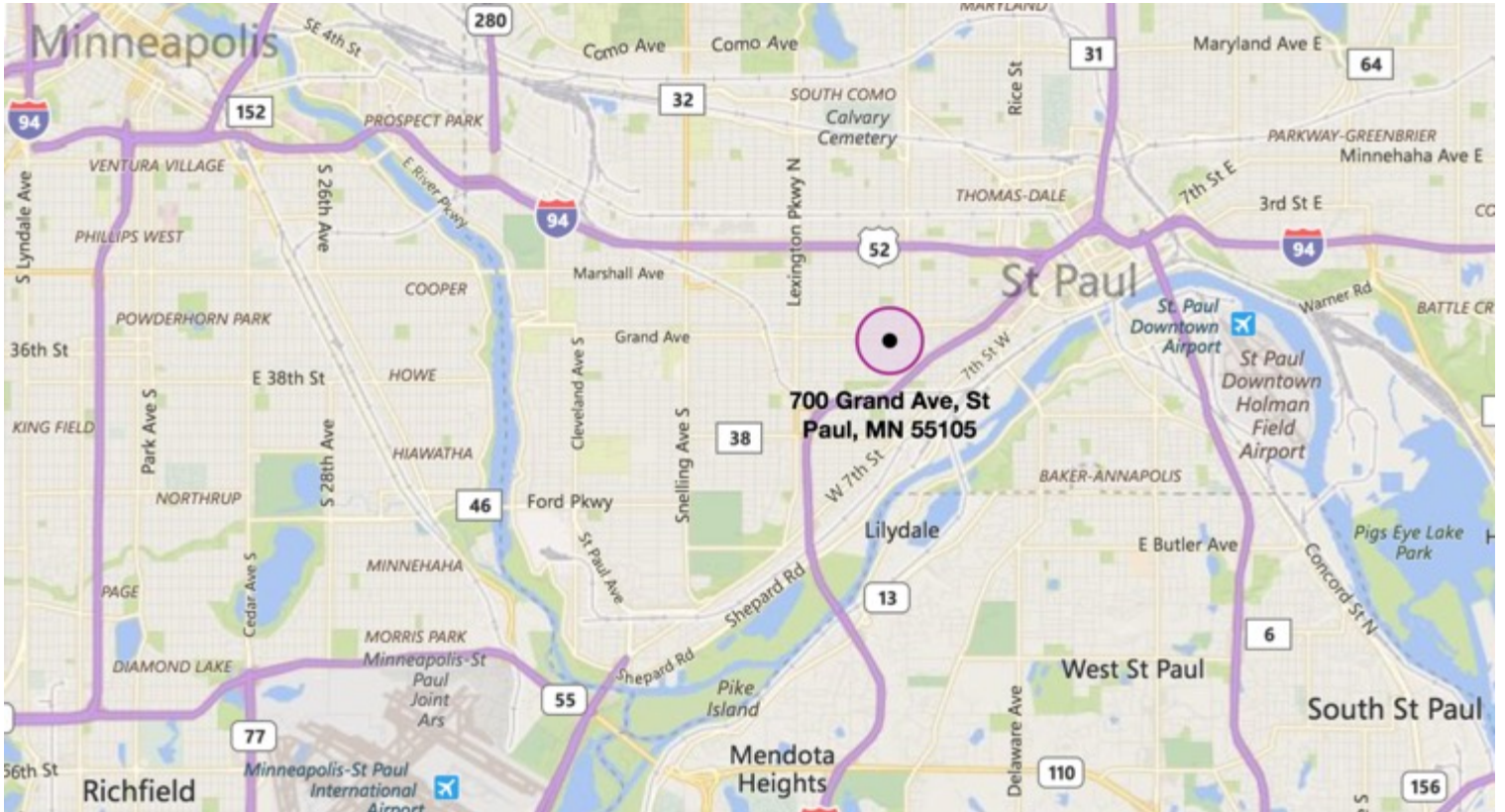

Aerial Map



This information is accurate as of the date of printing and is subject to change without notice. All information is deemed accurate, but cannot be guaranteed.

www.SpaceAvailableMN.com

Giving developers, business owners and commercial real estate investors the gifts of experience and personal attention.