



# CHATEAU *Plaza*



## Boutique Class AA Uptown Opportunity

- ❖ World-class finishes throughout
- ❖ Located in the heart of the Uptown amenity base
- ❖ Panoramic views of Uptown, Central Business District, Turtle Creek and Park Cities
- ❖ On-site conference center
- ❖ Tenant lounge
- ❖ Across from Whole Foods

## Asset Profile

Address	2515 McKinney Avenue Dallas, TX 75201
Submarket	Uptown
Building Size	172,139 square feet
Typical floor	17,800 square feet
Stories	18
Type	Class AA
Parking	3.0:1,000 covered parking

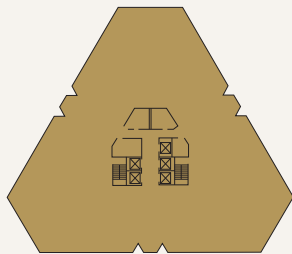

Levels 8 - 11

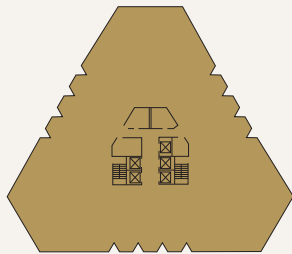

Levels 12 - 15

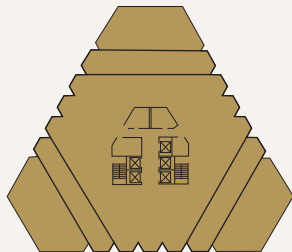

Levels 16 - 17

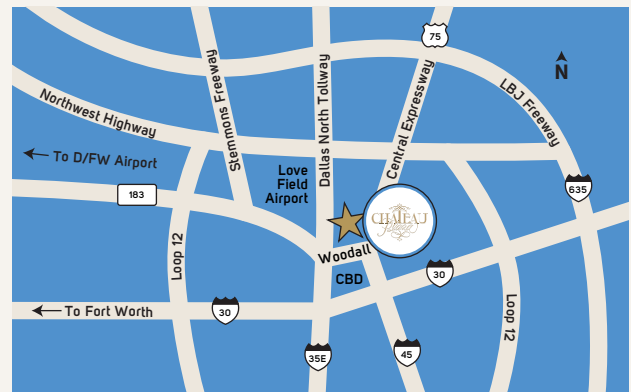

### Unmatched Location

- ❖ Located in the heart of Uptown
- ❖ Walking distance to best-in class restaurants, residences and retail
- ❖ Close proximity to AT&T Performing Arts Center
- ❖ Easy ingress/egress to major freeways: I-35, I-45, US-75 and Dallas North Tollway
- ❖ Minutes from Highland Park Village, Dallas Country Club and the Park Cities
- ❖ Five minutes from Dallas Love Field
- ❖ Twenty minutes from Dallas/Fort Worth International Airport

For leasing information, contact  
Sara Terry and Rhett Miller

TEL 214.267.0400 ❖ [www.chateau-plaza.com](http://www.chateau-plaza.com)  
[www.streamrealty.com](http://www.streamrealty.com)

Professionally leased and managed by



Owned by an institutional investor advised by

