



DEVELOPMENT OPPORTUNITY BUILDING

FOR SALE

888-892 VALLEY STREET

888-892 Valley Street, Vauxhall, NJ 07088

For More Information, Contact

BRAD JACOBS

Director

bjacobs@blauberg.com
732.997.9511

TAMARA BLAU

Director

tblau@blauberg.com
917.488.6846



THE BLAU & BERG COMPANY

830 Morris Turnpike, Suite 201, Short Hills, NJ 07078

www.blauberg.com

888-892 VALLEY STREET

888-892 Valley Street, Vauxhall, NJ 07088

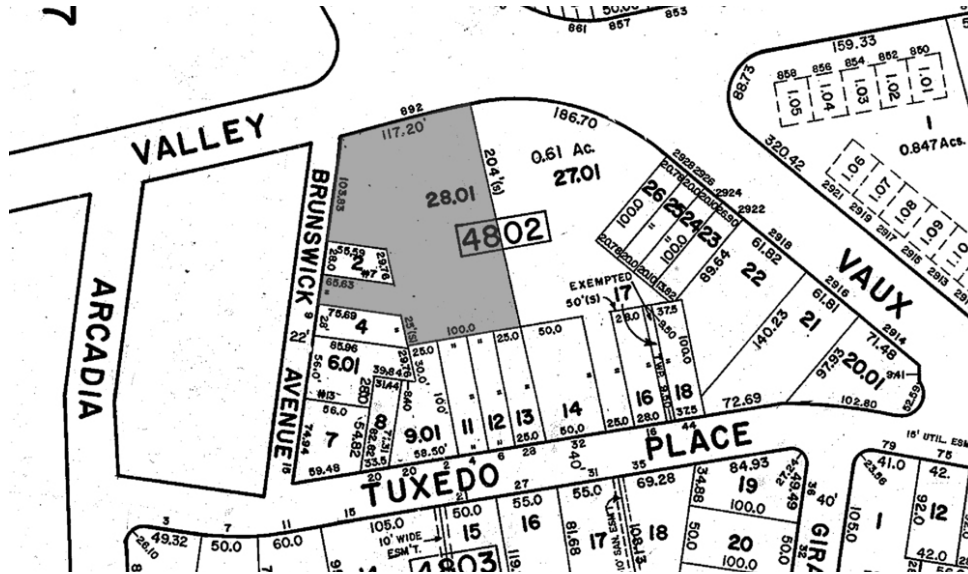

PROPERTY DESCRIPTION

Development Opportunity

LOCATION DESCRIPTION

Traffic Light Location at the center of Vauxhall in Union County
Close Proximity to I-78, Garden State Parkway and Routes 22 and 24

OFFERING SUMMARY

Sale Price:	\$1,400,000
Building Size:	4,000 SF

PROPERTY HIGHLIGHTS

- ±4,000 SF 2-Story Building
- 0.56-Acre Lot (Block 4802, Lot 28.01)
- 117 Feet x 202 Feet Lot Dimensions
- Currently Used as a Plumbing Supply and Yard
- Commercial Land Use
- Owner will Make a Deal "Subject To"
- Taxes at \$13,849.46 (2019)

For More Information, Contact

BRAD JACOBS

Director

bjacobs@blauberg.com
732.997.9511

TAMARA BLAU

Director

tblau@blauberg.com
917.488.6846

830 Morris Turnpike
Suite 201
Short Hills, NJ 07078

www.blauberg.com



The information contained herein has been obtained from sources considered to be reliable, but no guarantee of its accuracy is made by this company. In addition, no representation is made respecting zoning, condition of title, dimensions, or any matters of a legal or environmental nature. Such matters should be referred to legal counsel for determination. Terms and conditions are subject to change without prior notice. Subject to errors and omissions.

888-892 VALLEY STREET

888-892 Valley Street, Vauxhall, NJ 07088



For More Information, Contact

BRAD JACOBS

Director

bjacobs@blauberg.com
732.997.9511

TAMARA BLAU

Director

tblau@blauberg.com
917.488.6846

830 Morris Turnpike
Suite 201
Short Hills, NJ 07078

www.blauberg.com



The information contained herein has been obtained from sources considered to be reliable, but no guarantee of its accuracy is made by this company. In addition, no representation is made respecting zoning, condition of title, dimensions, or any matters of a legal or environmental nature. Such matters should be referred to legal counsel for determination. Terms and conditions are subject to change without prior notice. Subject to errors and omissions.

888-892 VALLEY STREET

888-892 Valley Street, Vauxhall, NJ 07088

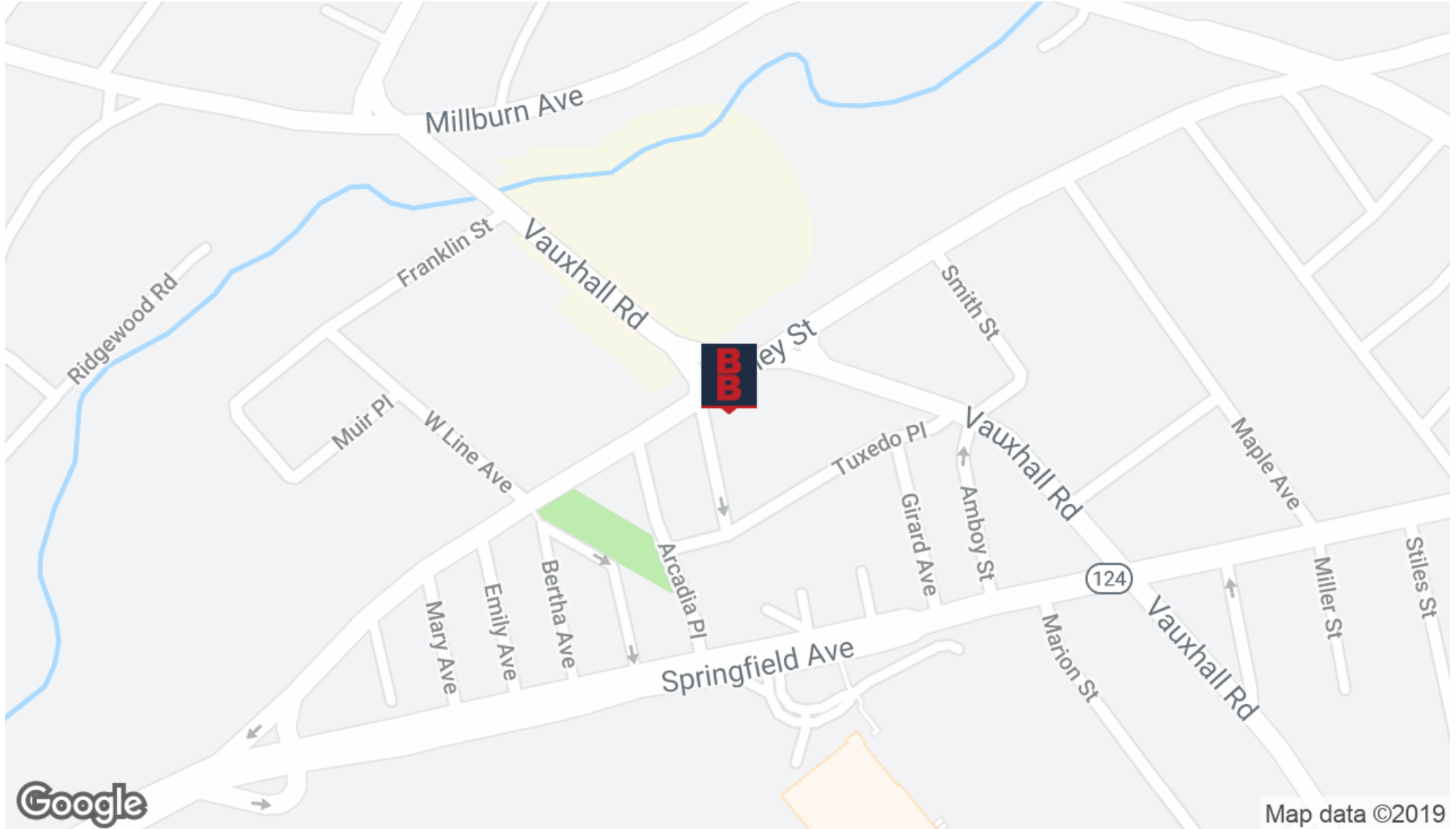

For More Information, Contact

BRAD JACOBS

Director

bjacobs@blauberg.com
732.997.9511

TAMARA BLAU

Director

tblau@blauberg.com
917.488.6846

830 Morris Turnpike
Suite 201
Short Hills, NJ 07078

www.blauberg.com



The information contained herein has been obtained from sources considered to be reliable, but no guarantee of its accuracy is made by this company. In addition, no representation is made respecting zoning, condition of title, dimensions, or any matters of a legal or environmental nature. Such matters should be referred to legal counsel for determination. Terms and conditions are subject to change without prior notice. Subject to errors and omissions.

888-892 VALLEY STREET

888-892 Valley Street, Vauxhall, NJ 07088

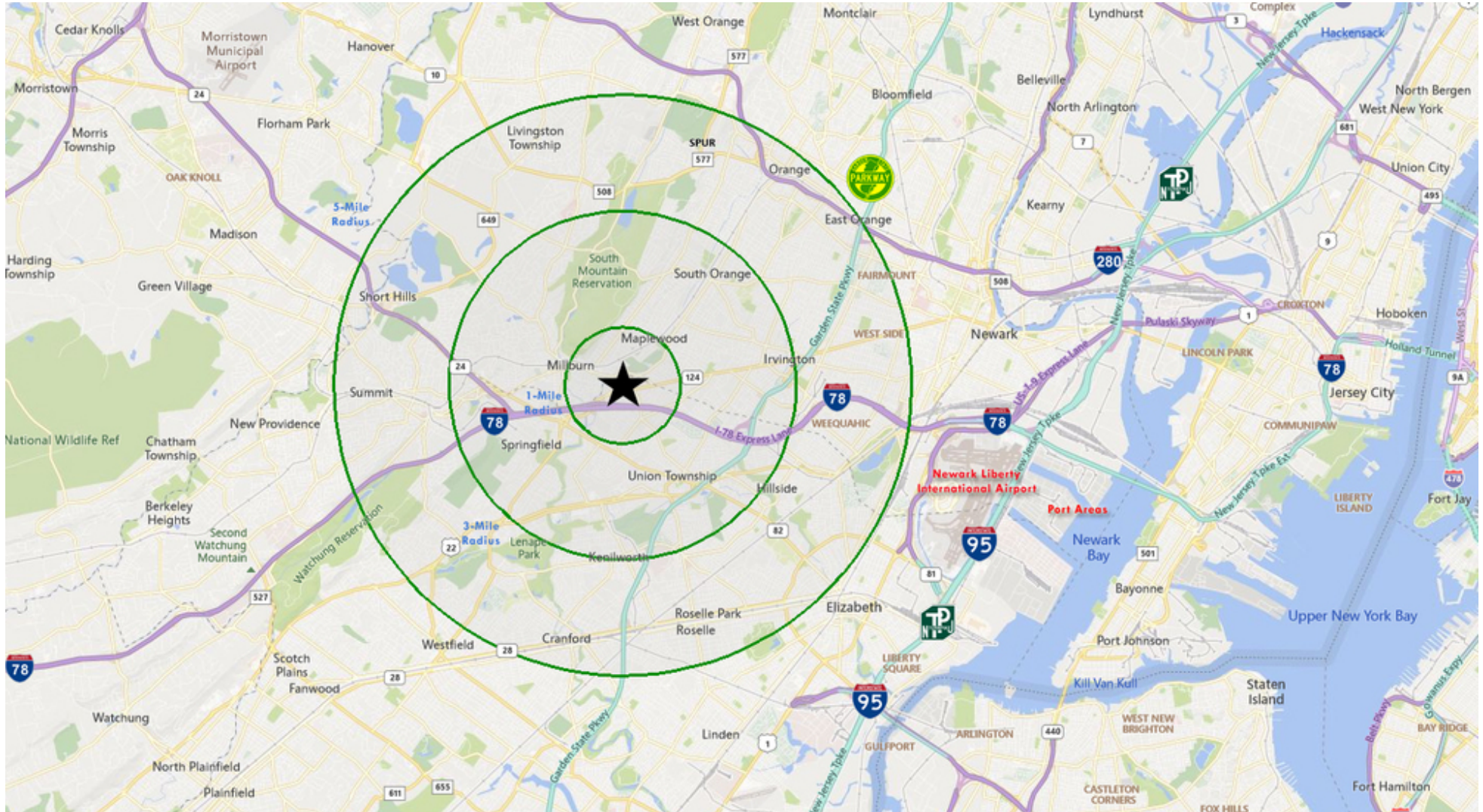

For More Information, Contact

BRAD JACOBS

Director

bjacobs@blauberg.com
732.997.9511

TAMARA BLAU

Director

tblau@blauberg.com
917.488.6846

830 Morris Turnpike
Suite 201
Short Hills, NJ 07078

www.blauberg.com



The information contained herein has been obtained from sources considered to be reliable, but no guarantee of its accuracy is made by this company. In addition, no representation is made respecting zoning, condition of title, dimensions, or any matters of a legal or environmental nature. Such matters should be referred to legal counsel for determination. Terms and conditions are subject to change without prior notice. Subject to errors and omissions.

888-892 VALLEY STREET

888-892 Valley Street, Vauxhall, NJ 07088

Radius	1 Mile	3 Mile	5 Mile
Population:			
2024 Projection	23,441	176,717	535,355
2019 Estimate	22,410	172,010	524,003
2010 Census	18,624	159,903	502,943
Growth 2019-2024	4.60%	2.74%	2.17%
Growth 2010-2019	20.33%	7.57%	4.19%
2019 Population Hispanic Origin	2,344	23,747	95,949
2019 Population by Race:			
White	13,043	89,474	240,928
Black	6,450	61,272	237,555
Am. Indian & Alaskan	36	660	2,652
Asian	2,410	16,691	32,150
Hawaiian & Pacific Island	7	128	521
Other	464	3,785	10,198
U.S. Armed Forces:	3	65	165
Households:			
2024 Projection	8,110	63,200	192,265
2019 Estimate	7,763	61,487	188,320
2010 Census	6,502	56,962	181,329
Growth 2019 - 2024	4.47%	2.79%	2.09%
Growth 2010 - 2019	19.39%	7.94%	3.86%
Owner Occupied	6,072	38,386	96,458
Renter Occupied	1,691	23,101	91,862
2019 Avg Household Income	\$138,809	\$116,611	\$97,926
2019 Med Household Income	\$109,720	\$85,606	\$64,915
2019 Households by Household Inc:			
<\$25,000	750	9,183	41,069
\$25,000 - \$50,000	1,031	9,799	36,288
\$50,000 - \$75,000	1,038	8,688	27,078
\$75,000 - \$100,000	778	7,248	19,464
\$100,000 - \$125,000	733	5,730	14,927
\$125,000 - \$150,000	682	4,745	11,208
\$150,000 - \$200,000	979	5,728	14,013
\$200,000+	1,773	10,369	24,275

For More Information, Contact

BRAD JACOBS

Director

bjacobs@blauberg.com

732.997.9511

TAMARA BLAU

Director

tblau@blauberg.com

917.488.6846

830 Morris Turnpike
Suite 201
Short Hills, NJ 07078

www.blauberg.com



The information contained herein has been obtained from sources considered to be reliable, but no guarantee of its accuracy is made by this company. In addition, no representation is made respecting zoning, condition of title, dimensions, or any matters of a legal or environmental nature. Such matters should be referred to legal counsel for determination. Terms and conditions are subject to change without prior notice. Subject to errors and omissions.

888-892 VALLEY STREET

888-892 Valley Street, Vauxhall, NJ 07088

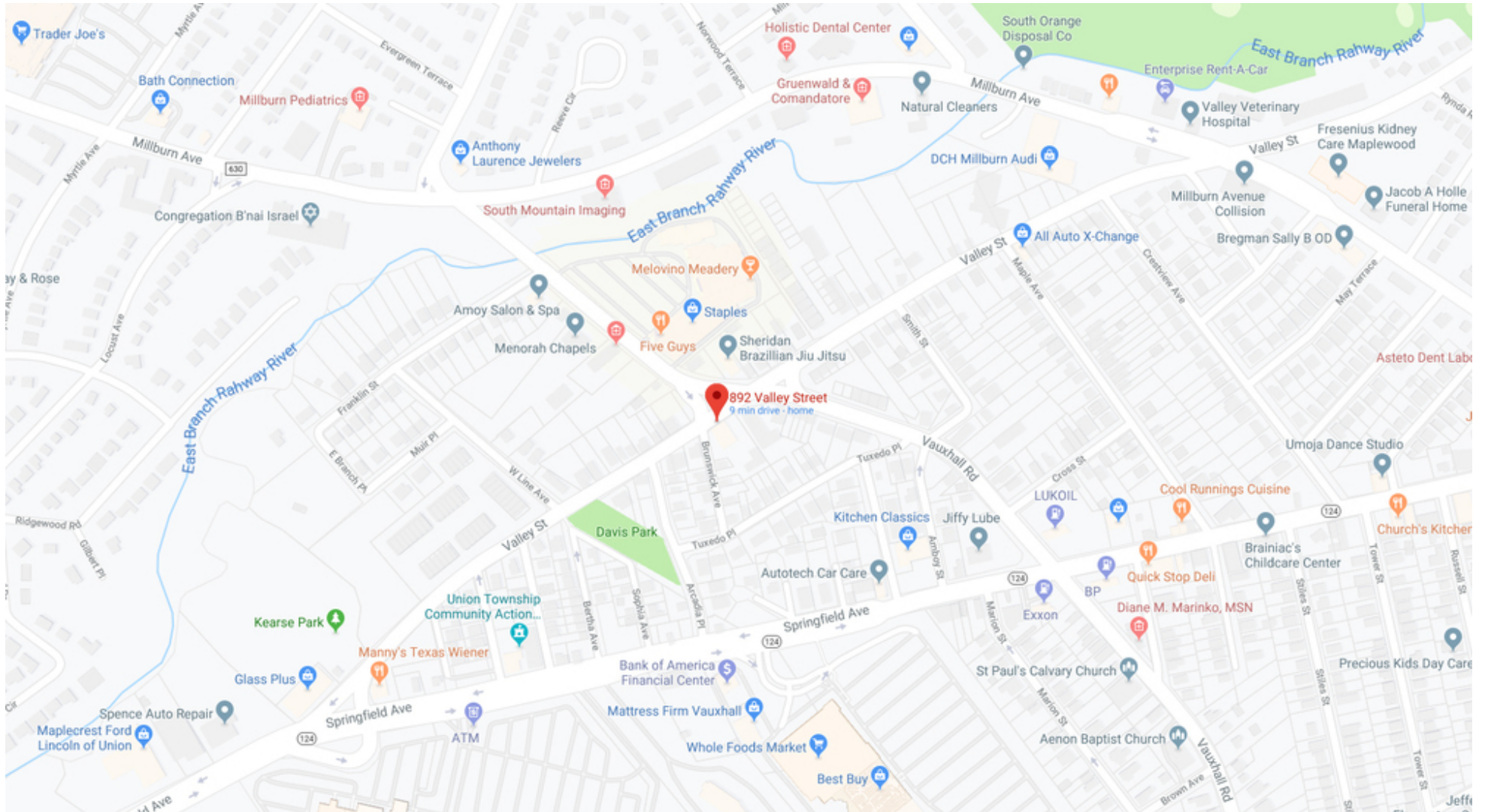

For More Information, Contact

BRAD JACOBS

Director

bjacobs@blauberg.com

732.997.9511

TAMARA BLAU

Director

tblau@blauberg.com

917.488.6846

830 Morris Turnpike
Suite 201
Short Hills, NJ 07078

www.blauberg.com



The information contained herein has been obtained from sources considered to be reliable, but no guarantee of its accuracy is made by this company. In addition, no representation is made respecting zoning, condition of title, dimensions, or any matters of a legal or environmental nature. Such matters should be referred to legal counsel for determination. Terms and conditions are subject to change without prior notice. Subject to errors and omissions.

888-892 VALLEY STREET

888-892 Valley Street, Vauxhall, NJ 07088



BRAD JACOBS

Director

732.997.9511

bjacobs@blauberg.com



TAMARA BLAU

Director

917.488.6846

tblau@blauberg.com



For More Information, Contact

BRAD JACOBS

Director

bjacobs@blauberg.com

732.997.9511

TAMARA BLAU

Director

tblau@blauberg.com

917.488.6846

830 Morris Turnpike
Suite 201
Short Hills, NJ 07078

www.blauberg.com



The information contained herein has been obtained from sources considered to be reliable, but no guarantee of its accuracy is made by this company. In addition, no representation is made respecting zoning, condition of title, dimensions, or any matters of a legal or environmental nature. Such matters should be referred to legal counsel for determination. Terms and conditions are subject to change without prior notice. Subject to errors and omissions.