

# OFFICE / SHOWROOM / WAREHOUSE SUITE FOR LEASE

## AT THE HEART OF ONE OF THE BUSIEST COMMERCIAL CORRIDORS



*Excellent Frontage On Gene Autry Trail*

### 1105 N. GENE AUTRY TRAIL, SUITE C, PALM SPRINGS, CA

- Newly Renovated Interior
- Adjacent to PS International Airport
- Signalized Corner of Tachevah
- Central to All Desert Cities
- Excellent for Variety of Uses
- Ready for Occupancy
- Zoned: M-1P
- Plenty of Parking

**\$.75/SF**  
**Mod. Gross**  
**Plus \$75/Mo. CAM**

Suite C - Approx. 1,926 SF



www.baxleyproperties.com  
Phone: 760-773-3310  
Fax: 760-773-3013  
73712 Alessandro Drive, Ste B-4, Palm Desert, CA 92260

**Irene Di Vito**  
**760-799-1821**

Irene@BaxleyProperties.com

CAL BRE License # 01369784



DISCLAIMER: The information above has been obtained from sources believed reliable. While we do not doubt its accuracy, we have not verified it and make no guarantee, warranty or representation about it.

# OFFICE / SHOWROOM / WAREHOUSE SUITE FOR LEASE

FLOORPLAN: 1105 N. GENE AUTRY TRL., SUITE C, PALM SPRINGS, CA

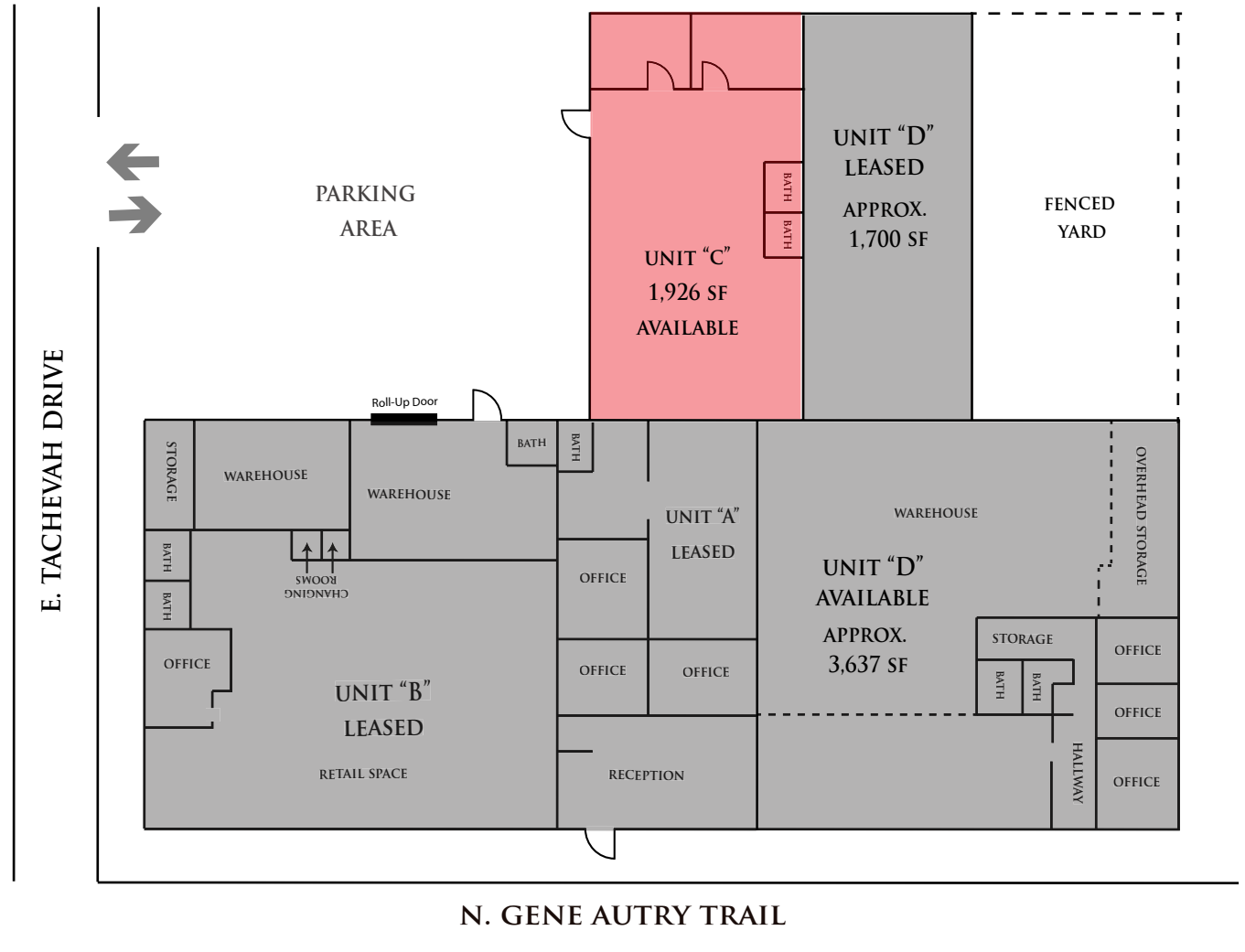

www.baxleyproperties.com  
 Phone: 760-773-3310  
 Fax: 760-773-3013  
 73712 Alessandro Drive, Ste B-4, Palm Desert, CA 92260

AVAILABLE